



24 Clarence Crescent, Clydebank, G81 2DP

Offers over £169,995



****Fantastic TWO bedroom link detached home**** This property (constructed in 2014) is set within a highly sought after Barratt Homes development. With HDVR Property Tour available, please contact Elevate Property Services for more information.



Property Information

Welcome to No. 24 Clarence Crescent, situated within a highly sought after Barratt Homes development in Clydebank. This contemporary TWO bedroom link detached home has been cleverly designed with the lounge and kitchen on the upper floor and bedrooms on the ground floor, creating a bright feel throughout.

Access through the secure double gates, leads to the driveway and easily maintained rear garden with mono-bloc paving, lawn and storage shed. Upon entering, you are welcomed into the reception hallway which leads you in the first instance to the accommodation on the ground floor. The master bedroom boasts a mirrored wardrobe and an ensuite shower room. The second bedroom is currently used as a home office space. Nestled between these two bedrooms is a convenient cloakroom, comprising of a wash hand basin and W.C.

On the upper level, the neutrally decorated lounge area provides access to the balcony and terrace, creating a bright and open feel. The large balcony area is perfect for entertaining or dining outdoors. The modern fitted kitchen benefits from an array of base and wall units and complementing worktops, creating a modern and efficient space. The kitchen further benefits from an integrated fridge freezer, washing machine, hob, oven and extractor fan. Completing this floor, is a spacious shower room with walk-in shower cubicle, wash hand basin and W.C.

Perfectly situated within walking distance of highly sought after primary and secondary schooling, this property will particularly appeal to families with children of various ages. Also, with excellent transport links to local shopping centres, or further afield to Glasgow City and Loch Lomond area, the location is ideal.

We would highly recommend an early viewing before it's too late! Viewing by appointment - please contact Elevate Property Services to arrange a suitable time or request further information and a copy of the Home Report.

Any areas, measurements or distances quoted are approximate and floor plans are only for illustration purposes and are not to scale. Thank you.

THESE PARTICULARS ARE ISSUED IN GOOD FAITH BUT DO NOT CONSTITUTE REPRESENTATIONS OF FACT OR FORM PART OF ANY OFFER OR CONTRACT.

Room Dimensions

- Lounge - 4.00m x 3.45m
- Kitchen - 3.44m x 2.67m
- Shower Room - 2.19m x 1.70m
- Terrace - 4.79m x 3.61m
- Bedroom One - 3.44m x 2.67m
- Ensuite - 1.83m x 1.71m
- Bedroom Two - 3.44m x 2.54m
- Cloakroom - 1.83m x 1.47m

These particulars, whilst believed to be accurate are set out as a general outline only for guidance and do not constitute any part of an offer or contract. Intending purchasers should not rely on them as statements of representation of fact, but must satisfy themselves by inspection or otherwise as to their accuracy. No person in this firm's employment has the authority to make or give any representation or warranty in respect of the property.

Room 4, 193 Dumbarton Road, Clydebank, West Dunbartonshire, G81 4XJ
Tel: 01389 504114 Email: info@elevatepropertyservices.com <https://www.elevatepropertyservices.com/>

Area Map

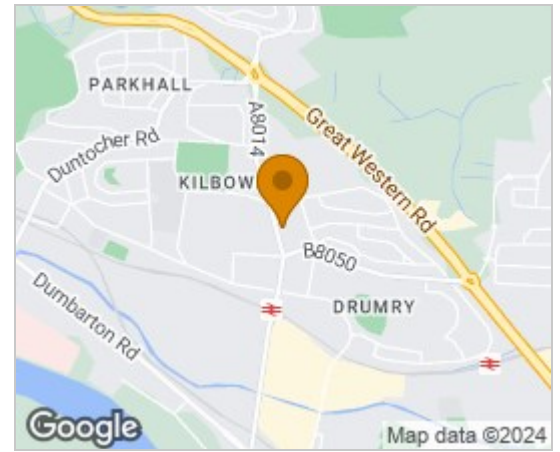

Floor Plans

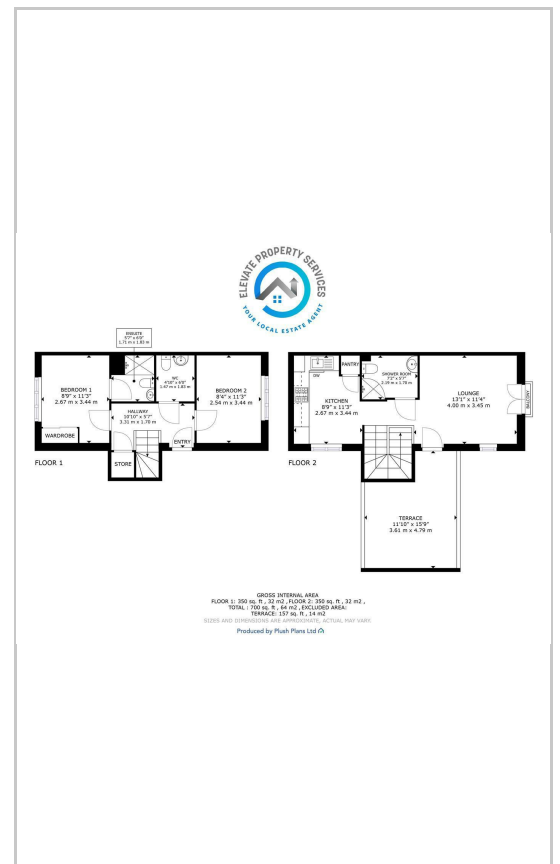

Energy Efficiency Graph

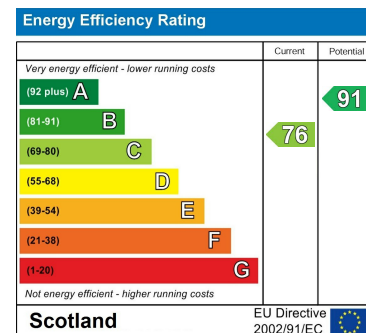

Room 4, 193 Dumbarton Road, Clydebank, West Dunbartonshire, G81 4XJ
Tel: 01389 504114 Email: info@elevatepropertyservices.com <https://www.elevatepropertyservices.com/>