



CHARLES BARTLETT  
RESIDENTIAL



## Flat 18 Stoneworks Place

Matlock Spa, Matlock, DE4 3ST

£1,450 Per month

Introducing a stunning two-bedroom apartment in Stoneworks Place, Matlock Spa.

This modern property features an inviting open-plan living room and kitchen with integrated appliances, ideal for contemporary living. The master bedroom and second double bedroom provide comfortable spaces, complemented by a well-appointed bathroom with a shower.

Enjoy the convenience of allocated parking, enhancing the appeal of this brand-new property, seamlessly blending style and functionality.

Stoneworks Place also benefits from secure entry system and lockable bike storage.

We also have a further selection of additional brand new two-bedroom luxury apartments in Stoneworks Place, which you are welcome to view when you visit.

Located in the heart of the Derbyshire Dales, Matlock Spa is just ten minutes' walk away from Matlock Town and a stone's throw from the Peak District National Park. Surrounded by beautiful countryside, historic castles and delicious places to eat, Matlock Spa is extremely well connected to England's extensive road and rail network, offering a wide range of lifestyle options and stunning natural surroundings.

- Matlock Spa, Matlock
- Two bedroom apartment
- Available January 2026
- Close to town
- Stunning views
- Open plan living room/kitchen
- Master bedroom
- Second double bedroom
- Main bathroom
- Furnishings may be flexible upon application

### Viewing

Please contact our Charles Bartlett Residential Office on 07939 496551

if you wish to arrange a viewing appointment for this property or require further information

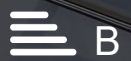



Floor Plan

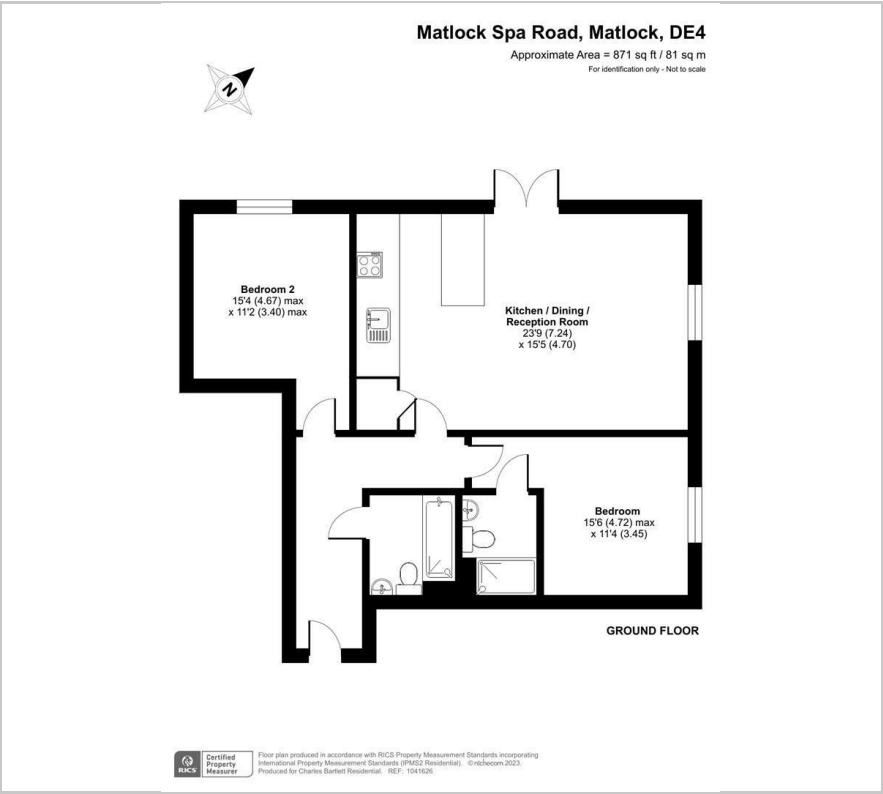

Area Map



Energy Efficiency Graph

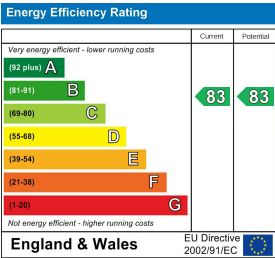

These particulars, whilst believed to be accurate are set out as a general outline only for guidance and do not constitute any part of an offer or contract. Intending purchasers should not rely on them as statements of representation of fact, but must satisfy themselves by inspection or otherwise as to their accuracy. No person in this firms employment has the authority to make or give any representation or warranty in respect of the property.