



CHARLES BARTLETT
RESIDENTIAL



Flat 2 Stoneworks Place

Matlock Spa, Matlock, DE4 3ST

£1,400 Per month

A range of BRAND NEW luxury two bedroom apartments available NOW!

These beautifully spacious apartments are finished to a very high standard and comprise an open plan reception room with integrated kitchen, master bedroom with ensuite shower, second double bedroom and main bathroom.

These apartments offer well sized balconies or Juliet balconies giving residents the opportunity to enjoy the stunning views of Matlock and the nearby countryside.

Stoneworks Place also benefits from secure entry system, allocated parking, lockable bike storage and dog washing facilities (extra charges apply).

Located in the heart of the Derbyshire Dales, Matlock Spa is just ten minutes' walk away from Matlock Town and a stone's throw from the Peak District National Park.

Surrounded by beautiful countryside, historic castles and delicious places to eat, Matlock Spa is extremely well connected to England's extensive road and rail network, offering a wide range of lifestyle options and stunning natural surroundings.

A short drive away from the M1, motorists and rail users can get to London in near 2 hours, Manchester in an hour and a

- Available immediately
- Last few remaining!
- Open plan living room/kitchen
- Master bedroom with ensuite
- Second double bedroom
- Main bathroom
- Stunning views
- Convenient access to local shops and restaurants
- Allocated parking
- Bike storage

Viewing

Please contact our Charles Bartlett Residential Office on 07939 496551

if you wish to arrange a viewing appointment for this property or require further information

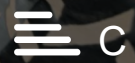

Floor Plan

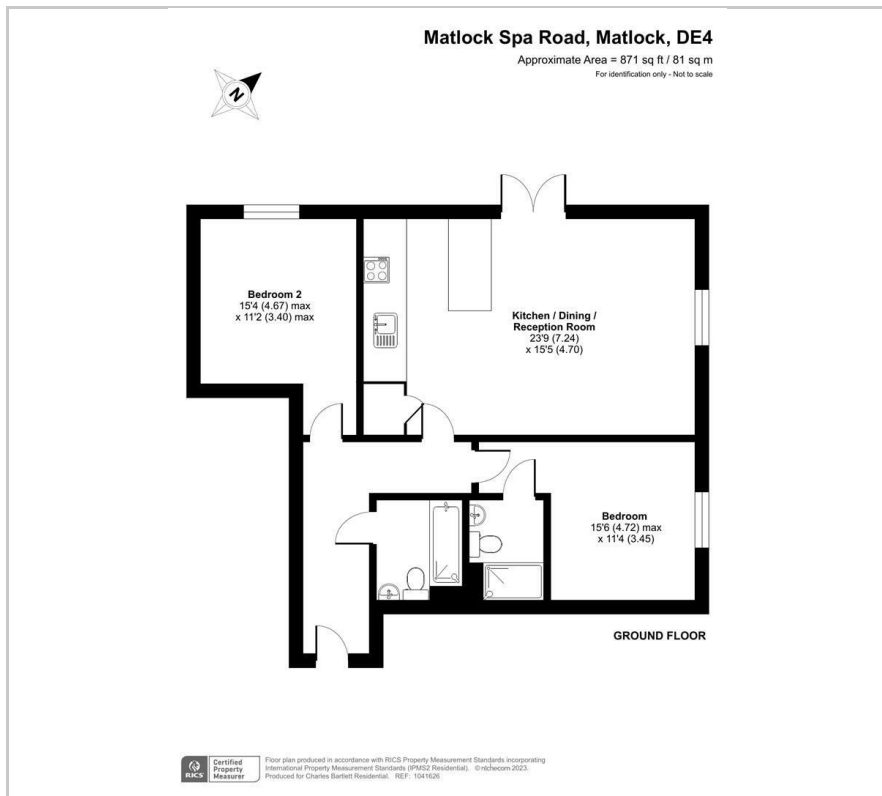

Area Map



Energy Efficiency Graph

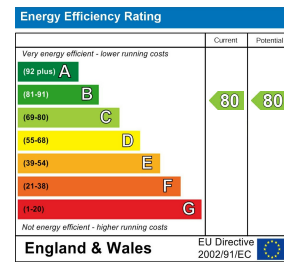

These particulars, whilst believed to be accurate are set out as a general outline only for guidance and do not constitute any part of an offer or contract. Intending purchasers should not rely on them as statements of representation of fact, but must satisfy themselves by inspection or otherwise as to their accuracy. No person in this firm's employment has the authority to make or give any representation or warranty in respect of the property.