

## Candia Towers, Liverpool, L5 5EN



**Asking Price £65,000**

**\*\* INVESTMENT OPPORTUNITY SOLD WITH TENANTS IN SITU\*\***

Vista Abode are pleased to market this 4th Floor three bedroom apartment located in a popular residential area of Liverpool L5.

Ideally located with excellent transport links to the City Centre and local amenities are all close by.

The apartment comprises of entrance hallway, spacious lounge with balcony, modern kitchen, three bedrooms, bathroom and separate W.C.

The apartment also benefits from intercom entrance system, off road parking, and on site security.

To arrange viewing please call Vista Abode

0151 336 8171

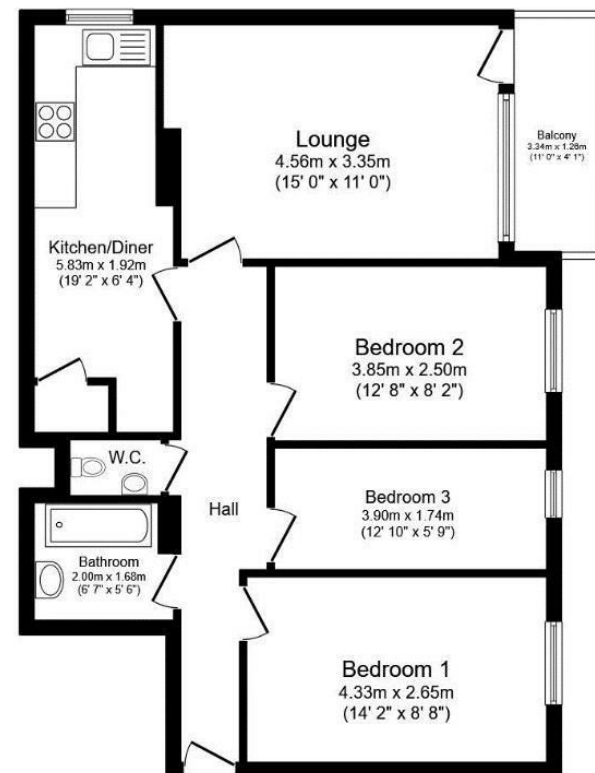

Total floor area 70.2 sq.m. (756 sq.ft.) approx

This floor plan is for illustrative purposes only. It is not drawn to scale. Any measurements, floor areas (including any total floor area), openings and orientation are approximate. No details are guaranteed, they cannot be relied upon for any purpose and they do not form part of any agreement. No liability is taken for any error, omission or misstatement. A party must rely upon its own inspection(s). Plan produced for Reed Rains. Powered by [www.focalagent.com](http://www.focalagent.com)

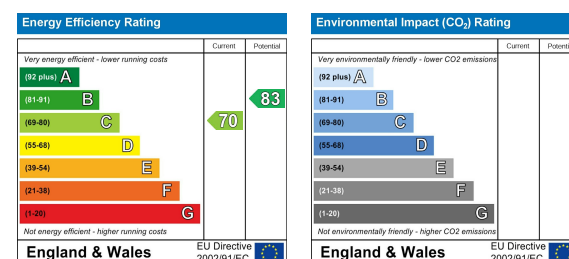



## Candia Towers, Liverpool, L5 5EN

### Lounge 14'7" x 10'11" (4.47m x 3.35m)

Double glazed window and door leading onto balcony, wall mounted electric heater.

### Bedroom 1 14'0" x 8'9" (4.28m x 2.67m)

Double glazed window, wall mounted electric heater.

### Bedroom 2 12'7" x 8'2" (3.84m x 2.50m)

Double glazed window, wall mounted electric heater.

### Bedroom 3 12'7" x 5'7" (3.84m x 1.72m)

Double glazed window, wall mounted electric wall heater.

### Bathroom 7'8" x 5'5" (2.35m x 1.66m)

Bath with shower and shower screen, sink.

### WC

WC and sink.

### Kitchen 19'1" 6'2" (5.84m 1.89m)

Double glazed window, base and wall units, electric oven and hob, cupboard storing water tank.

