



Layco

Your Property, Your Service



Greensand View Woburn Sands Milton Keynes

- GROUND FLOOR
- TWO BEDROOMS, TWO BATHROOMS
- STUNNING CONDITION THROUGHOUT
- LARGER THAN AVERAGE PRIVATE PATIO
- VIEWS OVER LAKE
- OPEN PLAN KITCHEN/LIVING ROOM

Price £265,000 Subject To Contract

24 Parton Road, Aylesbury, Buckinghamshire, HP20 1NG
Tel: 01296 791960 / 01525 307600 | Email: Sales@laycoproperties.co.uk
<https://www.laycoproperties.co.uk>



A beautifully presented, two double bedroom, ground floor apartment with views over a lake, situated in the highly desirable village of Woburn Sands. The home boasts a generous open plan kitchen/living room, en-suite to the main bedroom, allocated parking and private patio garden area.

Accommodation:

Entrance hall: Wood flooring throughout the property, airing cupboard and doors to all rooms.

Bathroom: Fitted with a white three piece suite comprising; WC, hand basin and bath with shower attachment. Partly tiled walls.

Bedroom one: A spacious double bedroom with built in bluetooth speaker in the ceiling, two fitted wardrobes and window to the rear aspect.

Ensuite: Fitted with a suite comprising; WC, hand basin and shower cubicle. Partly tiled walls and built in bluetooth speaker in the ceiling.

Bedroom two: A double bedroom with window to the rear aspect.

Kitchen/living room: A stunning, spacious, open plan kitchen/living room with ample space for furniture plus built in bluetooth speakers in the ceiling. The kitchen area is fitted with a range of wall and floor mounted units with worktops above and a sink and drainer unit. There is an integrated fridge/freezer, dishwasher, washing machine and oven with gas hob above. Wall mounted gas boiler and window to the front aspect. The living area is spacious and light with patio doors leading out to a private patio area.

Private patio: A larger than average patio with fantastic views over looking a lake. The garden is enclosed by iron fencing and is an ideal space for entertaining and relaxing in an evening.

Parking: There is one allocated parking space and further visiting spaces available nearby.

General: Leasehold, gas to radiator central heating, Central Bedfordshire council, council tax band: B, EPC: C.

Lease info: length of lease remaining 130 years, £986.17 service charge per annum, £230.70 ground rent per annum.

Location: Woburn Sands boasts an array of local amenities and is situated in close proximity to Frosts garden centre. It is also in close proximity of Milton Keynes and benefits from excellent transport links via M1 motorway, train station and bus routes.

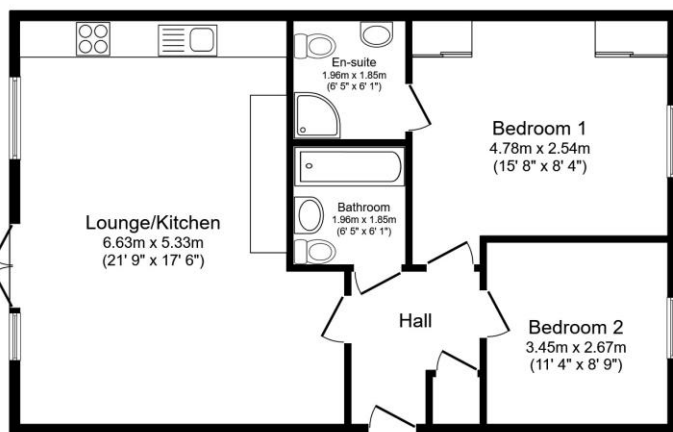

Floor Plan

Floor area 70.6 m² (760 sq.ft.)

TOTAL: 70.6 m² (760 sq.ft.)

This floor plan is for illustrative purposes only. It is not drawn to scale. Any measurements, floor areas (including any total floor area), openings and orientations are approximate. No details are guaranteed, they cannot be relied upon for any purpose and do not form any part of any agreement. No liability is taken for any error, omission or misstatement. A party must rely upon its own inspection(s). Powered by www.Propertybox.io

24 Parton Road, Aylesbury, Buckinghamshire, HP20 1NG
Tel: 01296 791960 / 01525 307600 | Email: Sales@laycoproperties.co.uk
<https://www.laycoproperties.co.uk>

