

1 Proposed Ground Floor Plan
1:200

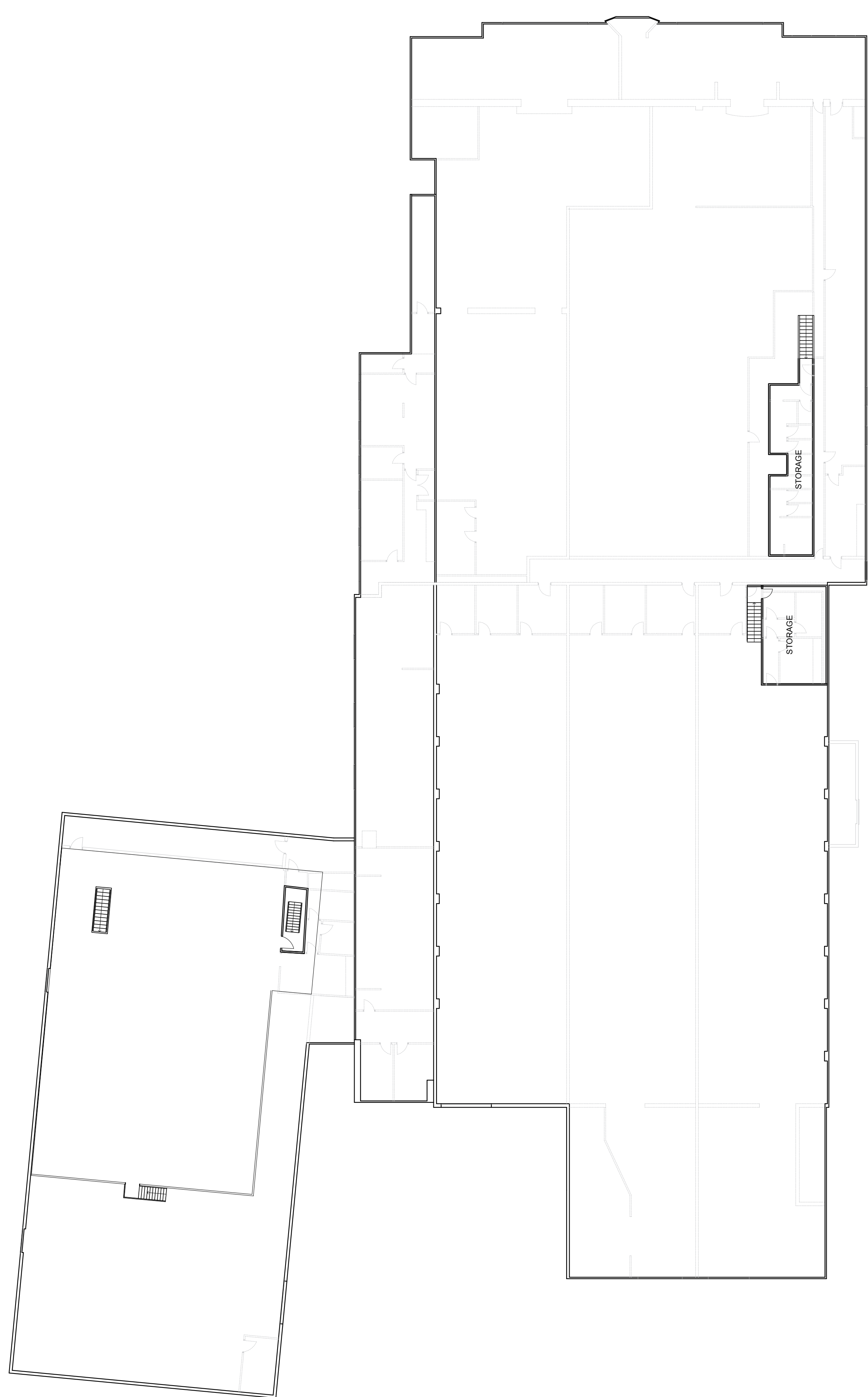

2 Proposed First Floor Plan
1:200

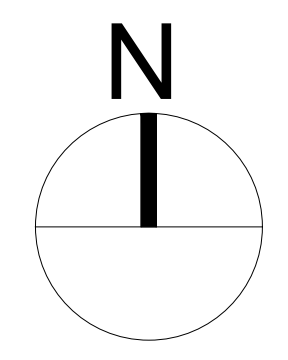
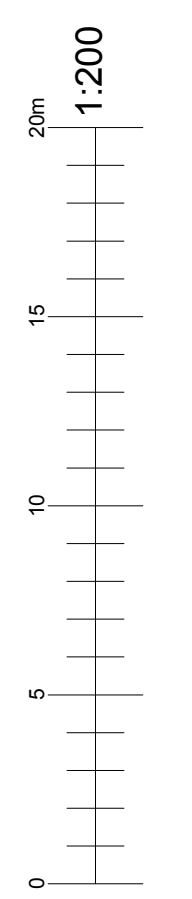

dpa ARCHITECTS
 INTERIOR DESIGNERS
 PARTY WALL SURVEYORS
 PLANNING CONSULTANTS

Hertfordshire Office
 25 Tudor Hall
 Brewery Road
 Hoddesdon, Herts
 EN11 8FP

London Office
 9 Devonshire square
 London
 EC2M 4YF

RIBA 01992 469001
 info@dpa-architects.co.uk
 www.dpa-architects.co.uk

Site address	26-28 Terminus Road Chichester PO19 8ZZ
Project Description	conversion of 1 warehouse to 7 Units
Drawing Title	Proposed Plans
Drawn	KM
Checked by	DP
Issued for	Planning Approval
Scale	1:200@A1
Drawing No.	1438_304_Rev A
Date	26/09/2019
Revisions	revision A