



65 Priory Mill Lane

Witney, OX28 1YG

60% Shared Ownership £ 165,000

A beautifully presented 2 bedroom second floor apartment set in a quiet location comprising of hall leading to bright & spacious open plan kitchen and living space, with two bedrooms and a shower room garage and allocated parking.

Priory Mill Lane is situated in Witney the largest market town in the Cotswolds. Witney has a charming bustling atmosphere with its unique blend of shops, antique centres and cafes including 5 mins walk to Staple Hall bus stop - a pick up and drop off point for destinations including Oxford City Centre (S1) and London (Oxford Tube).

- Fixed share equity lease 60%
- No rent on outstanding 40% share
- Service charge £293.18 every six months
- 2 double bedrooms
- Walk-in shower room
- Bright open plan living room & kitchen
- Garage with parking
- Second floor apartment



Floor Plan

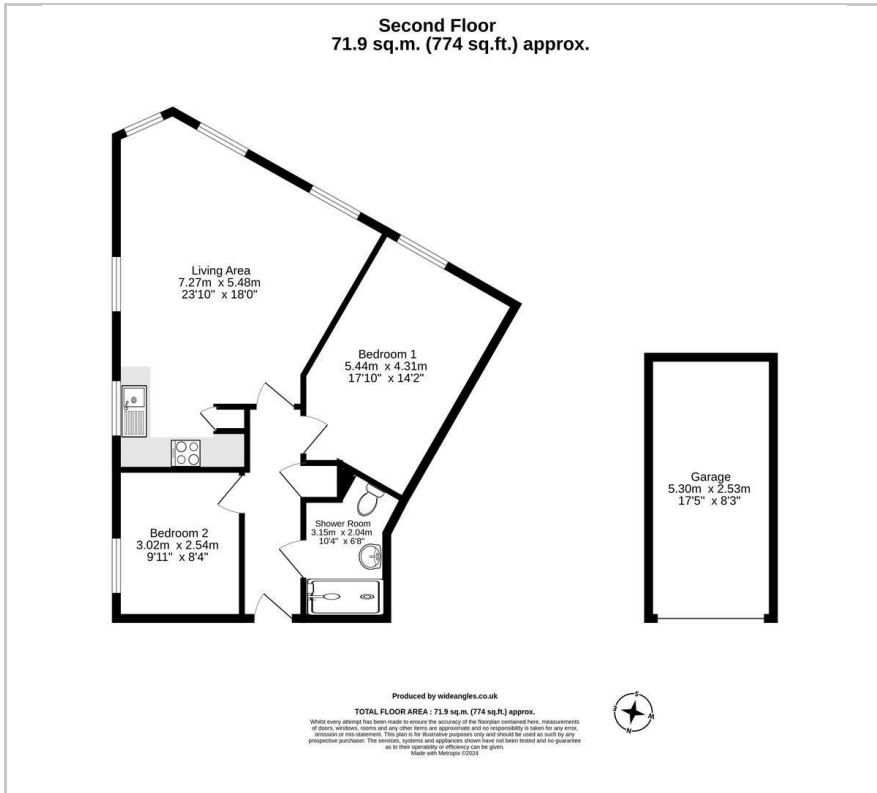

Area Map



Energy Efficiency Graph

Energy Efficiency Rating		Current	Potential
Very energy efficient - lower running costs			
(92 plus) A			
(81-91) B			
(69-80) C			
(55-68) D			
(39-54) E			
(21-38) F			
(1-20) G			
Not energy efficient - higher running costs			
England & Wales		EU Directive 2002/91/EC	



These particulars, whilst believed to be accurate are set out as a general outline only for guidance and do not constitute any part of an offer or contract. Intending purchasers should not rely on them as statements of representation of fact, but must satisfy themselves by inspection or otherwise as to their accuracy. No person in this firm's employment has the authority to make or give any representation or warranty in respect of the property.