



## 61 Priory Mill Lane

Witney, OX28 1YG

60% Shared Ownership £ 172,500

Fantastic opportunity to purchase this delightful two bedroom apartment comprising of hall leading to spacious open plan kitchen and living space, with two bedrooms and family bathroom with the added benefit of two garages and two car parking spaces.

Priory Mill Lane is situated in Witney the largest market town in the Cotswolds. Witney has a charming bustling atmosphere with its unique blend of shops, antique centres and cafes.

- No rent to be paid on the 40%
- Leaseholder charge £243.18 every 6 months approximately
- Ground Rent £50 every six months
- Ground floor apartment
- 2 bedrooms
- Spacious open plan kitchen and living space
- 2 garage spaces
- 2 car parking spaces
- Family bathroom



## Floor Plan

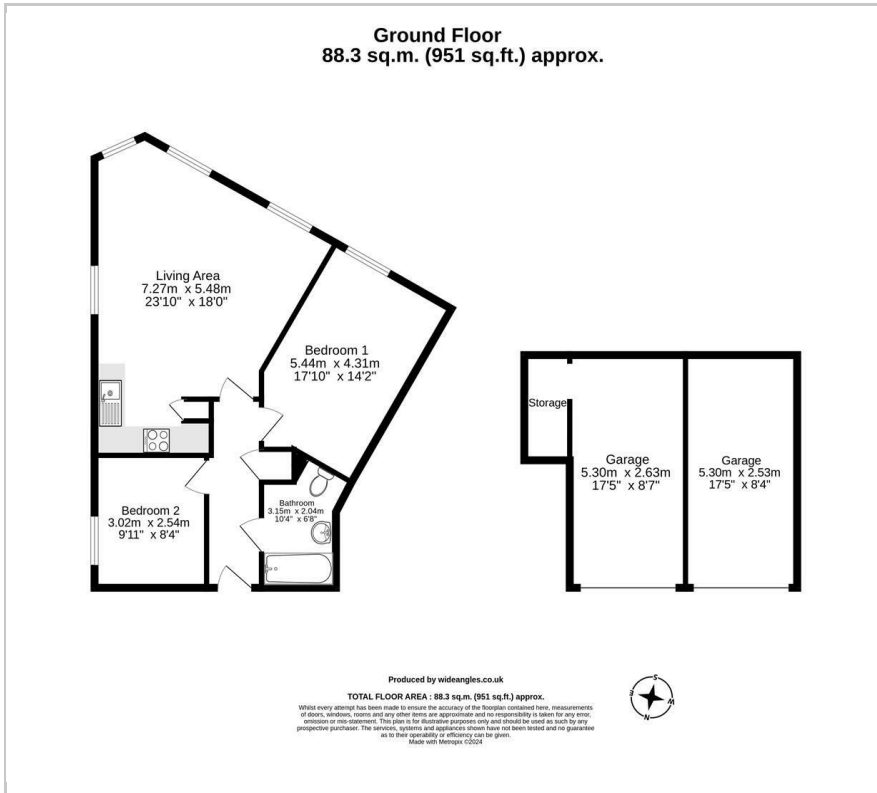

## Area Map



## Energy Efficiency Graph

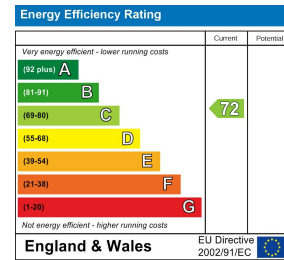

These particulars, whilst believed to be accurate are set out as a general outline only for guidance and do not constitute any part of an offer or contract. Intending purchasers should not rely on them as statements of representation of fact, but must satisfy themselves by inspection or otherwise as to their accuracy. No person in this firm's employment has the authority to make or give any representation or warranty in respect of the property.

Royal Scot House 99 Station Road, Didcot, Oxfordshire, OX11 7NN  
Tel: 01235 515900 Email: Sales@soha.co.uk