

KILN & LODGE

ESTATE AGENTS : REDEFINED



2 Jasmine Way Colchester Road
St. Osyth, Clacton-On-Sea, CO16 8HW

Welcome to the Willerby Cranbrook Lodge, a haven designed exclusively for those seeking a tranquil retreat at Oaklands Holiday Park in St Osyth, Clacton on Sea, Essex. This spacious lodge offers 800 ft.² of usable space, providing ample room for relaxation and enjoyment.

Step inside and be greeted by the open-plan living kitchen diner, a perfect space for entertaining friends and family. The kitchen features an island breakfast bar, allowing you to prepare delicious meals while engaging in conversation. The living area is spacious and inviting, ideal for cosy evenings spent with loved ones.

Indulge in the luxury of the large full-size family bathroom, complete with modern fixtures and fittings. The two double bedrooms offer a peaceful sanctuary, with the master bedroom boasting a walk-in wardrobe and an ensuite shower room for added convenience and privacy.

Asking price £95,000

2 Jasmine Way Colchester Road

St. Osyth, Clacton-On-Sea, CO16 8HW



- Owners only park
- Stamp Duty Exempt
- Open Plan Lounge/Kitchen/Diner
- Open 11.5 months of the year
- Two Bedrooms
- Modern throughout
- No solicitors fees







Floor Plan

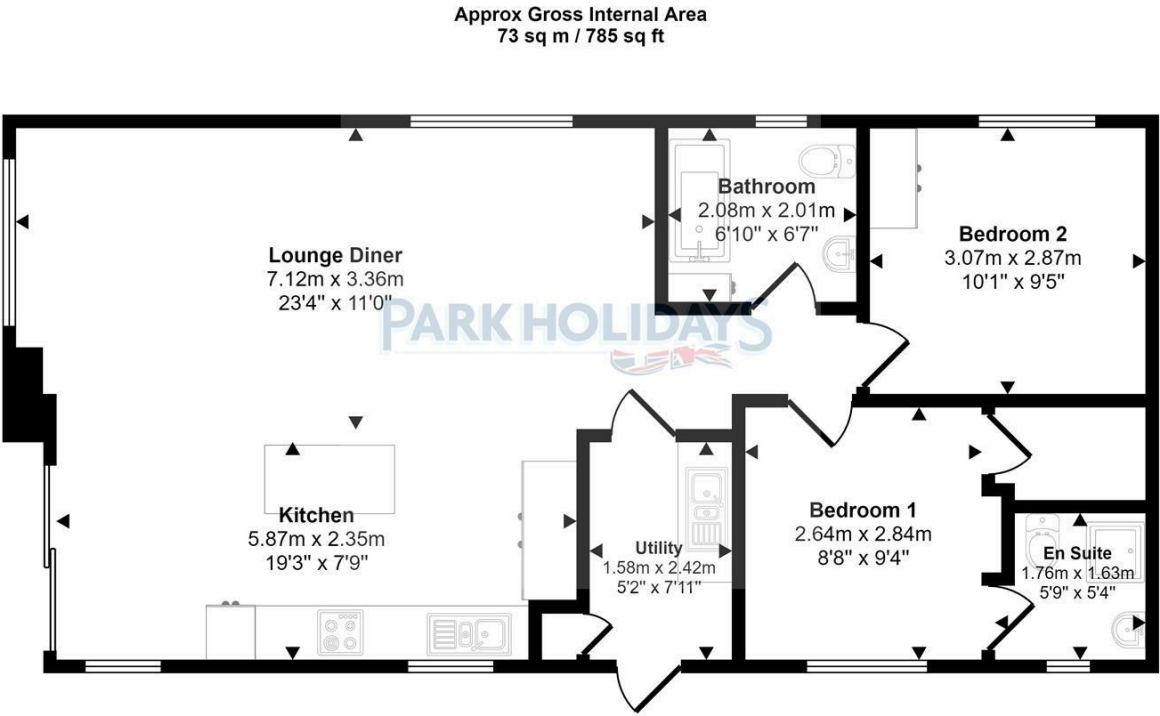

Floorplan

This floorplan is only for illustrative purposes and is not to scale. Measurements of rooms, doors, windows, and any items are approximate and no responsibility is taken for any error, omission or mis-statement. Icons of items such as bathroom suites are representations only and may not look like the real items. Made with Made Snappy 360.

These particulars, whilst believed to be accurate are set out as a general outline only for guidance and do not constitute any part of an offer or contract. Intending purchasers should not rely on them as statements of representation of fact, but must satisfy themselves by inspection or otherwise as to their accuracy. No person in this firms employment has the authority to make or give any representation or warranty in respect of the property.

