



## Farthings Chelmsford Road

White Roding, Dunmow, CM6 1RF

Asking price £325,000





# Farthings Chelmsford Road

White Roding, Dunmow, CM6 1RF

Asking price £325,000



## Entrance

## Kitchen

Window to front. Range of fitted units to eye and base level, space and plumbing for oven, fridge, freezer and washing machine. Work surfaces incorporate sink units and mixer tap. Open to

## Dining Area

French doors to rear, radiator.

## Inner Hallway

Storage cupboards, tiled floor.

## Living Room

Doors to rear overlooking countryside, radiator,

## Bedroom One

Window to Rear, radiator.

## Bedroom Two

Window to front, radiator.

## Bedroom Three

Window to front, radiator.

## Bathroom

Window to side, panelled bath, wash hand basin, low level wc.

## Exterior

## Front/Side Garden

Hedges, trees and bushes to front and side

## Off Road Parking

Hedges, trees and bushes to front

## Detached Garage

Up and over door.

## Rear Garden

Small garden area, with stunning views across countryside.

## Agents Note

We're advised that Japanese Knotweed is located within close proximity to the property, the land of which is owned by Highways Agency.

We're further advised that the kitchen extension on the property is Timber Framed.







Road Map



Hybrid Map



Terrain Map



Floor Plan

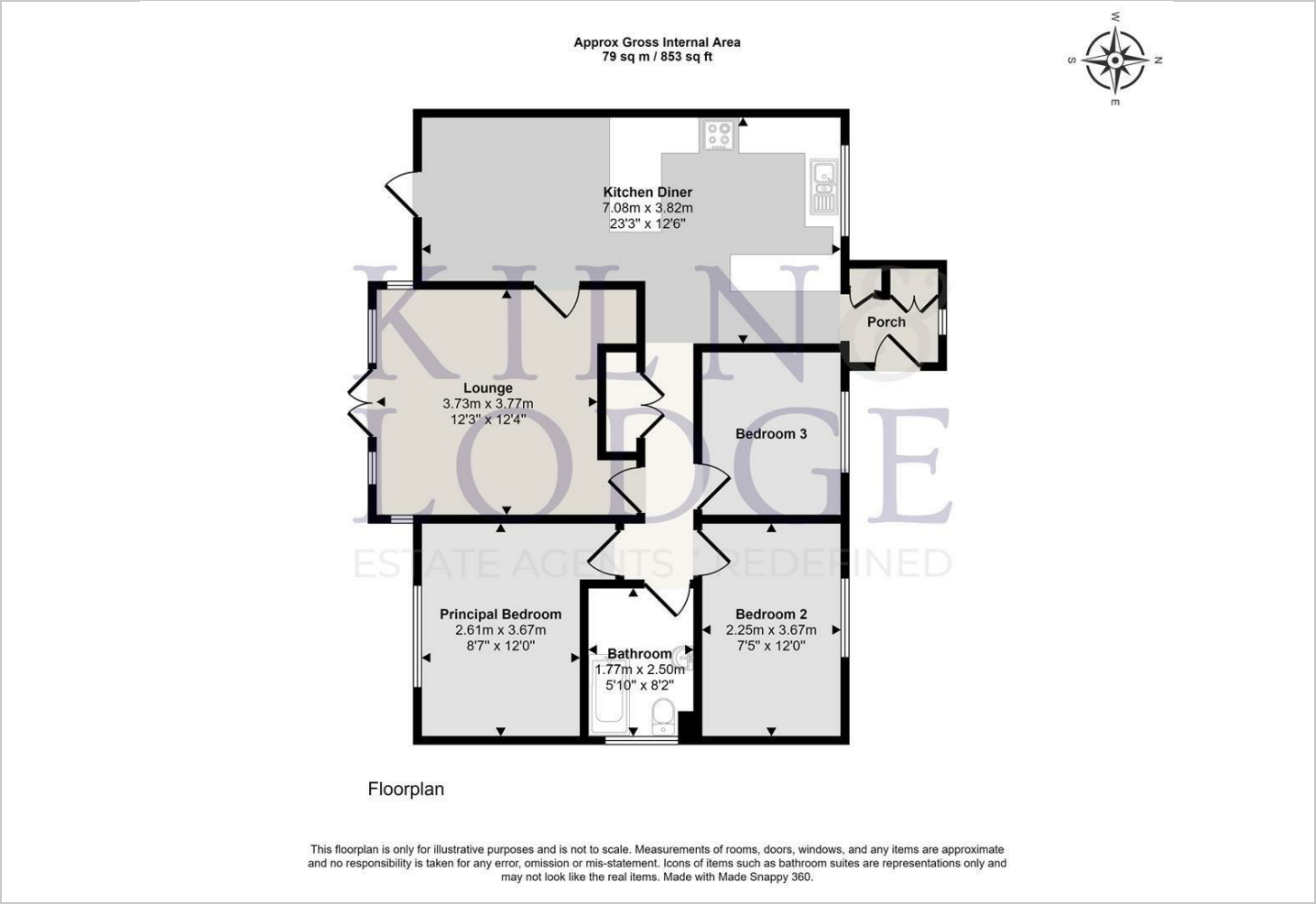

Viewing

Please contact our Chelmsford Office on 01245 330764 if you wish to arrange a viewing appointment for this property or require further information.

Energy Efficiency Graph

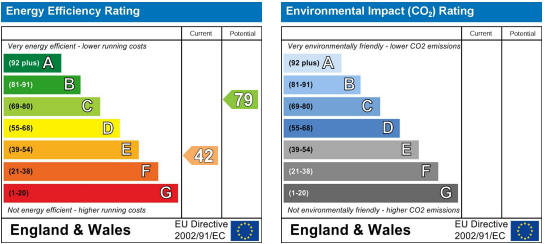

These particulars, whilst believed to be accurate are set out as a general outline only for guidance and do not constitute any part of an offer or contract. Intending purchasers should not rely on them as statements of representation of fact, but must satisfy themselves by inspection or otherwise as to their accuracy. No person in this firms employment has the authority to make or give any representation or warranty in respect of the property.