

# KILN & LODGE

ESTATE AGENTS : REDEFINED



## 26 Raphaels, Basildon, SS15 5EA

Welcome to this charming mid-terrace house located in the heart of Basildon. This delightful family home boasts a warm and welcoming atmosphere, perfect for creating lasting memories.

As you step inside, you are greeted by a cosy reception room, ideal for relaxing with loved ones. The property features three well-proportioned bedrooms, offering ample space for the whole family to unwind and recharge.

Situated conveniently close to schools, this home is perfect for families with children, ensuring a stress-free school run each day. Additionally, its proximity to the town centre provides easy access to a variety of amenities, making daily errands a breeze.

Maintained in good condition, this property is ready for you to move in and add your personal touch. Whether you are looking for a family home or an investment opportunity, this charming house offers endless possibilities.

- No Onward Chain
- Three Bedrooms
- Well Presented
- Good Size Rear Garden
- Close to Schools
- Close to Town Centre
- Garage

£329,995

GROUND FLOOR

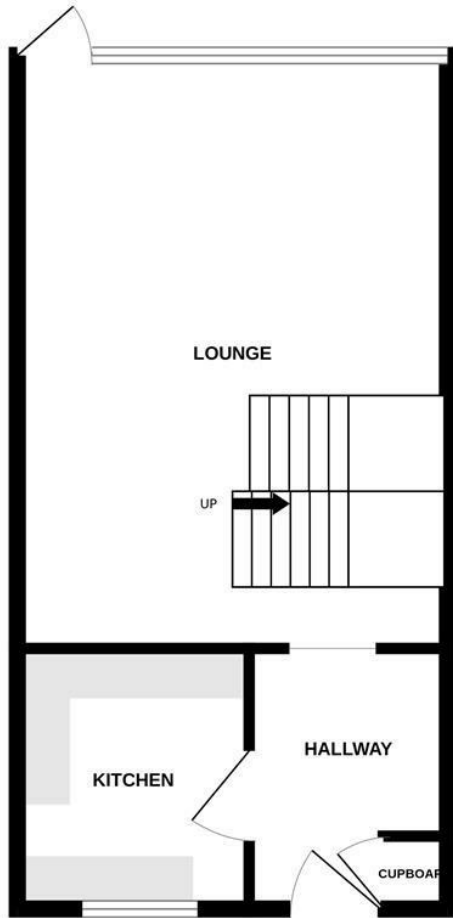

1ST FLOOR

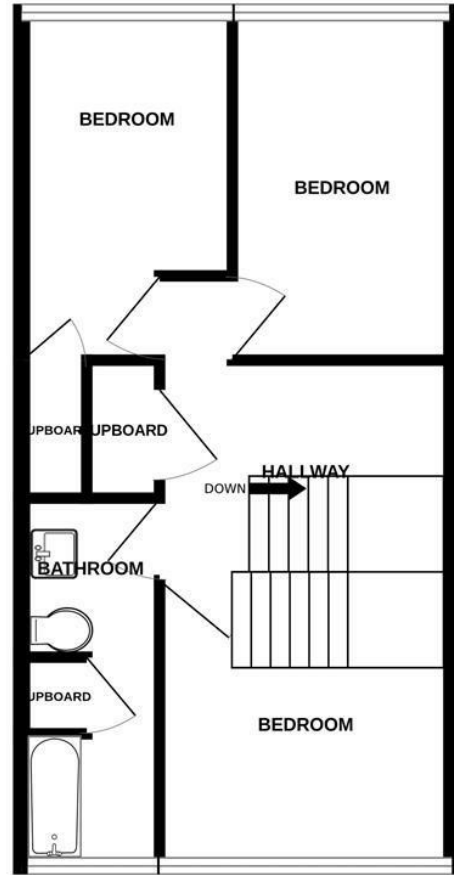

Whilst every attempt has been made to ensure the accuracy of the floorplan contained here, measurements of doors, windows, rooms and any other items are approximate and no responsibility is taken for any error, omission or mis-statement. This plan is for illustrative purposes only and should be used as such by any prospective purchaser. The services, systems and appliances shown have not been tested and no guarantee as to their operability or efficiency can be given.  
Made with Metropix ©2024

