



## 46 Fortinbras Way

, Chelmsford, CM2 9PA

Offers in excess of £565,000



# 46 Fortinbras Way

, Chelmsford, CM2 9PA

Offers in excess of £565,000



## Accommodation

### Ground floor

#### Entrance

Glazed entrance door, stairs to first floor.

#### WC

Low level WC, wash hand basin, window to front.

#### Kitchen/Diner

16'11 x 16'7 (5.16m x 5.05m)

A modern kitchen with a range of storage units to eye and base level. Integrated electric oven, dishwasher, washing machine and fridge/freezer. Work surfaces incorporate sink unit and an induction hob with an extractor fan. Window to front and rear, open to:

#### Second Reception Room

12'8 x 8' (3.86m x 2.44m)

Window to rear, doors to both sides leading to garden.

#### Lounge

16'3 x 10'4 (4.95m x 3.15m)

French doors to rear, window to front, wood flooring. Fireplace.

### First Floor

#### Landing

Stairs to ground floor, loft access

#### Bedroom One

13'2 x 8'10 (4.01m x 2.69m)

Window to front, carpet, door to bathroom.

#### Family Bathroom

10'2 x 6'10 (3.10m x 2.08m)

A four piece suite comprising of a jacuzzi bath, shower cubicle, close coupled WC, wash hand basin, heated towel rail, tiled walls.

#### Bedroom Two

13' x 7'10 (3.96m x 2.39m)

Window to rear and side, carpet.

#### Bedroom Three

10'3 x 9'3 (3.12m x 2.82m)

Window to front, fitted cupboards

#### Bedroom Four

7' x 6'6 (2.13m x 1.98m)

Window to rear, carpet.

### Exterior

#### Frontage

Off Road Parking

#### Garage

#### Rear Garden

Patio area, decked area, remainder laid to lawn, side access and access to garage.





## Road Map



## Hybrid Map



## Terrain Map



## Floor Plan

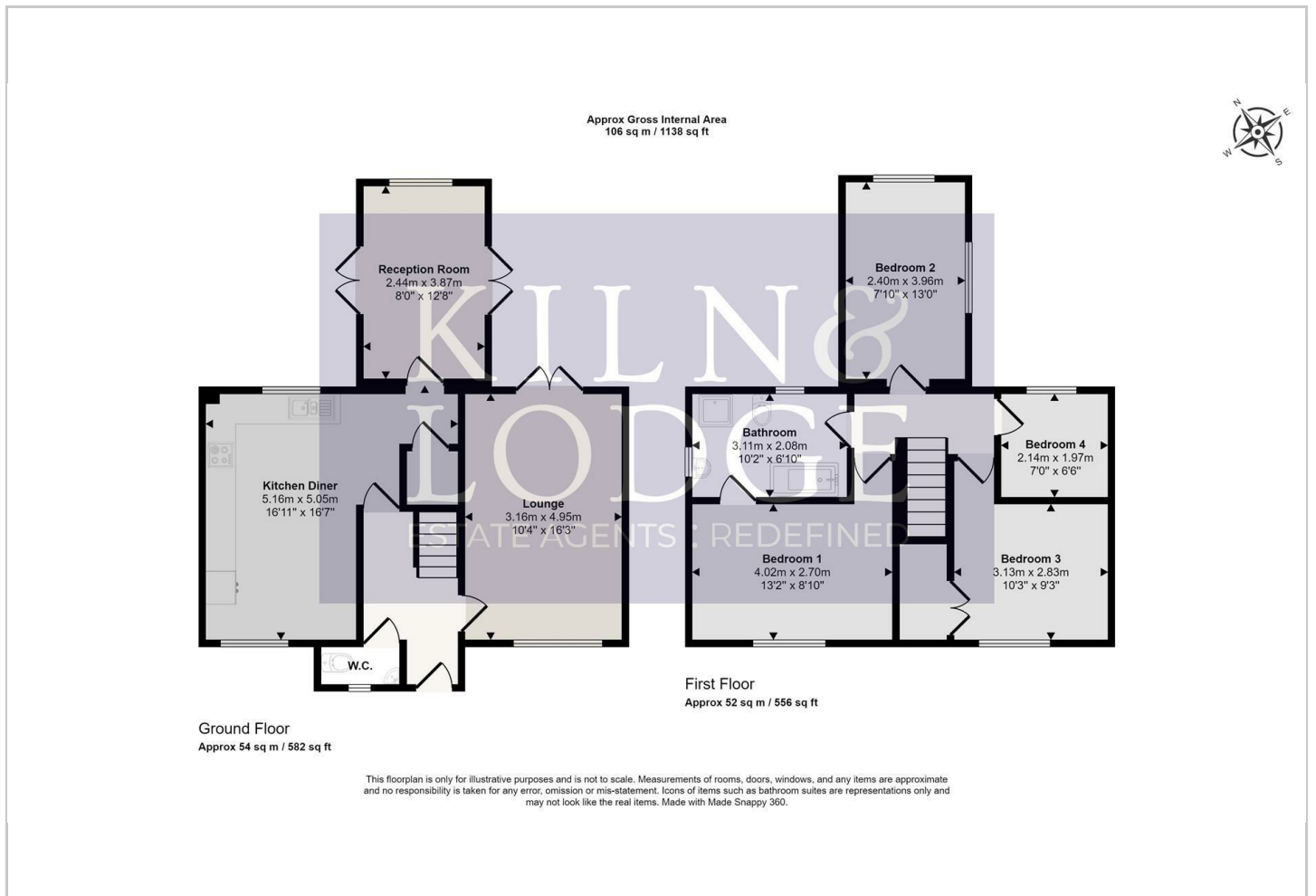

## Viewing

Please contact our Chelmsford Office on 01245 330764 if you wish to arrange a viewing appointment for this property or require further information.

## Energy Efficiency Graph

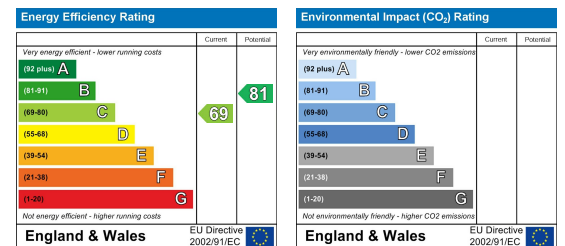

These particulars, whilst believed to be accurate are set out as a general outline only for guidance and do not constitute any part of an offer or contract. Intending purchasers should not rely on them as statements of representation of fact, but must satisfy themselves by inspection or otherwise as to their accuracy. No person in this firm's employment has the authority to make or give any representation or warranty in respect of the property.