

KILN & LODGE

ESTATE AGENTS : REDEFINED



Stepping Stones Stock Road

, Chelmsford, CM2 8PW

Asking price £645,000



** BACKS ONTO GALLEYWOOD COMMON **

An immaculately presented detached family home offering generous size lounge, conservatory, an impressive high specification kitchen/breakfast diner, utility room, four bedrooms, family and guest bathrooms, double garage with electric door and double glazing throughout. This property offers flexible and spacious accommodation.

A must see property!

Location

The property is situated in the popular village of Galleywood which is on the outskirts of Chelmsford. Local amenities are a short walk away and the bus routes into the city stop at the mainline station giving easy access into London Liverpool Street.



Lounge/Diner 33'0" x 14'11" max (10.06 x 4.57 max)
 A spacious bright and airy room with the entrance door and windows to the front.

Inner hallway
 Stairs to first floor, door to double garage, doors to:

Second Reception Room 45'11" x 32'9" x 29'6" x 3'3" (14'10 x 9'1)
 A great size room easily split into two, fireplace, patio doors to side into the garden.

Kitchen/Diner 65'7" x 22'11" x 36'1" x 32'9" x 29'6" x 16'4" (20'7 x 11'10 x 9'5)
 A re-fitted kitchen with fitted appliances, granite work surfaces incorporating a sink unit. Window to side, door to:

Shower Room
 Shower cubicle, fully tiled, low level wc, wash hand basin, heated towel rail, window to side.

Lean to/Store Room 16'9 x 9'9 (5.11m x 2.97m)
 Great for additional storage or a garden room

First Floor

Landing

Bedroom One 36'1" x 26'2" x 29'6" x 36'1" x 45'11" x 36'1" (11'8 x 9'11 x 14'11)
 A great sized room with fitted wardrobes, window to front.

Bedroom Two 36'1" x 19'8" x 36'1" (11'6 x 11')
 A double bedroom with fitted wardrobes, window to rear.

Bedroom Three 36'1" x 32'9" x 36'1" x 6'6" (11'10 x 11'2)
 A double bedroom with fitted wardrobes and a window to front.

Bedroom Four 8'0" x 6'7" (2.46 x 2.03)
 Fitted wardrobes, window to side.

Bathroom
 A replaced bathroom suite comprising a panelled bath with shower over, wash hand basin, low level wc, heated towel rail.

Exterior

Frontage
 Off road parking for 2 cars

Double garage

Rear Garden
 Low maintenance garden with access to Galleywood common.

Area Map



Floor Plans

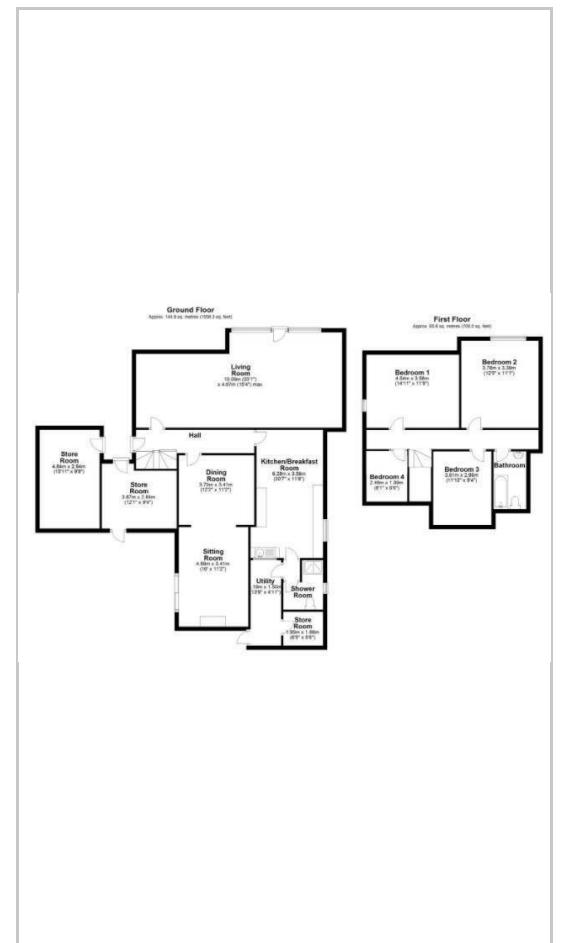

Energy Efficiency Graph

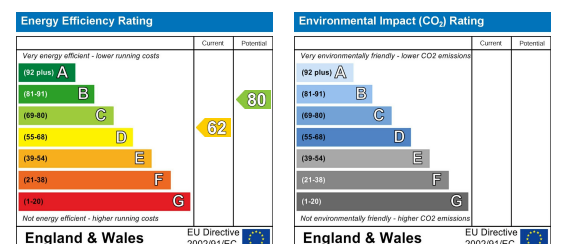

These particulars, whilst believed to be accurate are set out as a general outline only for guidance and do not constitute any part of an offer or contract. Intending purchasers should not rely on them as statements of representation of fact, but must satisfy themselves by inspection or otherwise as to their accuracy. No person in this firm's employment has the authority to make or give any representation or warranty in respect of the property.