

# DRAKES

ESTATE AGENTS



Yarningale Road, Kings Heath, B14 6NB

£367,500

- A Traditional Style Semi-Detached
- Three Bedrooms
- Through Lounge Dining Room
- Kitchen
- Utility Room
- Bathroom
- Impressive Corner Plot
- Tremendous Scope for Extension Subject to Permission
- Detached Garage & Off Road Parking
- Front, Side & Rear Gardens



SCAN TO VIEW  
VIRTUAL TOUR

3 Drakes Cross Parade, Hollywood, Birmingham B47 5HD

p: 01564 660950 e: sales@drakesestateagents.co.uk w: drakesestateagents.co.uk

Registered in England and Wales. Company No. 14363812 Registered address: 11 Swan Street, Alcester, England, B49 5DP





Lounge/Dining Room Dual Aspect

Dining Area to front - 3m x 3.89m (9'10" x 12'9") into bay

Lounge Area to rear - 3.81m x 2.64m (12'6" x 8'8")

Kitchen to rear - 2.84m x 2.34m (9'4" x 7'8")

Utility Room to side - 3.07m x 2.34m (10'1" x 7'8")

Bedroom One to front - 4.11m x 2.97m (13'6" x 9'9") into bay

Bedroom Two to rear - 3.94m x 2.97m (12'11" x 9'9")

Bedroom Three to front - 2.84m x 2.41m (9'4" x 7'11")

Bathroom to front - 2.24m x 1.75m (7'4" x 5'9")

Garage - 2.57m x 5.49m (8'5" x 18'0")

A traditional style semi-detached property occupying an impressive corner plot with tremendous scope for extension subject to the relevant planning consent with accommodation comprising in brief of reception hall, lounge/dining room, kitchen, utility room, three bedrooms, bathroom, generous front side and rear gardens, driveway and a detached garage.

**Ground Floor**

**First Floor**

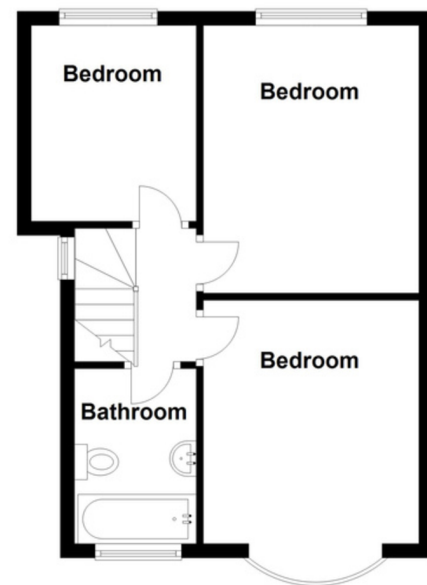
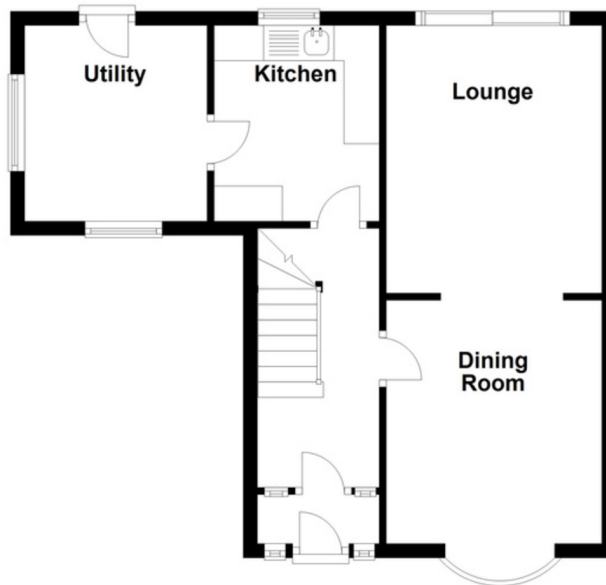

Energy Efficiency Rating	
	Potential
Very energy efficient - lower running costs	
(92 plus) <b>A</b>	
(81-91) <b>B</b>	81
(69-80) <b>C</b>	
(55-68) <b>D</b>	58
(39-54) <b>E</b>	
(21-38) <b>F</b>	
(1-20) <b>G</b>	
Not energy efficient - higher running costs	
<b>England &amp; Wales</b>	EU Directive 2002/91/EC

COUNCIL TAX BAND: C

EPC Rating: D

Tenure: Freehold

The vendor advises that the property is Freehold. Drakes Estate Agents will not be held responsible should this information be incorrect, and we request that your conveyancing solicitor verifies this throughout the conveyancing procedure.

Total area: approx. 83.3 sq. metres (896.8 sq. feet)

The information provided by Drakes Estate Agents do not constitute part of an offer or contract, the measurements are supplied for guidance only and as such must be considered incorrect, we have not tested any appliances, fittings, services or equipment or and we ask all potential buyers to check the working of any appliances and the measurements before committing to any expenses. For Money Laundering purposes we will request any potential buyer at offer stage to provide proof of identity before negotiation takes place. Drakes Estate Agents do receive a small referral fee from some Conveyancing Solicitors & Mortgage Brokers which is on a case-by-case basis, and is subject to a minimum referral fee of £50