

GROUND FLOOR
APPROX. FLOOR
AREA 41.5 SQ.M.
(447 SQ.FT.)

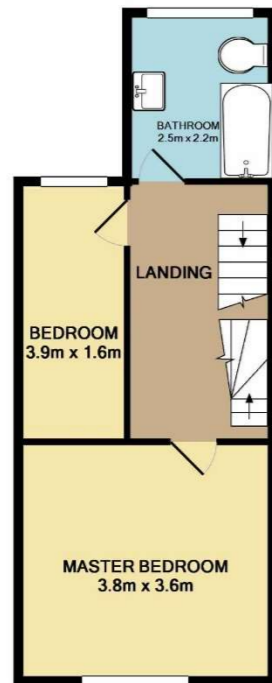

1ST FLOOR
APPROX. FLOOR
AREA 34.4 SQ.M.
(370 SQ.FT.)

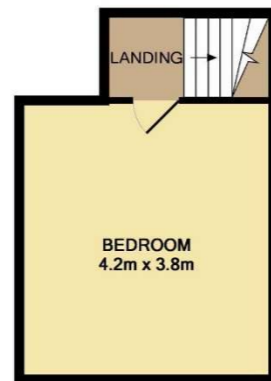

2ND FLOOR
APPROX. FLOOR
AREA 19.5 SQ.M.
(209 SQ.FT.)

TOTAL APPROX. FLOOR AREA 95.3 SQ.M. (1026 SQ.FT.)
Measurements are approximate. Not to scale. Illustrative purposes only
Made with Metropix ©2013

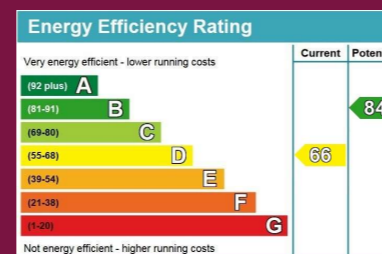

9 Sidney Street, Salisbury, Wiltshire SP2 7AH

£255,000 Freehold

Northwood incorporating Bassets are pleased to present this well presented three bed, mid-terraced property brilliantly located within a short walk of the Train Station & City Centre. The accommodation's first floor offers; an open plan sitting/dining room, kitchen, storage room and a small courtyard garden. The first floor compromises of 2 double bedrooms and a fitted bathroom with shower over bath. The second floor offers a further double bedroom. The property also benefits from double and gas central heating. Resident permit parking. **EPC: D Council Tax Band C.**

IMPORTANT: We would like to inform prospective purchasers that these sales particulars have been prepared as a general guide only. A detailed survey has not been carried out, nor the services, appliances and fittings tested. Room sizes should not be relied upon for furnishing purposes and are approximate. If floorplans are included they are for guidance and illustration purposes only and may not be to scale. If there are any important matters likely to affect your decision to buy, please contact us before viewing the property.



Overview

- THREE BEDROOM TERRACE HOUSE
- OVER THREE FLOORS
- NO FORWARD CHAIN
- LARGE LIVING ROOM
- ENCLOSED REAR YARD / GARDEN
- GAS CENTRAL HEATING



Living Area/ Dining Area (25'3" max X 10'2" max)

Kitchen (11'9" max X 6'10" max)

Bathroom (8'2" max X 7'2" max)

Bedroom 1 (12'5" max X 11'9")

Bedroom 2 (12'9" max X 5'3")

Bedroom 3 (13'9" max X 12'5" max)

Council Tax Band - C

Agents Note - Draft Copy of particulars

Disclaimer

These particulars are believed to be correct and have been verified by or on behalf of the Vendor. However, any interested party will satisfy themselves as to their accuracy and as to any other matter regarding the Property or its location or proximity to other features or facilities which is of specific importance to them. Distances and areas are only approximate and unless otherwise stated fixtures contents and fittings are not included in the sale. Prospective purchasers are always advised to commission a full inspection and structural survey of the Property before deciding to proceed with a purchase.