



Melbourne Grove, SE22
£700,000

Dexters



Melbourne Grove, SE22

A stunning two bedroom period conversion garden flat on the sought after Melbourne Grove SE22.

At the front of the property, you'll find two spacious double bedrooms, each featuring wonderful period details such as a stunning bay window and built-in storage. A modern family bathroom adds to the practicality of the home with a stylish finish. The heart of this home is the extended kitchen/reception room, an open-plan space designed for modern living and entertaining. With bi-fold doors leading out to the private, west-facing garden, this sociable area is bathed in natural light, thanks to a large skylight. The kitchen is beautifully appointed with a central island and breakfast bar, ideal for casual dining or socializing with family and friends. Step outside to the landscaped garden, a peaceful oasis perfect for outdoor relaxation and entertaining. The garden also boasts a versatile garden studio, offering additional space that could serve as an office, studio, or gym, flexible to suit your lifestyle needs.

Melbourne Grove is ultra-convenient being within easy reach to the shops, bars and restaurants of Lordship Lane. East Dulwich mainline provides frequent rail links to London Bridge. The green open spaces of Dulwich and Peckham Rye Parks are just a short walk away and there are a number of outstanding schools nearby.

Features

- Two Double Bedrooms
- West Facing Garden
- Excellent Location
- Open Plan Living
- Period Conversion
- Garden Studio







Melbourne Grove, London, SE22

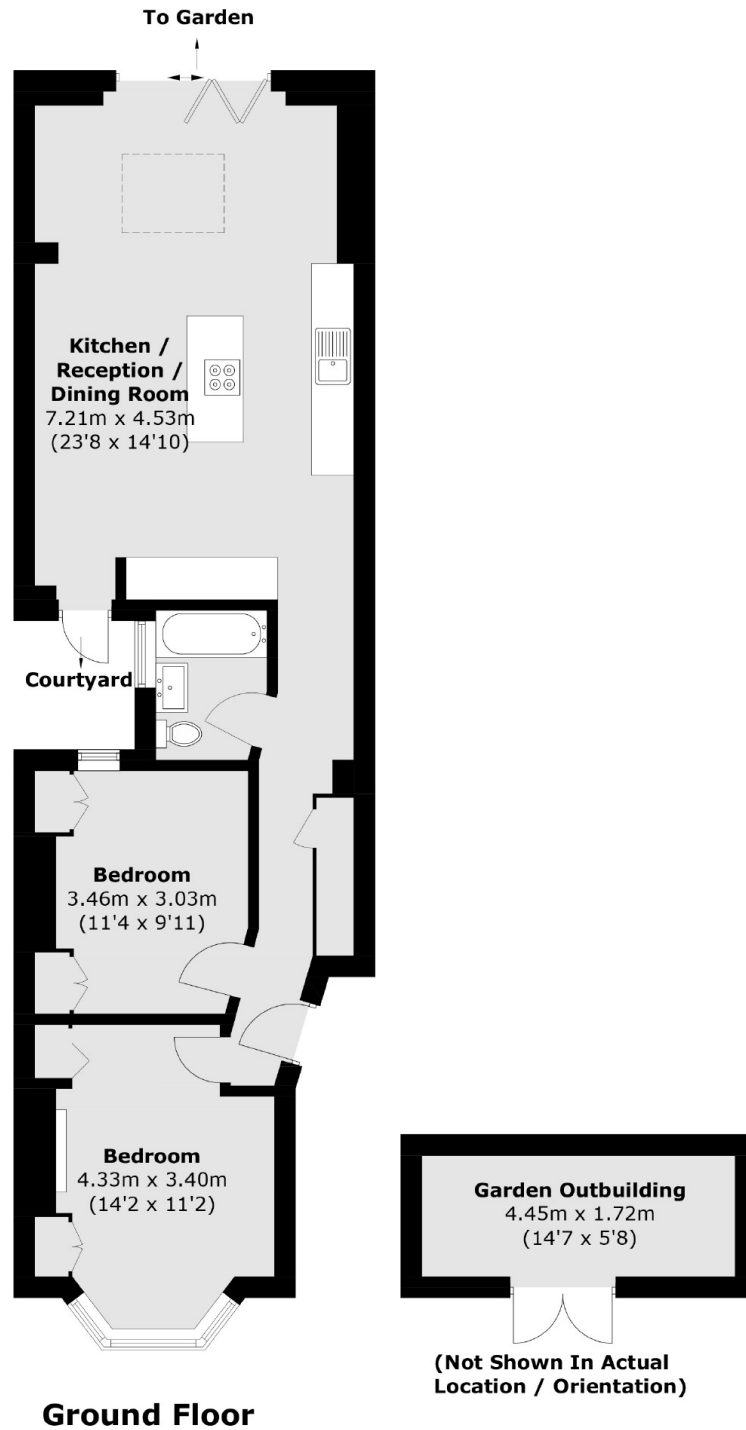

Total area (approx.): 69.3 sq. m (746.0 sq. ft)
Garden Outbuilding: 7.8 sq. m (84.0 sq. ft)

Dexters

East Dulwich
98 Grove Vale
London
SE22 8DR
Sales
020 8742 4142

Energy Rating: D. We aim to make our particulars both accurate and reliable. However they are not guaranteed; nor do they form part of an offer or contract. If you require clarification on any points then please contact us, especially if you're traveling some distance to view. Please note that appliances and heating systems have not been tested and therefore no warranties can be given as to their good working order.

 **RICS** | Regulated
Estate Agent
and Letting Agent

dexters.co.uk