



## Forest Hill Road, SE22

### £840,000

Offering huge potential and the opportunity to create a stunning family home, this wide and rarely available natural five bedroom, terraced Victorian house requires complete refurbishment. Arranged over three floors, retaining a wealth of period charm and bright and airy due to its high ceilings. The property offers an enticing project with plenty of potential for extension subject to the usual planning consents.

A short walk away from Peckham Rye Park, Forest Hill Road and is perfectly positioned for the local amenities in East Dulwich. Transport links are provided via multiple bus networks and mainline rail links from Peckham Rye and Honor Oak.

### Features

- Requires Refurbishment
- Terraced Victorian House
- Five Bedrooms
- Period Features
- Mature Large Garden
- No Onward Chain

# Forest Hill Road, London, SE22

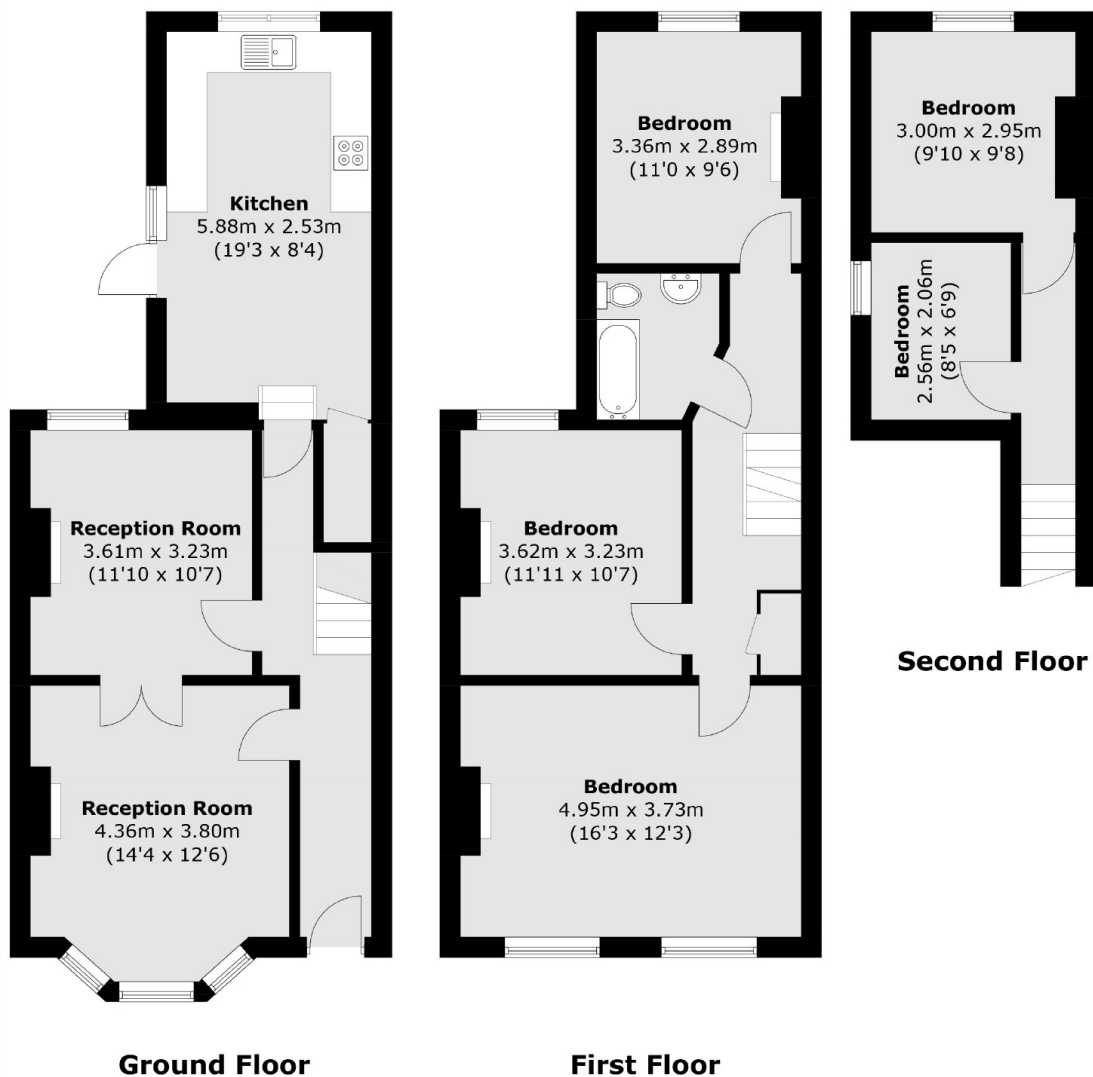

Total area (approx.): 130.1 sq. m (1400.4 sq. ft)