



Barry Road, SE22

£399,950

This charming two double bedroom ground floor flat, located on the popular Barry Road in East Dulwich, offers a fantastic opportunity for buyers looking to put their own stamp on a property. Perfect for those with vision, this well-proportioned flat is in need of modernisation and presents immense potential to create a stylish home in a prime location. It is being sold with a share of the freehold and no onward chain.

Barry Road is perfectly positioned for the green open spaces of Peckham Rye as well as all the local amenities available on Lordship Lane. Mainline train connections can be found from East Dulwich, Peckham Rye & Honor Oak Stations.

Features

- No Onward Chain
- Share Of Freehold
- Two Bedrooms
- Private Garage
- Communal Gardens
- Ground Floor

Barry Road, London, SE22

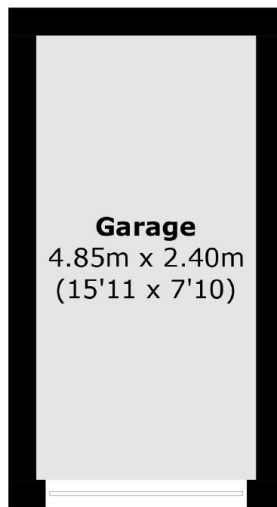

(Not Shown In Actual
Location / Orientation)

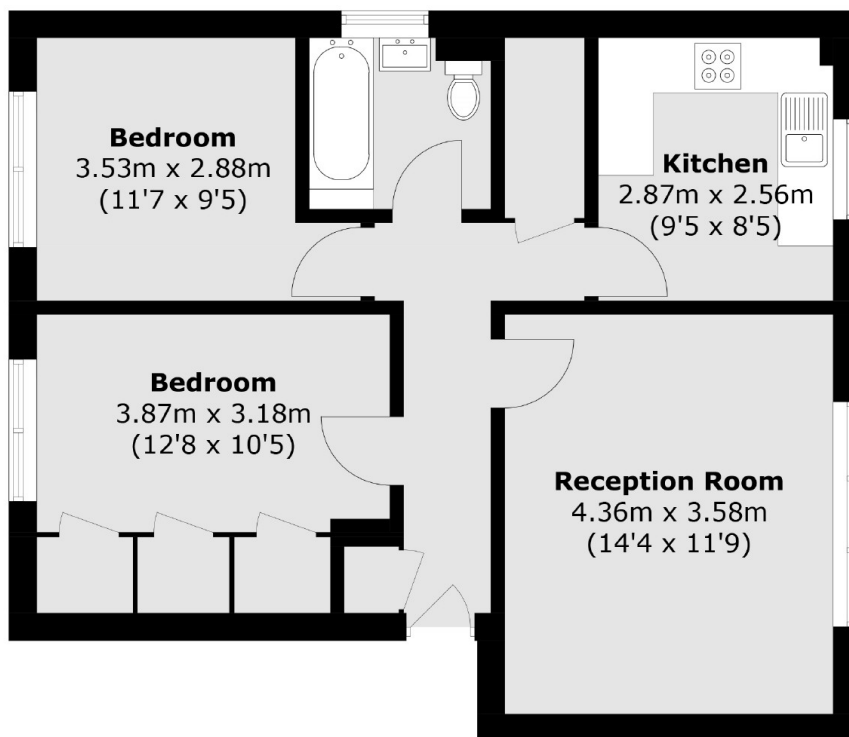

Total area (approx.): 58.6 sq. m (630.7 sq. ft)
Garage (approx.): 11.6 sq. m (124.8 sq. ft)