



## Lordship Lane, SE22

£450,000

Located within a small private development this modern apartment ticks all the boxes. Well presented through out, it offers two good-size double bedroom, bright reception with plenty of space for dining, separate kitchen and modern bathroom. With the added benefits of an allocated parking space and no onward chain, it presents the perfect step on to the property ladder.

Gloucester Court is a modern development situated along Lordship Lane and perfectly placed for many of the areas amenities, including independent restaurants, local shops and bars. The green open spaces of Dulwich Park are close at hand as are frequent rail connections from Forest Hill (Overground) and West Dulwich stations.

### Features

- Modern Development
- Two Double Bedrooms
- Good Decorative order
- Allocated Parking Space
- Communal Gardens
- No Onward Chain



## Lordship Lane, SE22

Offering well-balanced and generous accommodation with all its square footage fully utilised. The main 18' reception offers great living and entertaining space, with a Juliette balcony over looking well kept communal gardens, it has ample space for a large sofa and a dining table whilst the fitted kitchen is well-equipped.

Two generous double bedrooms, the master benefiting fitted wardrobes are served by a stylish bathroom/WC with further storage available in the entrance hall.



# Lordship Lane, London, SE22

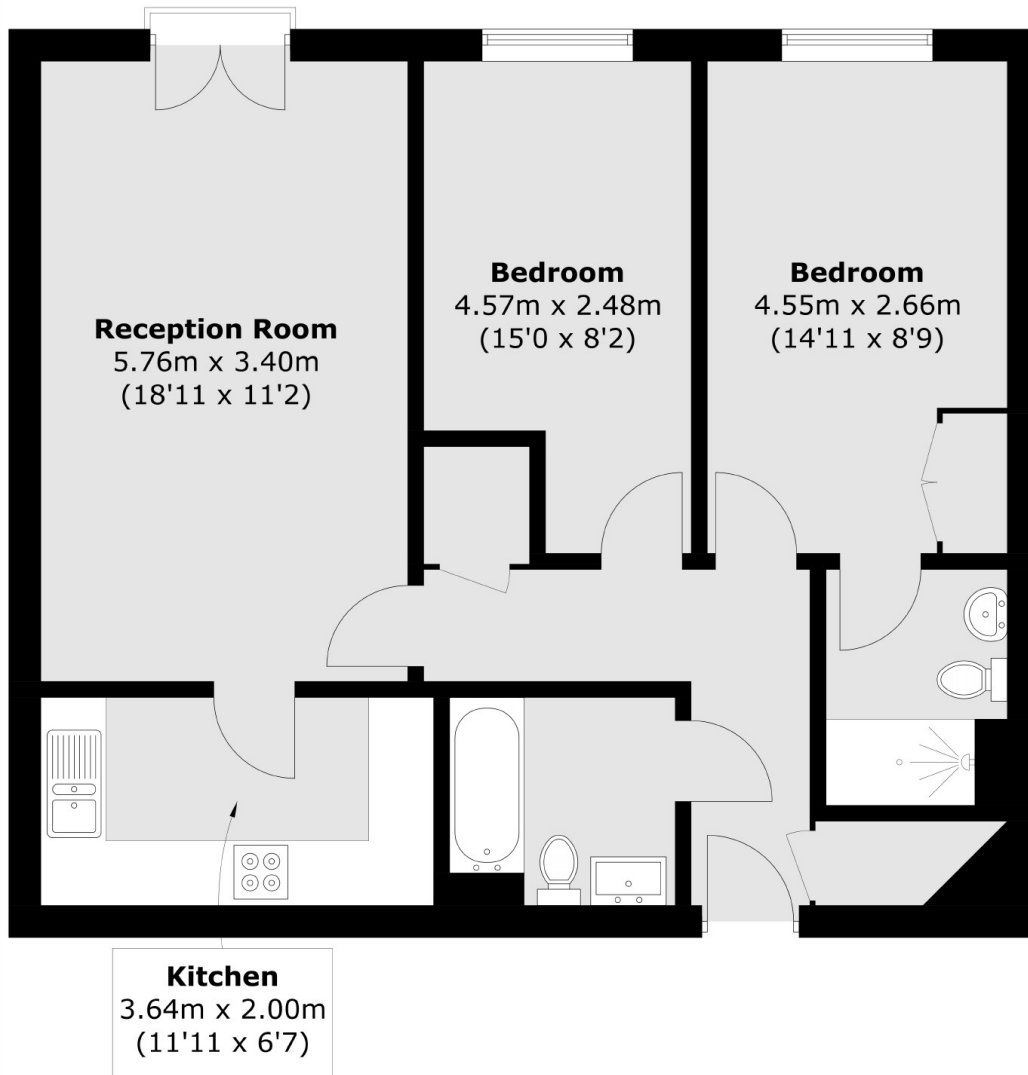

## Second Floor

Total area (approx.): 70.6 sq. m (759.9 sq. ft)