



Dovedale Road, SE22

£1,000,000

A three bedroom family home in a sought after road, just a stones throw from Peckham Rye Park. A unique and rare opportunity to acquire one of these fantastic 1930s houses before it has been modernised. Dovedale Road is a very sought after tree lined road just a few moments from the open space of Peckham Rye Park. The property is in need of complete refurbishment throughout including new windows to the back. Once done up this property would be a spectacular family home once again.

Dovedale Road can be found directly off Colyton Road which runs alongside the open space of Peckham Rye. A wide variety of dining, shopping and transport options found on Lordship Lane, with transport links provided via multiple bus networks and rail links from Honor Oak and Peckham Rye station serving London Bridge and City Thameslink.

Features

- Large Garden
- Chain Free
- Three Double Bedrooms
- Sought After Road
- Development Opportunity
- New Double Glazed Front Windows

Dovedale Road, London, SE22

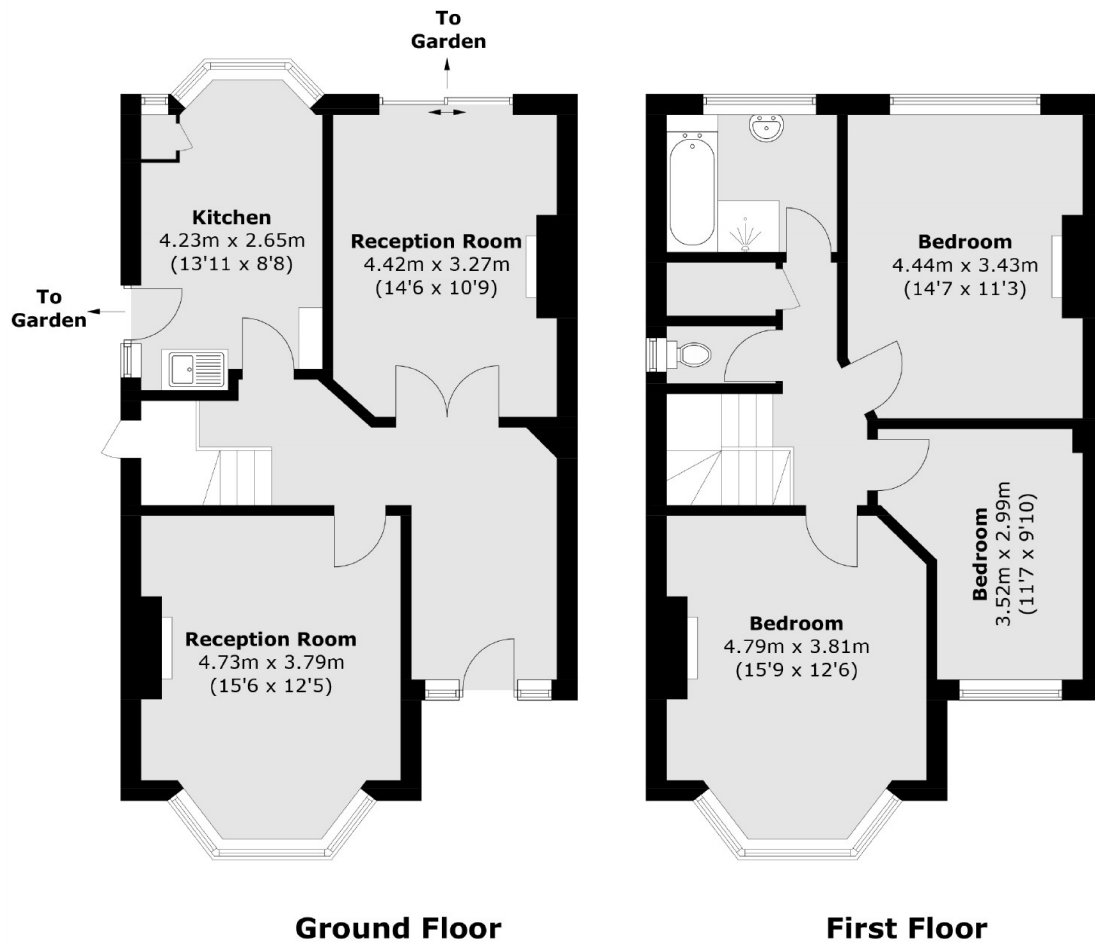

Total area (approx.): 116.4 sq. m (1,252.9 sq. ft)