



## Mundania Road, SE22

£425,000

This superb ground floor one-bedroom garden flat is ideally located in an imposing Victorian house, situated on one of SE22's most prestigious roads.

Mundania Road is a popular tree-lined street within easy reach to local amenities including a number of independent shops and bars with both Rye Lane and Lordship Lane within walking distance. The Green open spaces of Peckham Rye Park. There are frequent bus routes along Forest Hill Road and rail links from Peckham Rye and Honor Oak Park.

### Features

- Ground Floor
- Victorian Conversion
- Bright Open Plan Living
- Double Bedroom
- Private Patio
- Share Of Freehold



## Mundania Road, SE22

Contemporary in feel throughout, it offers a light open plan living space with a sleek modern kitchen, stylish bathroom and double bedroom with fitted storage leading to a private patio garden and onto a large communal garden. Sold with share of freehold and no onward chain.



# Mundania Road, London, SE22

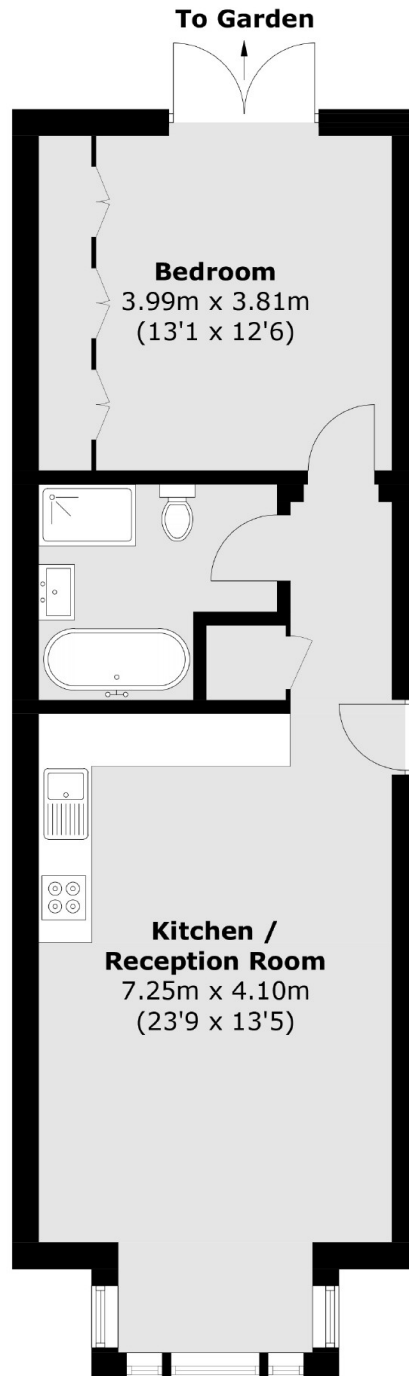

Total area (approx.): 53.3 sq. m (573.7 sq. ft)