



Farrington House, Aston Cantlow Road, Aston Cantlow, B95 6JS

Guide Price £1,600,000

**Hawkins & Patterson**  
ESTATE AGENTS

 Solihull 0121 705 1515  
Henley-in-Arden 01564 795 757  
 [sales@hawkinspatterson.com](mailto:sales@hawkinspatterson.com)  
[www.hawkinspatterson.com](http://www.hawkinspatterson.com)  
 110 High Street, Henley-in-Arden,  
Warwickshire, B95 5BS



# Farrington House, Aston Cantlow Road, Aston Cantlow, B95 6JS

A simply stunning high quality Warwickshire Farmhouse blending a wealth of traditional features with the very best of contemporary living. The generous & beautifully appointed living space is complimented by a landscaped parkland garden with countryside beyond. Peace & quiet but not isolated. An absolute peach of a home.

## APPROACH

Electric gates open into the gravelled driveway passing the three Cart Shed garages to the parking & turning space. Riven paved, meandering footpath through a magnificent courtyard garden to,

## LOBBY

Part glazed front door & side windows. Flagstone flooring which extends through a number of the ground floor rooms, with under floor heating throughout the downstairs.

## GUESTS WC

Low flush WC & one piece wash basin. Exposed feature brick wall.

## DRAWING ROOM

A superb, triple aspect entertaining room. With 4 double French doors out to the patio & garden with external electric awnings.

## INNER HALL / SNUG

A lovely snug winter or cool Summer room. Flagstone floor, exposed brick inglenook with recessed grate for a real fire. Adjacent store cupboard. Staircase off. Exposed Oak ceiling beams.

## SITTING ROOM

Walk in bay window with further side window. Chimney breast with exposed brick & Oak mantel housing wood burning stove. Beamed







## STUDY / HOME OFFICE

An ideal for the home worker or playroom? Oak floor. Walk in bay window and adjacent half glazed door out to the garden, ideal for that coffee break. Wood burning stove within a brick surround. Beamed ceiling.

## DINING ROOM

A beautiful room. Dark Oak polished floor. Windows on two sides and a half glazed door out to the side courtyard. Magnificent beamed ceiling.

## DUAL ASPECT BREAKFAST KITCHEN

This fully vaulted duel aspect room is and will always be the heart of the home. With bespoke painted units complimented by every top quality appliance you would expect or want. Ample space for relaxed dinning. Come & see for yourself.

## PANTRY

Again missing nothing that such a room should provide plus an additional dishwasher. Cupboard housing the pressurised hot hot water system. The air sourced heat pump is outside within its own courtyard.









## ON THE FIRST FLOOR

The staircase splits, to the right,

### BEDROOM ONE

A large bedroom with open vaulted ceiling. Twin Velux & rear windows. Oak wardrobes. Walk in to,

### EN-SUITE & WC

Full width glass sided shower. with rainfall head & hand held shower. Bath with side taps & shower attachment. Oak & granite table with freestanding wash basin. The WC is in a separate room with exposed brick wall, window & wash basin.

### INNER LANDING

With Pine flooring

### BEDROOM TWO

Oak floor. Dormer rear window. Double cupboard. Exposed wall & ceiling beams.



## BATHROOM

With a large airing cupboard before you enter the room. Glass enclosed shower cubicle as described before. Bath & WC with concealed cistern. Oak table with freestanding circular wash basin. Side window. Ceiling beams & under floor heating

### BEDROOM THREE

Pine floor. Windows on two sides. Wardrobe.

### EN-SUITE

Also under floor heated. Glass enclosed shower. Dual flush WC & wash basin. Ceiling beams.

### LAUNDRY ROOM

As favoured on the Continent. A range of fitted cupboards & drawers. Marble worktop. China sink. Plumbing for washing machine & space for further appliances. Best of all a beautiful view whilst undertaking the domestic work.





## ON THE SECOND FLOOR

Oak staircase.

## INTERCONNECTING BEDROOMS FOUR & FIVE

Ideal private space for guests with two large double rooms sharing,

## EN-SUITE

Under floor heating. Corner shower. WC with concealed cistern and part recessed wash basin.

## OUTSIDE

## SIDE COURTYARD

South facing sheltered & private dining area with gate into,

## BRICK LARDER/WINE STORE

An air conditioned "bonus building" with vaulted ceiling. Double external doors. currently housing further freezers & pantry. Air sourced heat pump.



## THREE CAR CARTSHED

Two double doors garages and attached open cart shed. Power & lighting

## MAGNIFICENT PARKLAND GARDENS

So often the outside is not a match for the house but not here. Landscaped with great care & knowledge. Profusely stocked flowerbeds, fruit trees, extensive lawn. Vegetable area & greenhouse. All bordered with hedging & the countryside beyond. An evening stroll with a glass of wine around your own piece of paradise. Come & see for yourself.





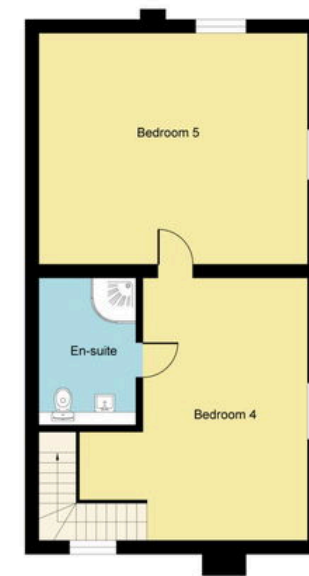

Although every attempt has been made to ensure accuracy, all measurements are approximate.  
 This floorplan is for illustrative purposes only and not to scale.  
 Measured in accordance with RICS Standards.