



Harbour Avenue, SW10  
£2,350,000

**Dexters**



## Harbour Avenue, SW10

A luxury three bedroom apartment in sought after Chelsea Harbour. This apartment features a large living/kitchen area including integrated Gaggenau and Miele appliances, two private balconies, a walk-in wardrobe to the master bedroom and a separate study area. On site facilities include 24 hour concierge, residents gym and a private roof terrace with views towards the River Thames.

Lighterman Towers has multiple transport links. Being a few minutes walk to Imperial Wharf station with access to the Overground and one stop to West Brompton with the District line. 24 hour buses run close by on the King's Road. Thames Clipper River services are on hand from Imperial Wharf to take you as far as Canary Wharf and Greenwich. One of the best ways to travel around London.

### Features

Three Double Bedrooms

Two Bathrooms

Allocated Parking \*\*

Two Balconies

Concierge

Gym - Communal Roof Terrace







# Harbour Avenue, London, SW10

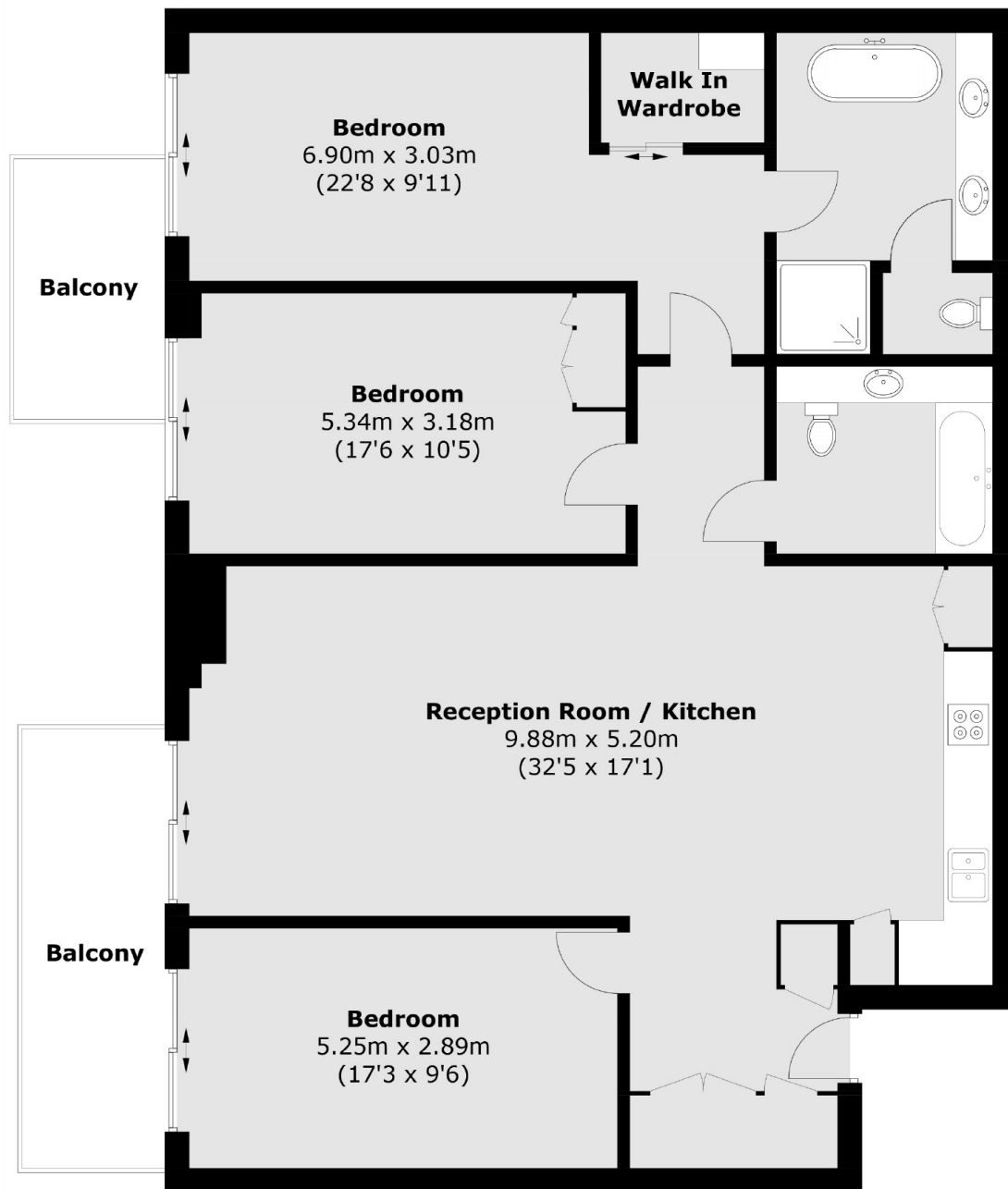

Total area (approx.): 134.5 sq. m (1,447.7 sq. ft)  
Balcony (approx.): 15.4 sq. m (165.8 sq. ft)