



Earlsfield Road, SW18

£850,000

Situated in a Victorian villa built in 1885 and rich in local history, this newly refurbished three-bedroom, two-bathroom conversion features a spacious southeast-facing garden. It also offers an allocated parking space, low running costs, and a 999-year lease.

"Photography used from a previous development by the same developer also on the same road to display an indicative final finish"

Earlsfield is a charming and vibrant area located in the southwest London borough of Wandsworth. This residential neighbourhood exudes a unique blend of urban convenience and suburban tranquillity, making it a popular choice for families and young professionals alike.

Features

- Victorian Rebuild - 1885
- Victorian Period Conversion
- Allocated Parking Space
- Private Garden
- Three Bedrooms
- Two Bathrooms
- 999 Year Lease

Earlsfield Road, Earlsfield, SW18

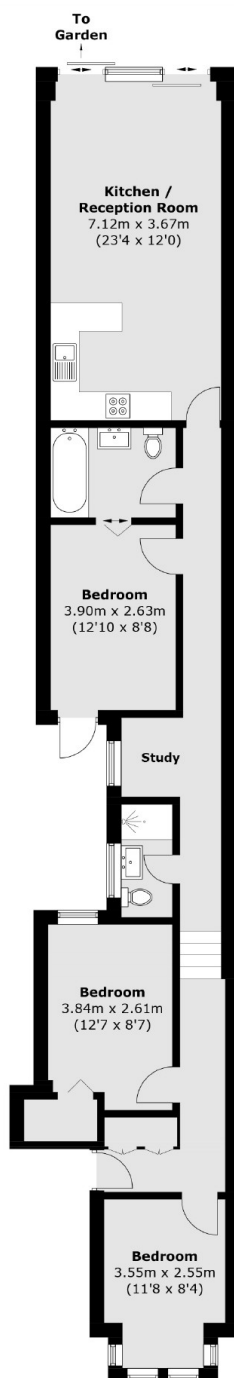

Lower Ground Floor

Total area (approx.): 87.6 sq. m (942.9 sq. ft)