



## Court Farm Road, SE9

£280,000

A one double-bedroom apartment, with a West facing roof terrace and communal gardens. There is a high specification, energy-efficient design throughout resulting in low running costs. Offered to the market chain free, all with a share of the freehold.

Court Farm Road is well-connected in terms of transportation. Eltham Station is the closest railway station, offering regular services to London Cannon Street, London Charing Cross, and other central London destinations.

### Features

- West Facing Terrace
- One Bedroom
- Low Running Costs
- Share Of The Freehold
- Communal Gardens
- Great Design

Court Farm Road,  
Eltham, SE9

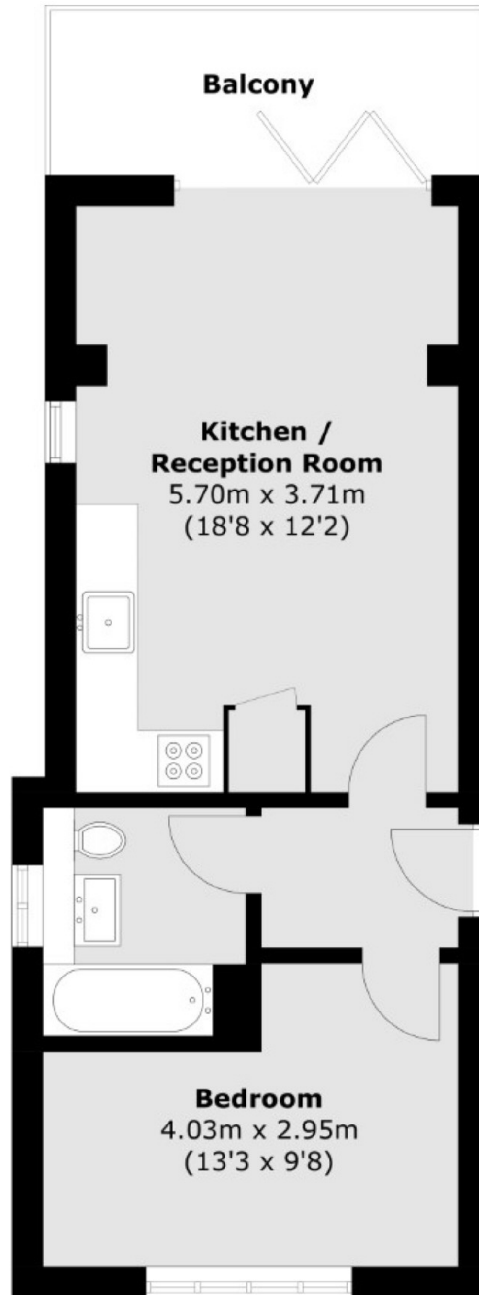

## First Floor

Total area (approx.): 40.2 sq. m (432.7 sq. ft)  
Balcony: 6.7 sq. m (72.1 sq. ft)

**Dexters**

New Homes South London  
12 The Broadway  
London  
SW19 1RF  
Sales  
020 8674 4555

Energy Rating: . We aim to make our particulars both accurate and reliable. However they are not guaranteed; nor do they form part of an offer or contract. If you require clarification on any points then please contact us, especially if you're traveling some distance to view. Please note that appliances and heating systems have not been tested and therefore no warranties can be given as to their good working order.

 **RICS** | Regulated  
Estate Agent  
and Letting Agent

dexters.co.uk