



## Court Farm Road, SE9

£299,950

A one double bedroom, ground-floor apartment with a West-facing patio/garden. There is a high-level specification throughout, including German appliances and underfloor heating in the bathroom. The property benefits from an allocated parking space, with electric car charging and access to communal gardens.

Eltham boasts a rich history, with landmarks such as Eltham Palace, a medieval royal residence turned Art Deco mansion, highlighting the area's historical significance. Court Farm Road is well-connected in terms of transportation. Eltham Station is the closest railway station, offering regular services to London Cannon Street, London Charing Cross, and other central London destinations.

### Features

- West Facing Patio
- One Double Bedroom
- Share Of The Freehold
- Underfloor Heating In Bathroom
- Allocated Parking Space
- Electric Car Charging

Court Farm Road,  
Eltham, SE9

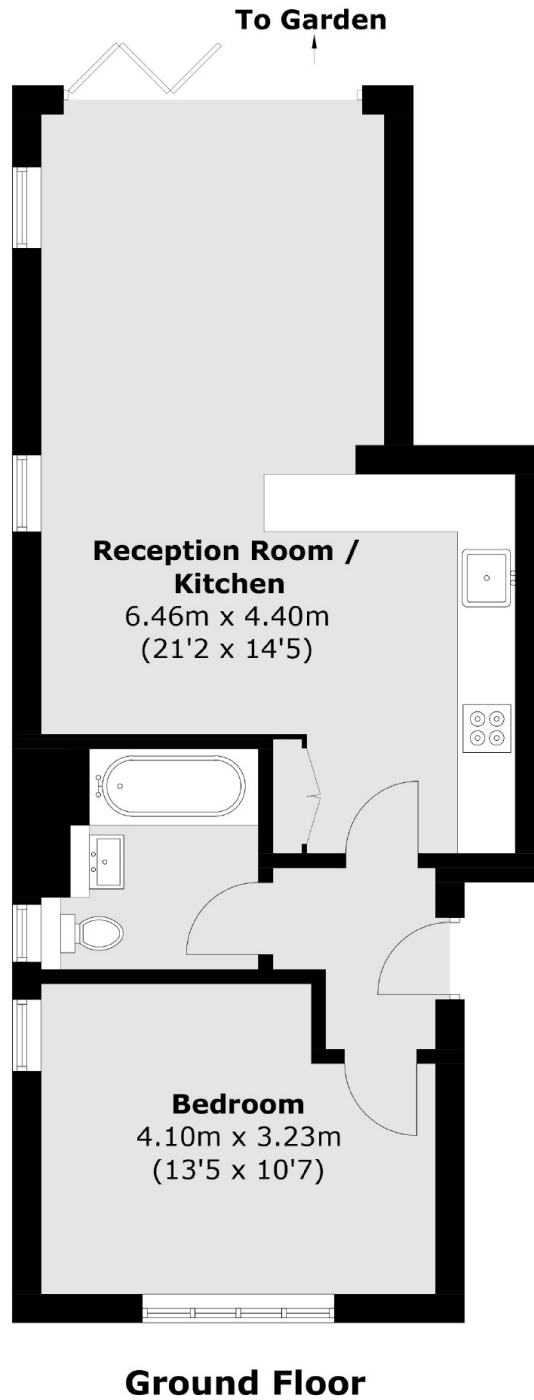

Total area (approx.): 52.3 sq. m (562.9 sq. ft)

**Dexters**

New Homes South London  
12 The Broadway  
London  
SW19 1RF  
Sales  
020 8674 4555

Energy Rating: . We aim to make our particulars both accurate and reliable. However they are not guaranteed; nor do they form part of an offer or contract. If you require clarification on any points then please contact us, especially if you're traveling some distance to view. Please note that appliances and heating systems have not been tested and therefore no warranties can be given as to their good working order.

 **RICS** | Regulated  
Estate Agent  
and Letting Agent

dexters.co.uk