

Inglemere Road, CR4

£500,000

An EPC-rated A, ground floor garden flat. There are two double bedrooms, a large utility room and an open plan kitchen diner with sliding doors into the garden. Eco credentials include solar panels on the roof, rainwater harvesting and mechanical ventilation systems.

Located in the heart of Tooting's vibrant transport nexus, Park Apartments are a gem for the modern commuter. These residences are just a short 2-minute walk from the Tooting overground station, offering unmatched convenience for those seeking swift connectivity.

Features

- Two Double Bedrooms
- Private Garden
- Solar Panels
- Battery Power Storage
- Highly Energy Efficient
- Mechanical Ventilation System

Inglemere Road, Mitcham, CR4

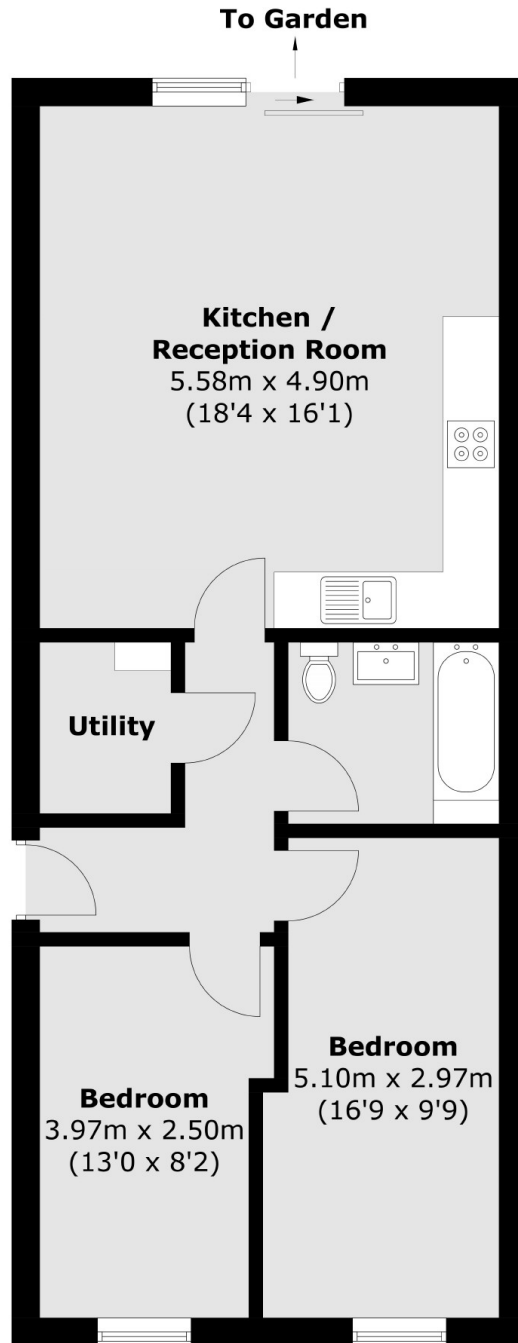

Total area (approx.): 63.7 sq. m (685.7 sq. ft)