



Hartfield Road, SW19

£550,000

A first floor one double bedroom apartment in a prime location in Wimbledon Town Centre. There is an open-plan kitchen/diner, a large balcony to the rear and overlooking the communal gardens on the ground floor. The property is ready for occupation in Q2 2024.

Hartfield Road is located just off of The Broadway, equidistant to both the district line (Wimbledon) and northern line (South Wimbledon) with shops, bars and delicious restaurants are all on your doorstep, whilst being in the catchment for outstanding schools.

Features

- Open Plan Kitchen/Diner
- One Double Bedroom
- Balcony + Communal Gardens
- High Specification Finish
- Secure Building With Lift
- Highly Energy Efficient
- Low Running Costs
- Move In Q2 2024

Hartfield Road,
Wimbledon, SW19

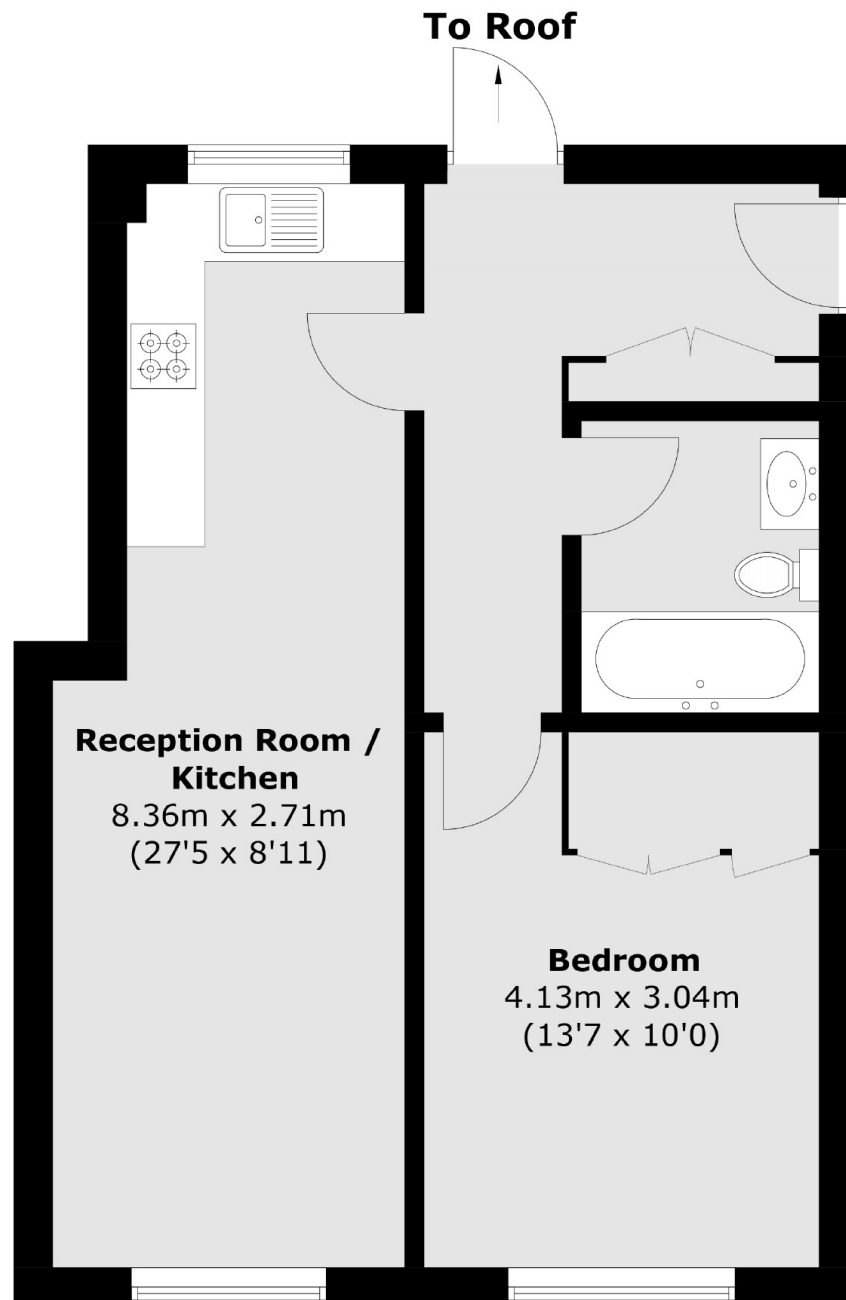

Total area (approx.): 47.4 sq. m (510.2 sq. ft)

Dexters

New Homes South London
12 The Broadway
London
SW19 1RF
Sales
020 8674 4555

Energy Rating: . We aim to make our particulars both accurate and reliable. However they are not guaranteed; nor do they form part of an offer or contract. If you require clarification on any points then please contact us, especially if you're traveling some distance to view. Please note that appliances and heating systems have not been tested and therefore no warranties can be given as to their good working order.

 **RICS** | Regulated
Estate Agent
and Letting Agent

dexters.co.uk