



## Yelverton Road, SW11

£525,000

A large one double bedroom, apartment on the twelfth. There is an amazing view of the London skyline towards The Shard. There is underfloor heating, a mechanical ventilation system and really energy efficient windows, providing for extremely low bills.

Photos shown of an alternative apartment whilst construction completes

Yelverton Road Is conveniently located for access to Clapham Junction Station as well as the nightlife of both Clapham and Battersea. Near to both Battersea Power Station & Chelsea you are never far from food, drinks and entertainment.

### Features

- London Skyline Viewing
- One Large Double Bedroom
- Twelfth Floor
- Concierge In Building
- Podium Communal Gardens
- Near To Battersea Park
- Near Battersea Power Station

Yelverton Road,  
Battersea, SW11

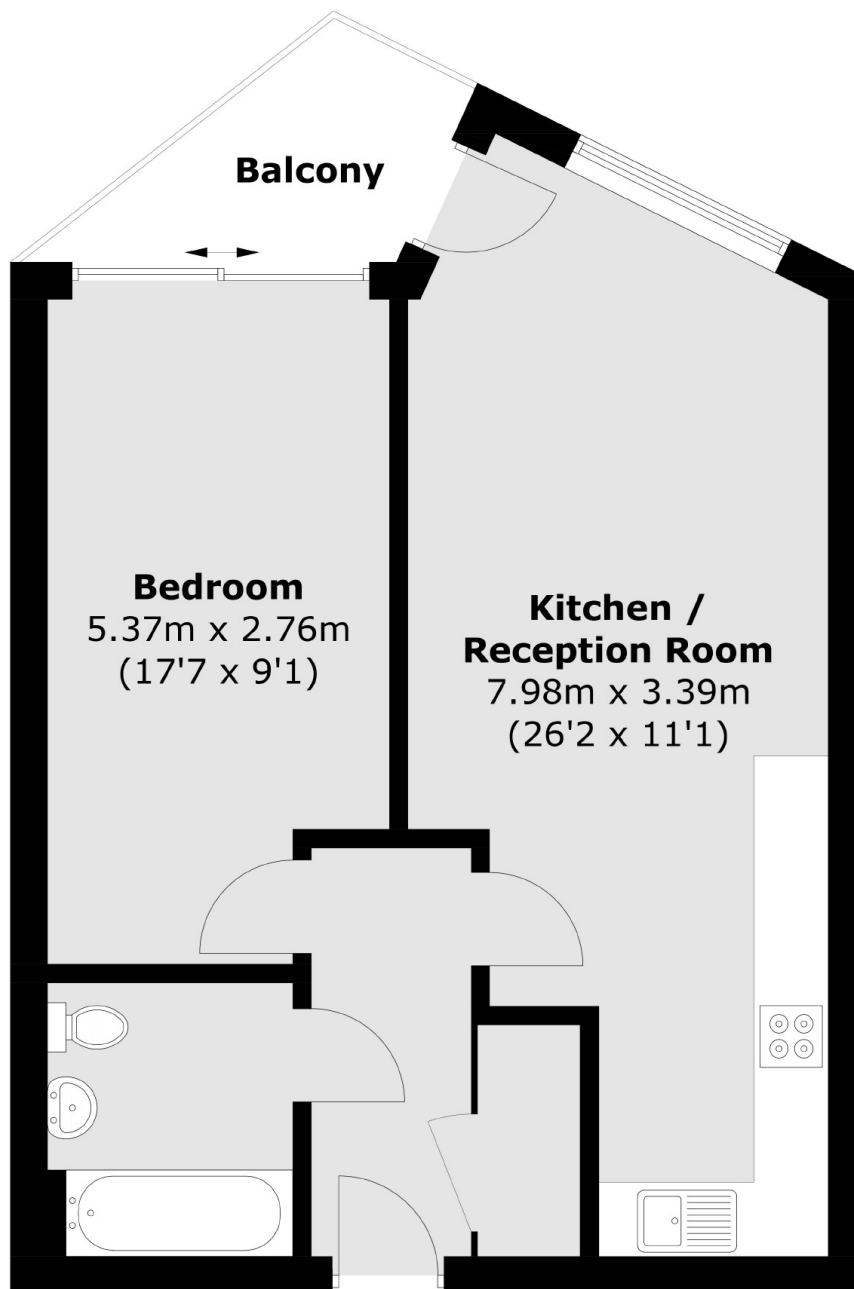

Total area (approx.): 51.5 sq. m (554.3 sq. ft)  
Balcony: 4.0 sq. m (43 sq. ft)

**Dexters**

New Homes South London  
12 The Broadway  
London  
SW19 1RF  
Sales  
020 8674 4555

Energy Rating: . We aim to make our particulars both accurate and reliable. However they are not guaranteed; nor do they form part of an offer or contract. If you require clarification on any points then please contact us, especially if you're traveling some distance to view. Please note that appliances and heating systems have not been tested and therefore no warranties can be given as to their good working order.

 **RICS** | Regulated  
Estate Agent  
and Letting Agent

dexters.co.uk