

# 58 Surrenden Crescent

Brighton, BN1 6WF

**Offers in the region of £1,750,000**

Nestled in the prestigious Surrenden Crescent, this magnificent five-bedroom detached family home spans over 3,500 sq. ft., offering a perfect balance of space, luxury, and practicality. Just a short walk from Preston Park mainline station, Surrenden Park, and Preston Park itself, the location is ideal for families and commuters alike.



- Detached 5 Bedroom House
- Desirable Surrenden Area
- Over 3,535.93 sqft
- Gated Private Driveway
- Walking Distance To Preston Park Train Station
- Double Garage
- Wrap around garden with mature trees
- Three Reception Rooms
- Separate Utility Room
- Two Bathrooms

Energy Efficiency Rating		
	Current	Potential
Very energy efficient - lower running costs		
(92 plus) A		
(81-91) B		
(69-80) C		
(55-68) D		
(39-54) E		
(21-38) F		
(1-20) G		
Not energy efficient - higher running costs		
	63	77
England & Wales		EU Directive 2002/91/EC



## SURRENDEN CRESCENT

Approx. Gross Internal Floor Area 328.5 sq m / 3535.93 sq ft  
Illustration for identification purposed only, measurements are approximate, not to scale.

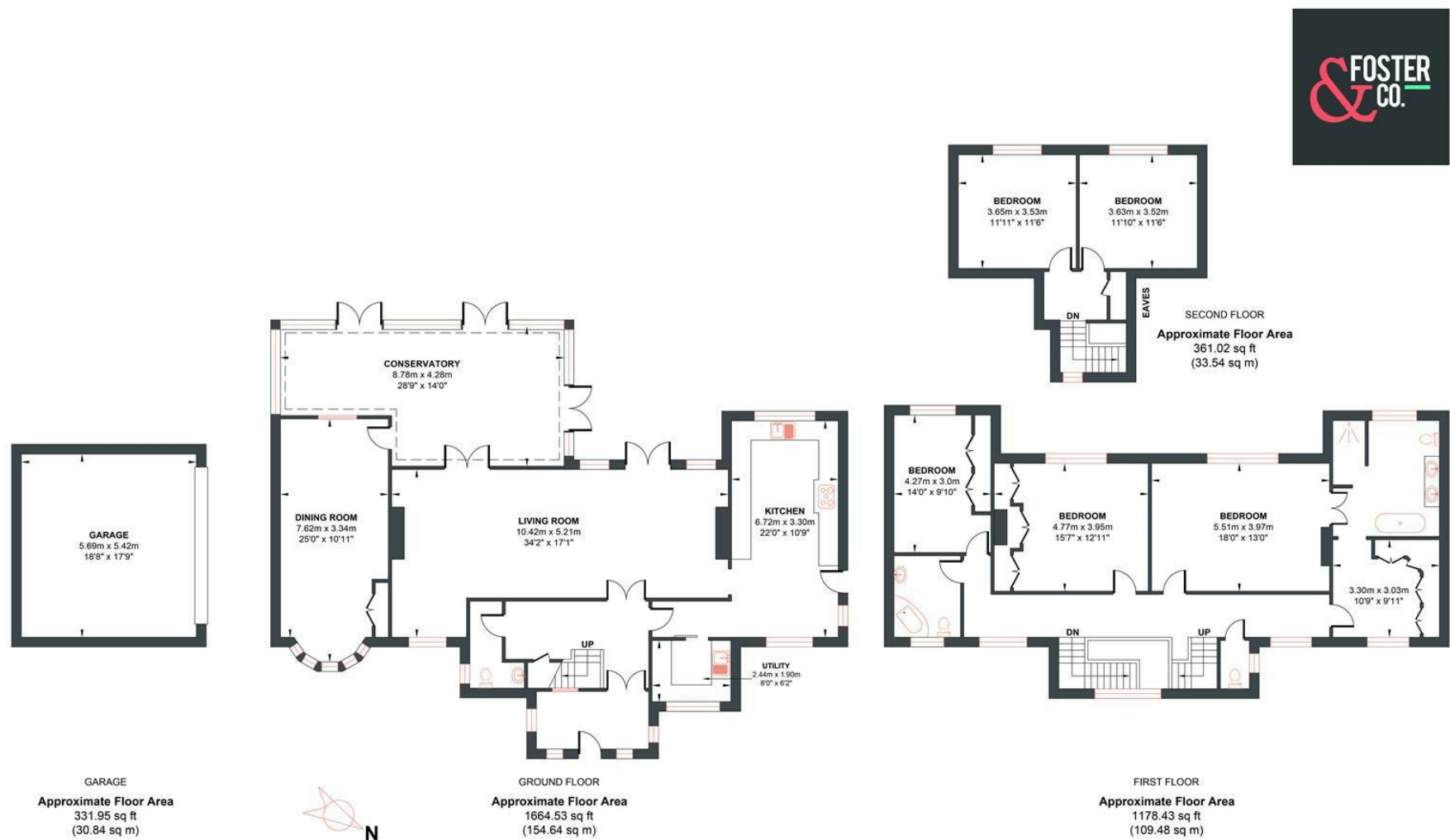

Foster & Co and their clients give notice that:  
These sales particulars do not constitute any part of an offer of contract and are for guidance for prospective purchases only and should be not relied upon as a statement of fact.  
We are not to be held responsible for material information that has not been given to us by our client at the time of marketing.  
All measurements are approximate

