

3 Florence Road

Brighton, BN1 6DL

Offers in the region of £160,000

This spacious first-floor studio flat on Florence Road in Brighton presents a fantastic opportunity for first-time buyers, investors, or those seeking a rental income.

Benefitting from a private off-road parking space at the front of the building, this charming flat offers both convenience and comfort. The property features a well-proportioned studio room, a separate kitchen, and a smartly designed bathroom, providing ample space for comfortable living.

The private parking space is a rare and valuable feature in this sought-after location. Florence Road is ideally situated close to the beautiful Preston Park, offering plenty of local shops, cafes, and recreational facilities. This desirable area is known for its green open spaces, tennis courts, and playgrounds, making it perfect for those who enjoy an active lifestyle.

For commuters, the nearby Brighton and Preston Park mainline train station provides easy access to Gatwick Airport and London.

This flat combines the best of city living with a tranquil, tree-lined street, making it an excellent investment or perfect home in one of Brighton's most popular neighborhoods.

- Studio Flat
- Separate Kitchen
- Separate W/C
- Fantastic Brighton Location
- Off - Street Parking Space
- First Floor
- Bathroom
- Bright and Airy
- Close to Train Stations
- Vacant

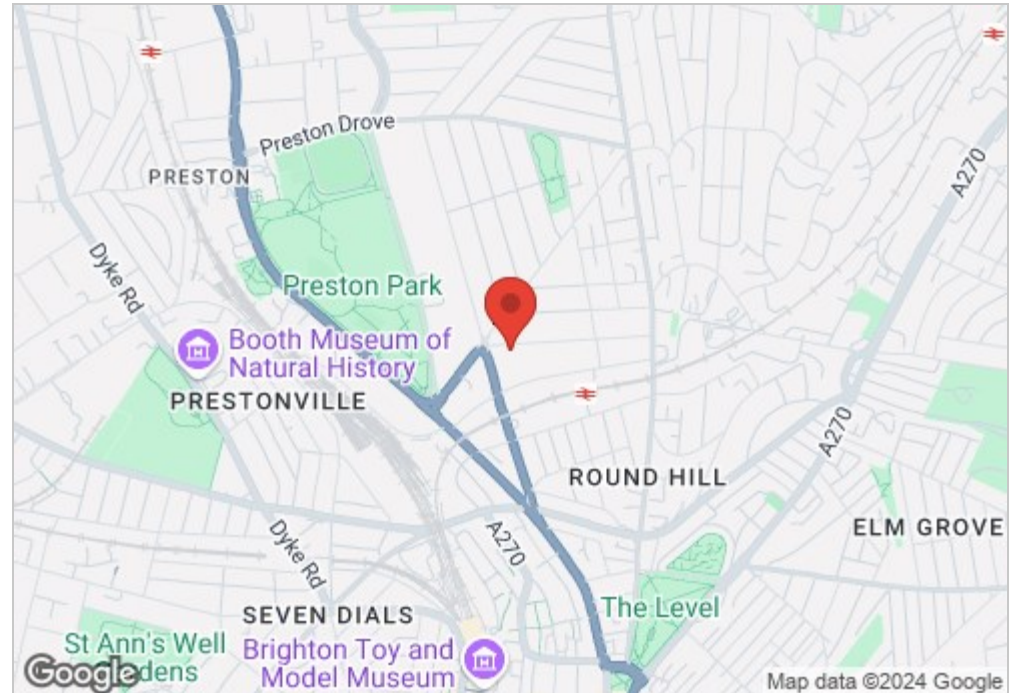
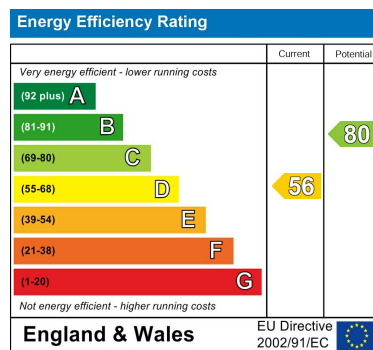

Approx Gross Internal Area
26 sq m / 281 sq ft

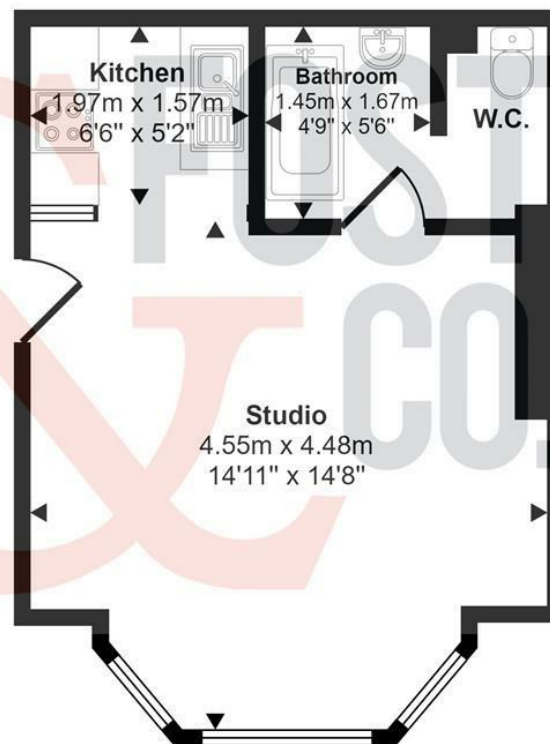

Studio

This floorplan is only for illustrative purposes and is not to scale. Measurements of rooms, doors, windows, and any items are approximate and no responsibility is taken for any error, omission or mis-statement. Icons of items such as bathroom suites are representations only and may not look like the real items. Made with Made Snappy 360.