



Grange Road | Torquay | TQ1 1LF

Asking Price Of £120,000

Here we have a well planned 2 bedroom flat located within the Warberry area of Torquay and within easy reach of the town centre and sea front. Close by are woodland walls and there are also stunning green views across Torquay towards St. Marychurch and Dartmoor National Park in the distance. The flat offers a good sized lounge/diner, kitchen, two bedrooms and bathroom, with double glazed and night storage heating. There is also a garage and parking space.

- 2 BED FLAT
- SUPERB VIEWS
- DOUBLE GLAZED + NIGHT STORAGE HEATHER
- LARGE LOUNGE/DINER
- GARAGE

Front door to flat.

Night storage heater. Airing cupboard with hot water tank.

A good sized room with two double glazed windows enjoying green views across Torquay to Dartmoor in the distance. Decorative fireplace. TV point. Night storage heater.

Fitted with a range of matching wall and base units with wash sink over. Electric cooker point. Space for fridge freezer. Plumbing for washing machine. Double glazed window with views as lounge. Breakfast bar. Cooker hood.

A double room with built-in wardrobe and shelving. Double glazed window. Night storage heater.

A smaller double room with double glazed window and night storage heater.

A white suite with bath, and electric shower unit. Wash basin and WC. Heated towel rail. Tiled walls. Double glazed window. Electric wall heater.

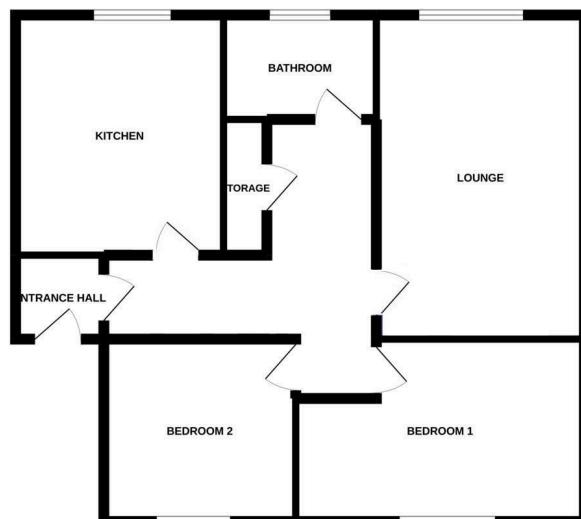

Whilst every attempt has been made to ensure the accuracy of the floorplan contained here, measurement of doors, windows, rooms and any other items are approximate and no responsibility is taken for any error, omission or mis-statement. This plan is for illustrative purposes only and should be used as such by any prospective purchaser. The services, systems and appliances shown have not been tested and no guarantee as to their operability or efficiency can be given.

Grange Road, Torquay, TQ1 1LF

Leasehold

B

D

117 Union Street
Torquay
Torbay
TQ1 3DW

01803 201904

**Please scan
the QR code
for Material
Information**



Agents Note: These details are meant as a guide only. Any mention of planning permission, loft rooms, extensions etc, does not imply they have all the necessary consents, building control etc. Photographs, measurements, floorplans are also for guidance only and are not necessarily to scale or indicative of size or items included in the sale. Commentary regarding length of lease, maintenance charges etc is based on information supplied to us and may have changed. We recommend you make your own enquiries via your legal representative over any matters that concern you prior to agreeing to purchase.