

Princeton Close

Salford

HILLS

In Excess of £250,000

Princeton Close

Salford

Fantastic modern three bedroom property! Well-presented throughout, boasting a modern kitchen diner and a generous garden, this property would be a great first time home for a family!

Council Tax band: C

Tenure: Leasehold

- Modern three bedroom family home
- Situated on a Quiet Cul-de-Sac
- Spacious Family Lounge and a Downstairs W/C
- Modern Kitchen Diner and a Three-Piece Family Bathroom
- Three Well-Proportioned Bedrooms
- Off-Road Parking to the Front
- Generous, Well-Presented Garden to the Rear
- Within Walking Distance of Salford Royal Hospital
- Close to Local Schooling, Well-Kept Parks and Excellent Transport Links into Salford Quays, Media City and Manchester City Centre
- Ideal First Time Home in a Great Family Location, Viewing is Highly Recommended!



Entrance Hallway

7' 1" x 3' 1" (2.17m x 0.94m)

Downstairs W.C.

5' 10" x 3' 1" (1.78m x 0.94m)

Lounge

15' 9" x 14' 6" (4.79m x 4.42m)

Kitchen

9' 7" x 14' 6" (2.92m x 4.41m)

Bedroom One

8' 10" x 13' 11" (2.69m x 4.24m)

Bedroom Two

8' 11" x 10' 7" (2.71m x 3.23m)

Bedroom Three

10' 5" x 6' 0" (3.18m x 1.84m)

Bathroom

5' 9" x 6' 2" (1.76m x 1.87m)



HILLS



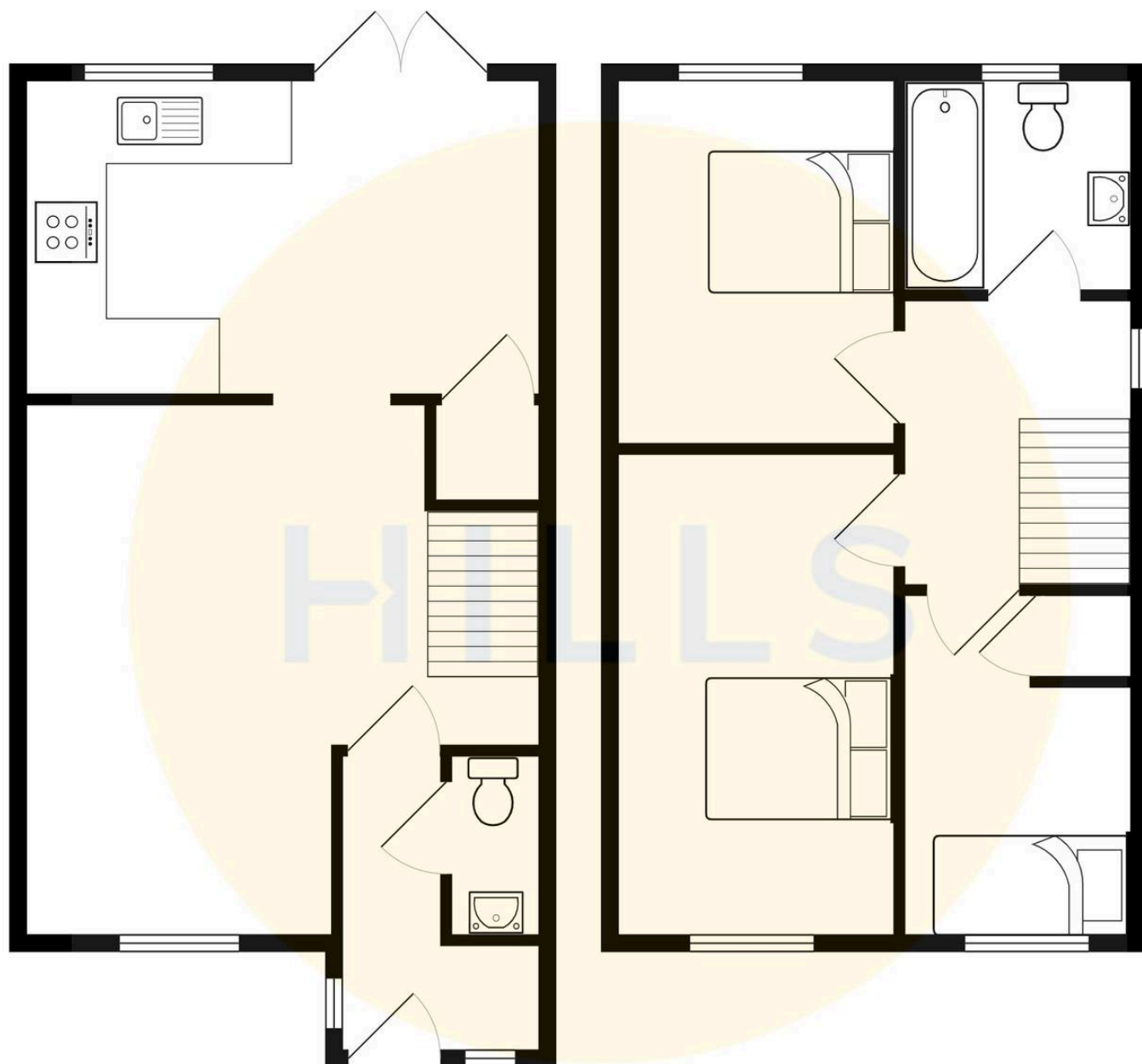

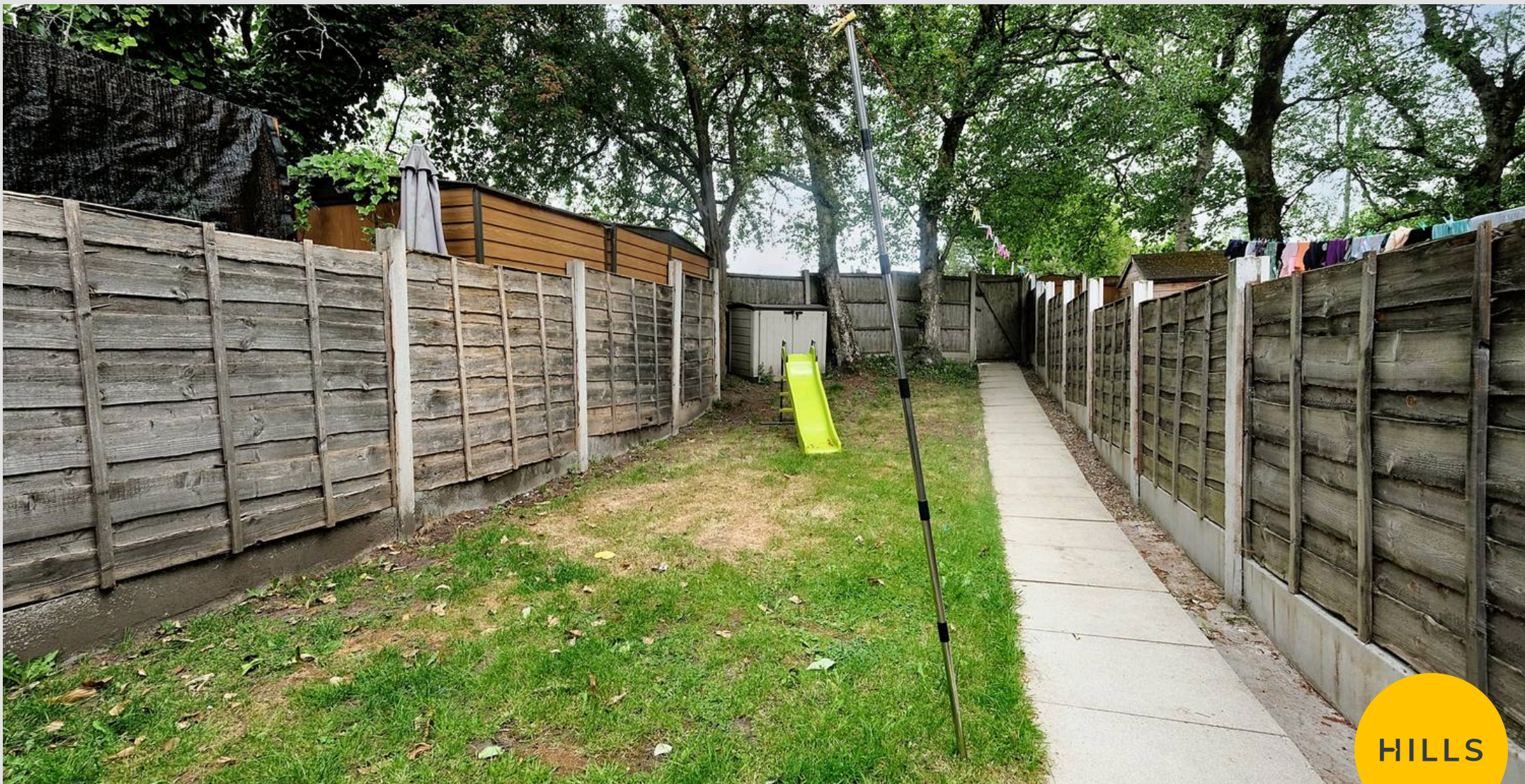

Hills | Salfords Estate Agent

Hills Residential, Sentinel House Albert Street – M30 0SS

0161 707 4900

sales@hills.agency

www.hills.agency/



THE PROPERTY MISDESCRIPTIONS ACT 1991 The Agent has not tested any apparatus, equipment, fixtures and fittings or services and so cannot verify that they are in working order or fit for the purpose. A Buyer is advised to obtain verification from their Solicitor or Surveyor. References to the Tenure of a Property are based on information supplied by the Seller. The Agent has not had sight of the title documents. A Buyer is advised to obtain verification from their Solicitor. You are advised to check the availability of this property before travelling any distance to view. Every effort and precaution has been made to ensure these particulars are correct and not misleading but their accuracy is not guaranteed nor do they form part of any contract. If there is any point which is of particular importance to you, please contact us and we will provide any information you require. This is advisable, particularly if you intend to travel some distance to view the property. The mention of any appliances and services within these details does not imply that they are in full and efficient working order. These particulars are in draft form awaiting Vendors confirmation of their accuracy. These details must therefore be taken as a guide only.