



OXFORD FAMILY ESTATES
Property Sales and Services

rightmove 



Brackenhurst, Sea Road, Chapel St. Leonards

Offers Over £425,000

🛏️ 4 🚿 3 🚗 4



Oxford Family Estates are delighted to present this unique Heritage Range Potton dormer. This 4/5 bedroom detached dormer bungalow has exposed douglas fir timber posts throughout. This feature rich property is finished to a high standard, with a downstairs en-suite bedroom, separate toilet and kitchen with island. The conservatory, which is laid out as an additional dining space currently flows out through double doors to the landscaped garden and double garage with electric roller doors.

Potton Heritage Range - The house is a Potton designed house called the Comberton from a range called Heritage that was known at the time for using large dimension Douglas fir posts and beams to support the structure internally. The external walls of the structure are timber frame construction. It was built 1995-1996, there are only 2 Potton Houses in Chapel St Leonards.

Dinning room 4.47m x 2.22m (14'7" x 7'3")

Kitchen 3.38m x 5.64m (11'1" x 18'6")

Lounge 5.73m max x 5.63m max (18'9" max x 18'8" max)

Conservatory (P - shaped)

Bedroom 5/study (Downstairs) 4.93m max x 2.24m (16'2" max x 7'4")

Bedroom 3 (downstairs) 3.48m x 3.50m max (11'5" x 11'5" max)

En-suite 3.13m x 0.70m (10'3" x 2'3")

Bedroom 2 4.43m x 3.48m (14'6" x 11'5")

En- suite 3.41m x 2.14m (11'2" x 7'0")

Bedroom 4 3.28m x 1.98m (10'9" x 6'5")

Bathroom 2.72m max x 2.15m max (8'11" x 7'0")

Bedroom 1 4.55m max x 4.53m max (14'11" max x 14'10" max)



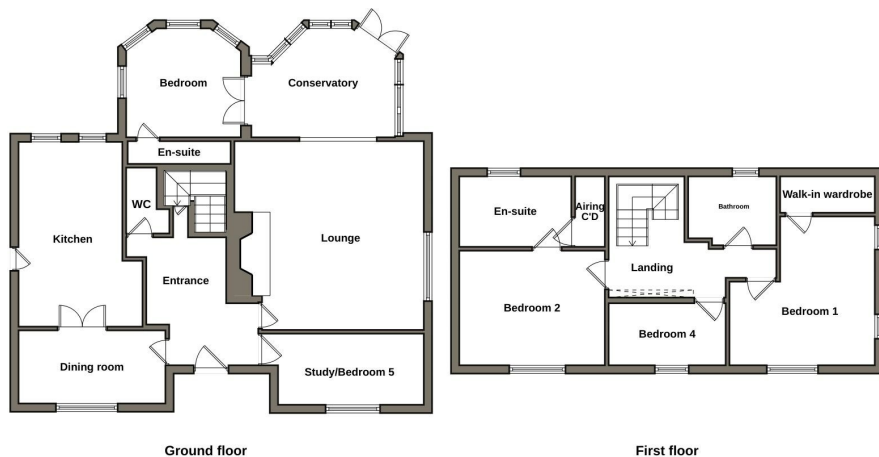

Floorplan is indicative of layout only and should not be used for accurate measurement or structural purposes.

- 4/5 bedroom, 2 en-suite
- Double garage
- downstairs bedroom & en-suite
- Log Burner & Oil Heating
- Tax Band D, EPC Rating TBC
- Detached dromer bungalow
- Large kitchen with Island
- Landscaped garden
- Home or Holiday let investment potential
- Potten Heritage Range - Douglas fir timber Frame



OXFORD FAMILY ESTATES
Property Sales and Services

