



OXFORD FAMILY ESTATES
Property Sales and Services



Mill Lane, Hogsthorpe, Skegness, PE24 5NF

£140,000

3 1 1



ATTENTION INVESTORS Oxford Family Estates are pleased to present this 3 bedroom Detached house in the popular village of Hogsthorpe. The property has a good size Kitchen Diner, Lounge and a useful Utility room. At the rear there is an enclosed courtyard garden. The property offers a lot of scope to add value through an upgrade and would make a very nice family home with off road parking to the front.

Kitchen diner 3.63m x 5.13m (21'9" x 16'9") Fitted range of base and wall units. Electric oven & hob. Double glazed Upvc window to front elevation. Single glazed wooden frame window to rear into utility, with stainless steel sink. Radiator. Stairs to first floor.

Lounge 4.07m x 5.09m (13'4" x 16'8") Laminate flooring with upvc double glazed windows to front and rear elevation. Fireplace and hearth.

Utility 2.70m x 1.96m (8'10" x 6'5") Space and plumbing for washing machine and dishwasher, with space for under counter fridge and freezer. Upvc double glazed windows to rear and side elevation and door leading to rear enclosed patio.

Bedroom 1 3.72m max by 3.94m max (12'2" x 12'11") Good sized double bedroom. Built in wardrobes. Window to front elevation. Radiator.

Bedroom 3 3.07m x 1.99m (10' x 6'6") Single bedroom with Upvc double glazed windows to rear and side elevation. Radiator.

Bedroom 2 3.67m max 3.70m max (12' x 12'1") Upvc double glazed window to front elevation and radiator.

Outside Concrete front with space for 1 vehicle. Small enclosed rear patio area with high walls, accessible through utility.



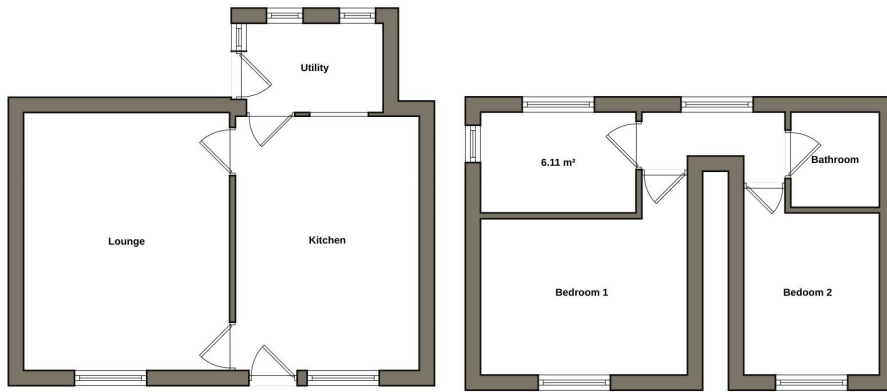

Floorplan is indicative of layout only and should not be used for accurate measurement or structural purposes.

- 3 Bedroom
- Large lounge
- Electric central heating
- Off Street parking
- Tax Band A
- Detached House
- Kitchen Diner
- Enclosed rear courtyard
- Ideal for landlords
- EPC Rating E

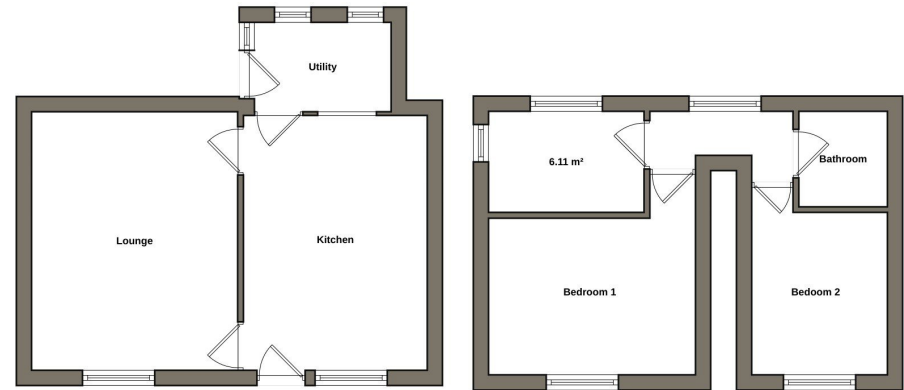

Floorplan is indicative of layout only and should not be used for accurate measurement or structural purposes.



OXFORD FAMILY ESTATES
Property Sales and Services

