

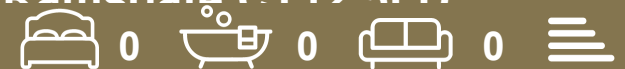

GUILDCREST ESTATES



Unit 48 The Oaks
Manston Business Park,
Ramsgate CT12 5FD





GUILDCREST ESTATES

**The Oaks
Manston Business Park,
Ramsgate, CT12 5FD
£950 Per month**

The Oaks, Manston Business Park, Ramsgate - a fantastic opportunity awaits you with this industrial unit! This property boasts 2,000 sq ft of space, perfect for your business needs. With parking available for 3 vehicles, convenience is at your doorstep.

This light industrial unit features a mezzanine floor, providing additional space for your operations. The roller shutter door adds both security and ease of access, making your daily activities run smoothly.

Situated in a popular business park, you'll be surrounded by like-minded professionals, creating a vibrant and dynamic environment for your business to thrive. Don't miss out on the chance to make this industrial unit your own - seize this opportunity today at The Oaks in Manston, Ramsgate!

Unlock endless possibilities for your business at The Oaks, Manston Business Park, located at the heart of Thanet in East Kent just 15 miles from





the M2 motorway.

With easy access to the A299 Thanet Way, this prime location provides a link with Ramsgate New Port only 5 miles east, and the site's proximity to the Channel Ports, along with Kent International Airport and high-speed rail links at Thanet Parkway Station, makes it an ideal hub for trade and commerce.

AVAILABLE AUGUST 2024

Deposit £1096
Rent £950+ Vat

STOCK IMAGES USED FOR
ILLUSTRATION PURPOSES.

Motor Trade Restrictions



GUILDCREST ESTATES

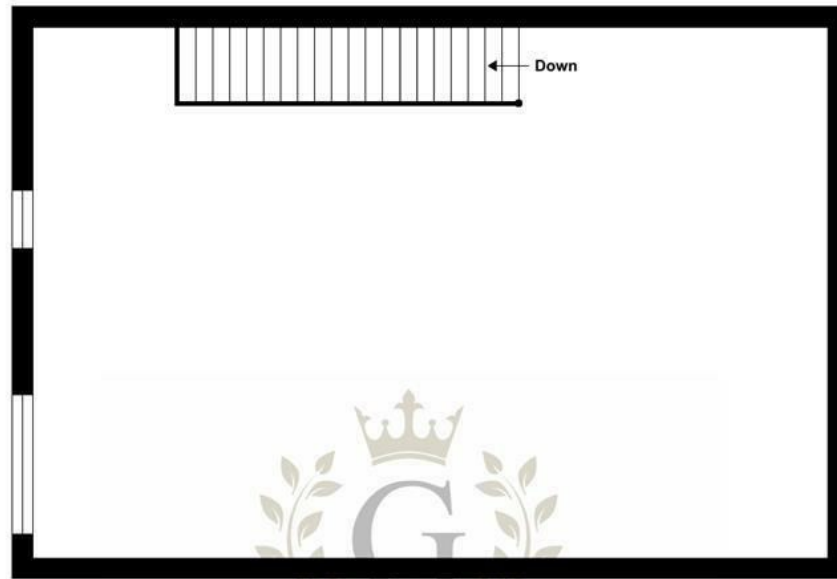

FIRST FLOOR

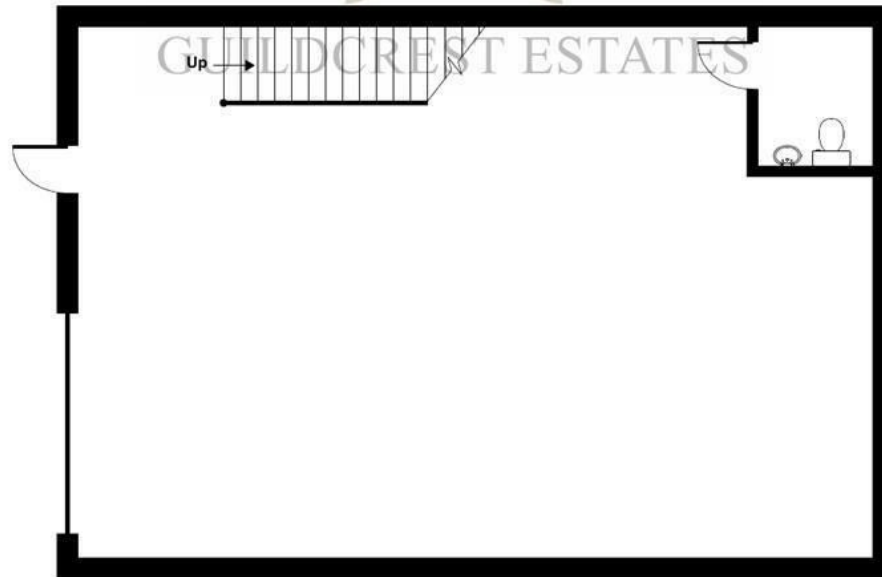

GROUND FLOOR

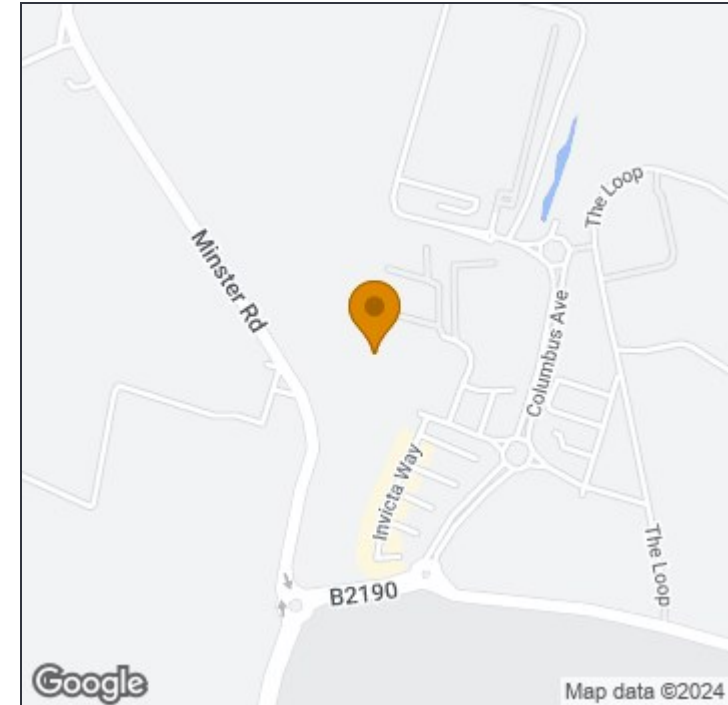

Disclaimer

These particulars, whilst believed to be accurate are set out as a general outline only for guidance and do not constitute any part of an offer or contract. Intending purchasers should not rely on them as statements of representation of fact, but must satisfy themselves by inspection or otherwise as to their accuracy. No person in this firm's employment has the authority to make or give any representation or warranty in respect of the property.



Floor plan produced in accordance with RICS Property Measurement Standards incorporating International Property Measurement Standards (IPMS2 Residential). © nitchecom 2023. Produced for Guildcrest Estates Ltd. REF: 947985

Manston Commercial
The Sales Suite, Office 4 Maple Leaf, Kent, 01843
588215
T: 01843 272 200