

ELYOT
TWO
BEDROOM
HOME

BLOOR HOMES



A two bedroom terrace home with a charming lounge and stunning open plan kitchen / dining area with a convenient utility area, cloakroom and French doors opening onto the rear garden. The first floor is home to the family bathroom and two spacious double bedrooms.

ELYOT

A CHARMING TWO BEDROOM
SEMI-DETACHED HOME

**ELYOT
TWO
BEDROOM
HOME**

FIRST FLOOR:

BEDROOM 1
3.97m x 2.67m
13'0" x 8'9"

BEDROOM 2
4.00m x 2.40m
13'1" x 7'10"

BATHROOM

GROUND FLOOR:

LOUNGE
3.97m x 3.91m
13'0" x 12'10"

KITCHEN / DINING
2.85m x 3.27m
9'4" x 10'9"

UTILITY
1.05m x 1.70m
3'5" x 5'7"

CLOAKS



FIRST FLOOR

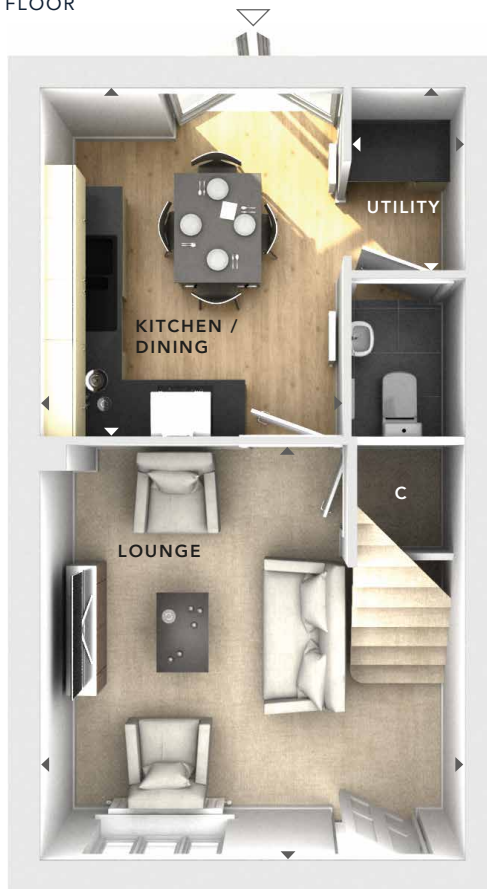

GROUND FLOOR

C	- Storage
△	- External Access
◀▶	- Measurement Points
© Bloor Homes • 804B 4.5	



These particulars are intended as a preliminary guide for prospective purchasers and should not be relied upon. The elevational treatment for individual house types shows a typical arrangement. Details of materials and design treatments may vary. Any artist impressions shown are not intended to represent any particular plot. Purchasers are advised to inspect the layout plan to establish the arrangement of the house and surrounding property. Internal layouts show a general arrangement which may vary from plot to plot. Room sizes given are approx. overall finished room sizes and subject to normal building tolerances (ie ± 75mm). In all instances purchasers are advised to inspect plot specific information available from our sales team. Nothing in these particulars or verbal assurance shall form or constitute part of any contract, and are given without any responsibility on behalf of Bloor Homes.