



Avon House, Wellingborough

£150,000



A good size town centre, two-bedroom apartment with park views, offering spacious and contemporary accommodation. Benefitting from central heating, double glazing and secure intercom entry, Avon House also provides lift access and a dedicated parking space in a secure gated entrance.

The accommodation offers an entrance hall, kitchen living dining room, bathroom and two double bedrooms.

This property is located in central Wellingborough within walking distance from the mainline train station which takes 45 minutes to London, St Pancras. The A45 dual carriageway links neighbouring towns as well as the M1 and Rushden Lakes leisure and retail park.

Tenure: Leasehold (164 years remaining TBC)  
Secure Gated Parking  
Electric Radiator Central Heating  
Double Glazing  
Council Tax: Band B  
Annual Service Charge/Maintenance Fee: £1262pa (2024-2025)







# Avon House, Wellingborough

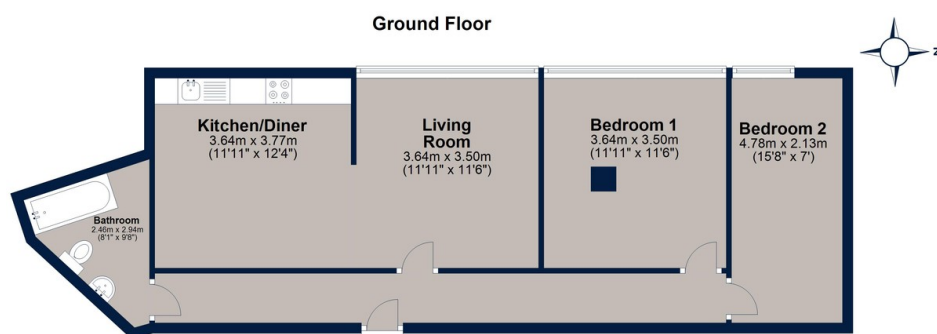

Total area: approx. 67.1 sq. metres (722.2 sq. feet)

Plan is for illustration purposes only and may not be representative of the property. Plan is not to scale. Plan produced by M-Photo  
Plan produced using PlanUp.



Osprey Oakham  
4 Burley Road  
Oakham  
Rutland LE15 6DH  
01572 756675  
oakham@osprey-property.co.uk

Osprey Stamford  
7 Red Lion Street  
Stamford  
Lincolnshire, PE9 1PA  
01780 769269  
stamford@osprey-property.co.uk

Osprey Oundle  
6 Crown Court  
Market Place  
Oundle, PE8 4BQ  
01832 272225  
oundle@osprey-property.co.uk

Osprey Melton  
8 Burton Road  
Melton  
Leicestershire, LE13 1AE  
01664 778170  
melton@osprey-property.co.uk

Located in the heart of the town is this two double bedroom, recently renovated flat.

This bright and spacious ground floor flat also benefits from a parking space within the gated, secure entrance.

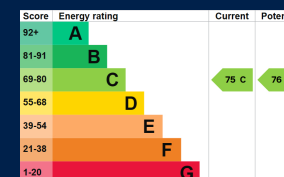

Agents Note: Whilst every care has been taken to prepare these particulars, they are for guidance purposes only. All measurements are approximate, and are for general guidance purposes only and whilst every care has been taken to ensure their accuracy, they should not be relied upon, and potential buyers/tenants are advised to recheck the measurements