

 2  1  2



Alma Road, Windsor

OSBORNE HEATH

A two double bedroom, two bathroom refurbished character house with allocated parking in Windsor town centre.

The ground floor is open-plan with a large reception space and brand new fully integrated kitchen. There is also a downstairs WC and storage under the stairs.

Upstairs there are two large double bedrooms, both with original wooden beams and en suites.

Outside there is allocated parking for one car.

Alma Road is in Windsor town centre. Windsor has a wide range of shops and restaurants as well as the Castle, Great Park, Racecourse and Legoland. Nearby train stations include Windsor & Eton Central and Windsor & Eton Riverside where trains run to London Paddington (via Slough) and London Waterloo. Nearby schools include Eton, The Kings House, Oakfield, The Queen Anne, St Edwards, Trevelyan, Trinity St Stephen, Upton House, Windsor Boys and Windsor Girls. Windsor is also convenient for the M4, M25 and Heathrow Airport.

EPC rating C. Council Tax band D. Tenancy Length 12-24 Months. Deposit £2,648. Holding Deposit £529.

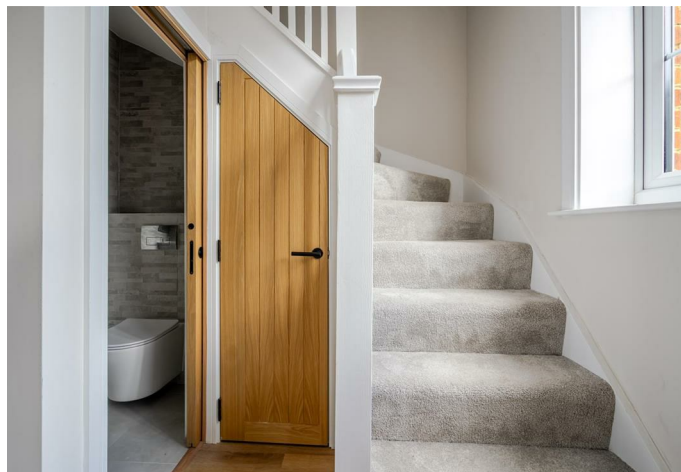



APPROXIMATE FLOOR AREA
House - 75.74 sq m - 815 sq ft
(Gross Internal Area)



NOT TO SCALE
This plan is for illustration purposes only

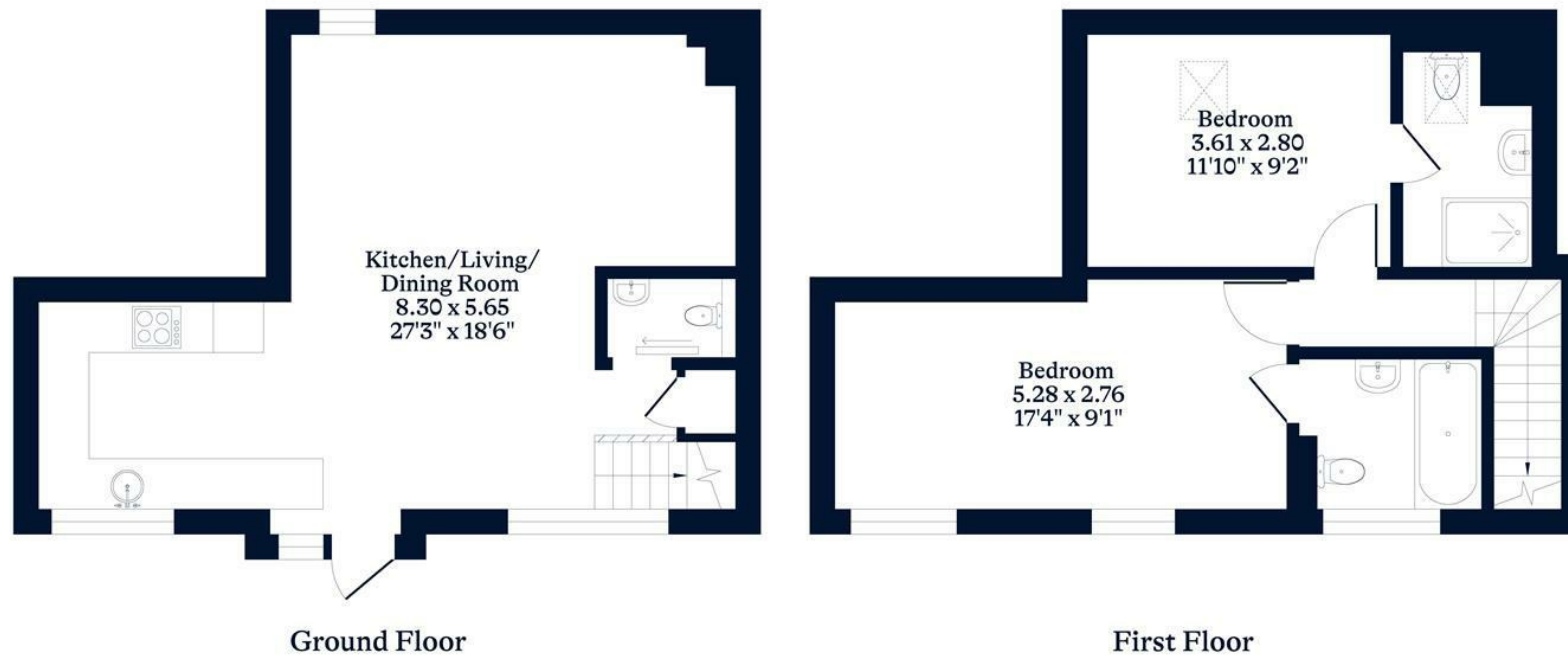

OSBORNEHEATH.CO.UK

This floor plan has been created by Property Shoot Ltd following the RICS code of measuring and is for indicative guidance only. Whilst every attempt has been made to ensure the accuracy of the floor plan contained here, measurements of doors, windows and rooms are approximate and no responsibility is taken for any error, omission or misstatement. Details shown on this floorplan, including all measurements, areas and proportions cannot be guaranteed by either the provider or estate agency and should not be relied upon.

©PROPERTYSHOOT