

 5  3  2



Brudenell, *Windsor*

OSBORNE HEATH

A refurbished five bedroom, two bathroom detached family home with a driveway and double garage in a small cul-de-sac on the St Leonards Hill estate.

Downstairs there is a modern kitchen with dining area, large living room both with bi-folding doors out to the garden, study, utility room, downstairs WC and internal access to the garage.

Upstairs there are five bedrooms, an en suite bathroom to the principal bedroom and a family shower room. There is also access to a boarded loft.

To the front of the house there is driveway parking for multiple vehicles and access to a double garage. The rear garden has been landscaped with a patio seating area, artificial lawn plus a shed which can be used for storage. The current owners have also added a solar panel system.

Brudenell is a small cul-de-sac off Illingworth, which is off St Leonards Hill. Windsor has a wide range of shops and restaurants as well as the Castle, Great Park, Racecourse and Legoland. Nearby train stations include Windsor & Eton Central and Windsor & Eton Riverside where trains run to London Paddington (via Slough) and London Waterloo. Nearby schools include Eton, St George's School, The Kings House, Oakfield, The Queen Anne, St Edwards, Trevelyan, Trinity St Stephen, Upton House, Windsor Boys and Windsor Girls. Windsor is also convenient for the M4, M25 and Heathrow Airport.

EPC rating B. Council Tax band G.





APPROXIMATE FLOOR AREA

House - 152.30 sq m - 1640 sq ft
Garage - 24.43 sq m - 263 sq ft
Total - 176.73 sq m - 1903 sq ft
(Gross Internal Area)

O
—
H

NOT TO SCALE

This plan is for illustration purposes only

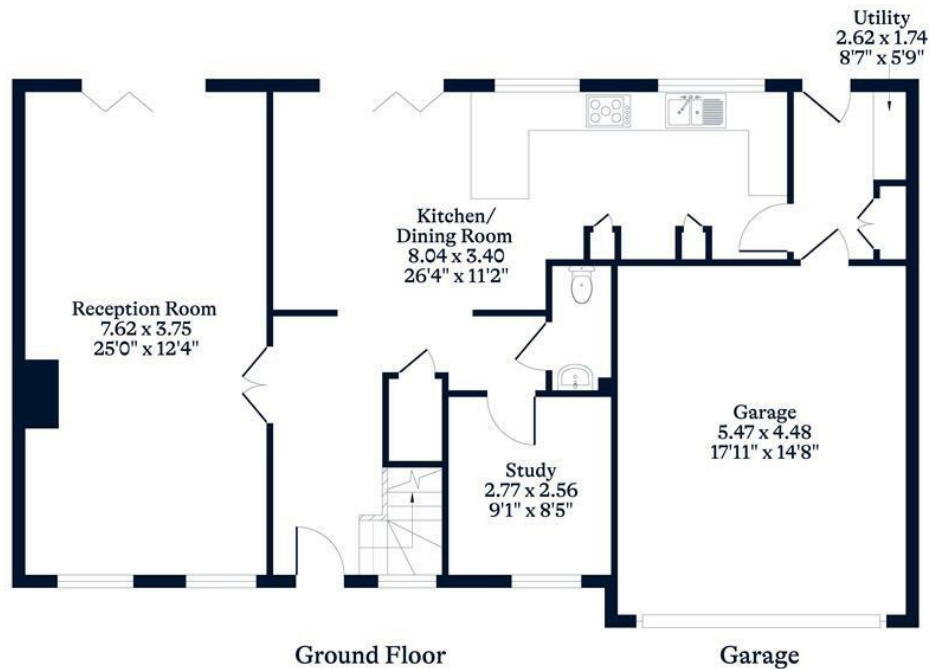

This plan is for layout guidance only. Not drawn to scale unless stated. Windows and door openings are approximate. Whilst every care is taken in the preparation of this plan, please check all dimensions, shapes and compass bearings before making any decisions reliant upon them.

OSBORNEHEATH.CO.UK