

 3  1  2



Woodside Road, *Winkfield*

OSBORNE HEATH

A three bedroom, two bathroom detached house with driveway parking and a south facing garden.

Downstairs is a modern kitchen with dining space, large living room leading out to the garden and a downstairs WC.

Upstairs there are three bedrooms, an en suite shower room to the principal bedroom and a family bathroom.

To the front of the house is driveway parking for several vehicles and side access to the rear south facing garden which has an outbuilding and overlooks a local vineyard.

Woodside Road is part of Woodside Village in the parish of Winkfield. Within the village there are great pubs and restaurants such as Loch Fyne, The Duke of Edinburgh and The Rose & Crown. Woodside is on the outskirts of Ascot towards Windsor and local residents have access through a private gate into Windsor Great Park. Other nearby places of interest include Ascot Racecourse, Legoland, Royal Ascot Golf Club, Royal Berkshire Polo Club and Windsor Castle. Woodside is also convenient for the M3, M4, M25 and Heathrow Airport.

EPC rating C. Council Tax band E. Let 6-24 months. Deposit £3,403. Holding Deposit £680.





APPROXIMATE FLOOR AREA

House - 95.04 sq m - 1027 sq ft
Outbuilding - 14.09 sq m - 160 sq ft
Total - 110.03 sq m - 1187 sq ft
(Gross Internal Area)



NOT TO SCALE

This plan is for illustration purposes only

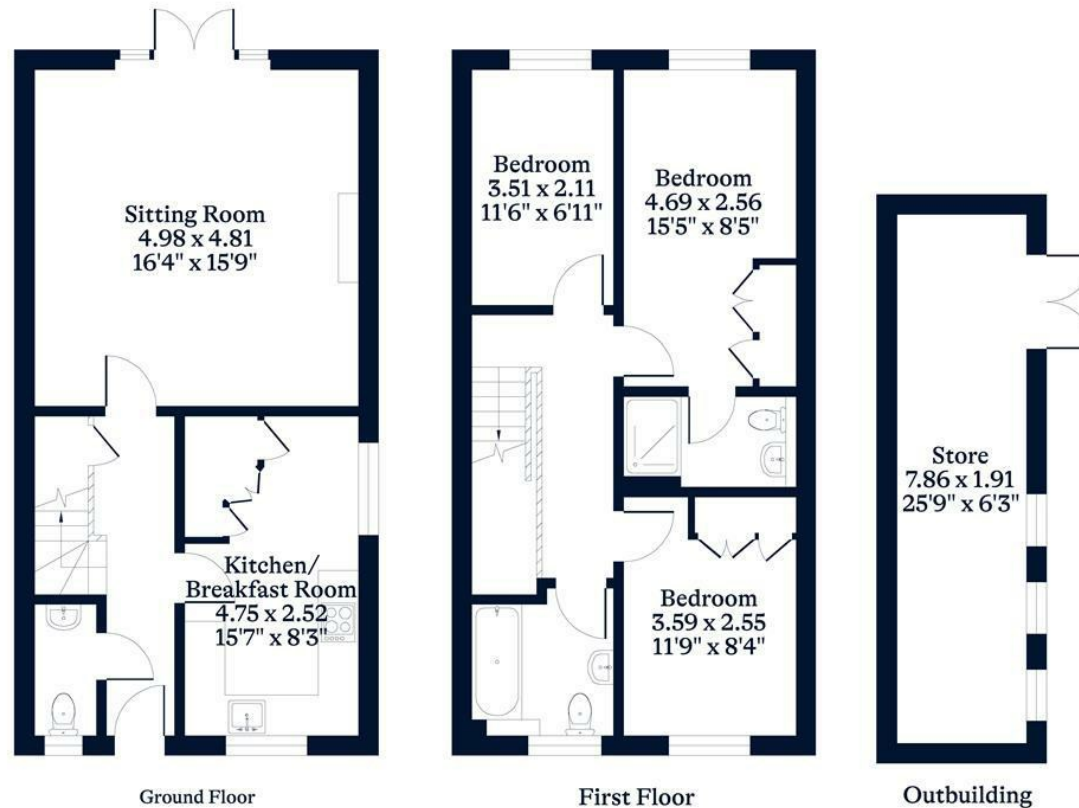

This plan is for layout guidance only. Not drawn to scale unless stated. Windows and door openings are approximate. Whilst every care is taken in the preparation of this plan, please check all dimensions, shapes and compass bearings before making any decisions reliant upon them.

OSBORNEHEATH.CO.UK