

 4  3  3



Queens Road, *Windsor*

OSBORNE HEATH

An immaculate four double bedroom, three bathroom family home with a south facing garden, on a quiet road close to Windsor town centre.









The current owners of this character property have extended and fully refurbished the house in recent years.

Downstairs there is a formal living room with feature wood-burner and venetian shutters, dining area, downstairs WC and a utility cupboard under the stairs. The kitchen has a central island, integrated appliances, a full length light-well, dining area and a seamless corner bi-folding doors out to the garden.

Upstairs is the principal bedroom with built-in wardrobes, venetian shutters and an en suite shower room, two further double bedrooms and a family bathroom. The loft has been converted into another en suite bedroom with study area.

Outside there is a sunny south facing garden with a patio, artificial lawn, shed storage, rear access to Osborne Mews and studio with power which has been used as a gym.



Queens Road is a small residential street in Windsor town centre, off St. Leonards Road. Windsor has a wide range of shops and restaurants as well as the Castle, Great Park, Racecourse and Legoland. Nearby train stations include Windsor & Eton Central and Windsor & Eton Riverside where trains run to London Paddington (via Slough) and London Waterloo. Nearby schools include Eton, The Kings House, Oakfield, The Queen Anne, St Edwards, Trevelyan, Trinity St Stephen, Upton House, Windsor Boys and Windsor Girls. Windsor is also convenient for the M4, M25 and Heathrow Airport.

EPC rating TBC. Council Tax band E.



APPROXIMATE FLOOR AREA

House - 135.27 sq m - 1456 sq ft
Outbuilding - 7.60 sq m - 82 sq ft
Total - 142.87 sq m - 1538 sq ft
(Gross Internal Area)

NOT TO SCALE

This plan is for illustration purposes only

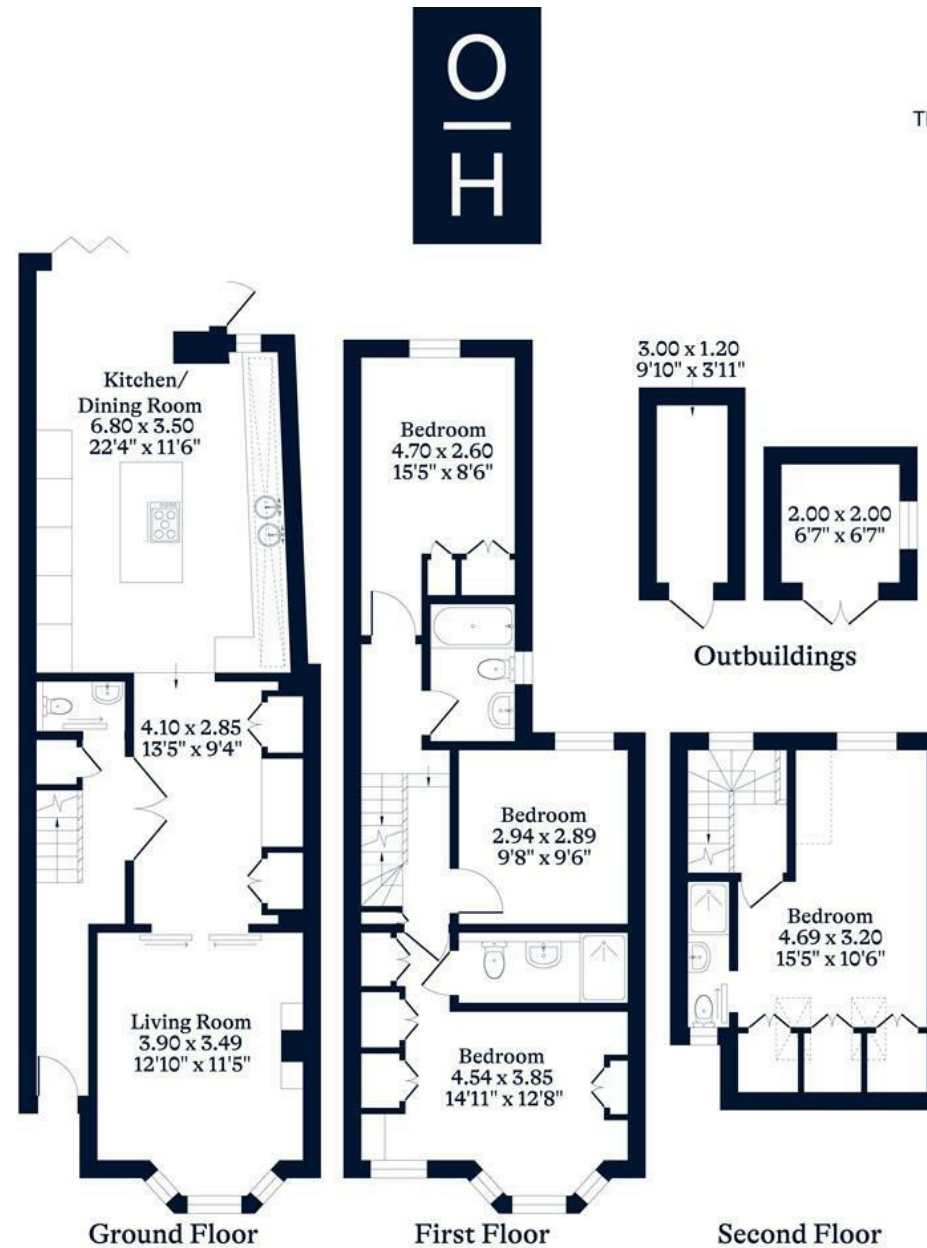

This plan is for layout guidance only. Not drawn to scale unless stated. Windows and door openings are approximate. Whilst every care is taken in the preparation of this plan, please check all dimensions, shapes and compass bearings before making any decisions reliant upon them.

