

 4  2  2



North Street, *Winkfield*

OSBORNE HEATH

A beautifully presented four double bedroom, two bathroom detached house with driveway parking and an integral garage.

The ground floor comprises a cloakroom, contemporary kitchen (refitted in 2019), utility room, good-size living room with an attractive fireplace, dining room and a modern conservatory that overlooks the attractive rear garden.

On the first floor, there are four double bedrooms; three have fitted wardrobes. The principal bedroom has an en suite shower room and the large family bathroom includes a separate shower cubicle.

To the front of the property there is driveway parking for three cars leading to the garage with an electric door.

The fenced rear garden has been beautifully landscaped and includes lawn, fruit trees and semi-mature ornamental plantings.

North Street is situated in the village of Winkfield, between Windsor and Ascot. Nearby places of interest include Legoland, Ascot Racecourse, Lapland, Coworth Park, Royal Berkshire Polo Club, Wentworth Golf Club, Windsor Castle and Windsor Great Park. Winkfield is also convenient for the M3, M4, M25 and Heathrow Airport and the area also has a selection of well-regarded state, private and international schools.

EPC rating C. Council Tax band F.





APPROXIMATE FLOOR AREA

House - 158.5 sq m - 1706 sq ft

Garage - 13.5 sq m - 145 sq ft

Total - 172.0 sq m - 1851 sq ft

Including Limited Use Area (1.4 sq m / 15 sq ft)
(Gross Internal Area)

O
—
H

NOT TO SCALE

This plan is for illustration purposes only

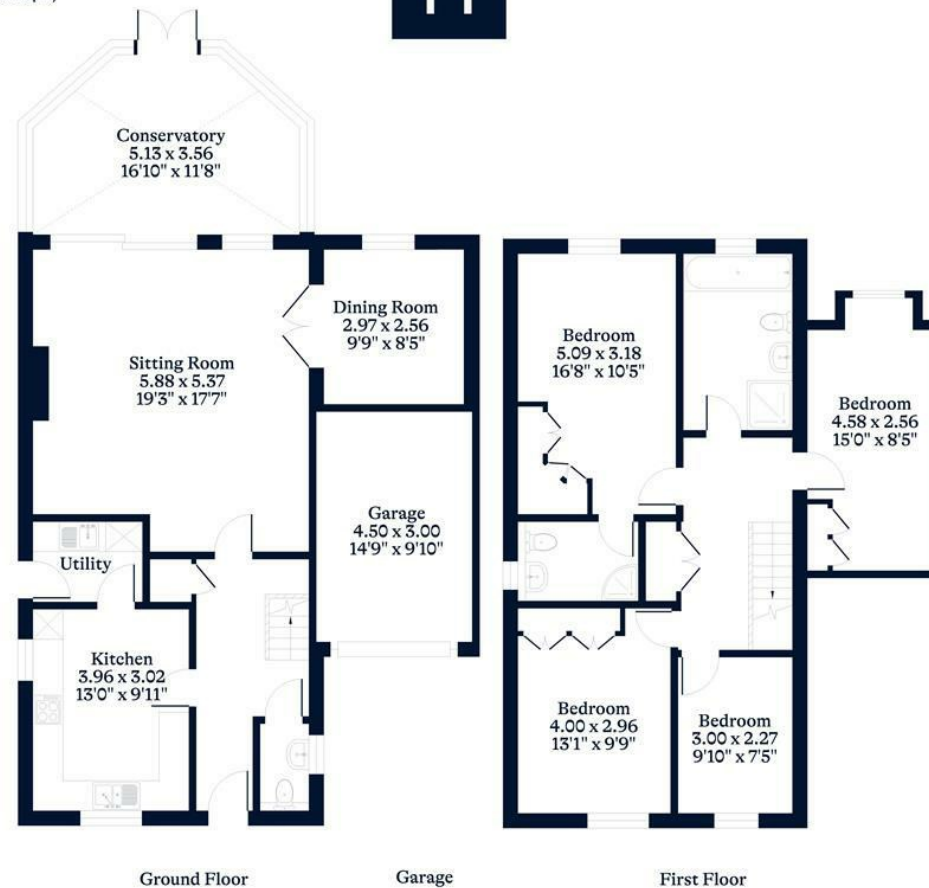

This plan is for layout guidance only. Not drawn to scale unless stated. Windows and door openings are approximate. Whilst every care is taken in the preparation of this plan, please check all dimensions, shapes and compass bearings before making any decisions reliant upon them.

OSBORNEHEATH.CO.UK