

 4  2  2

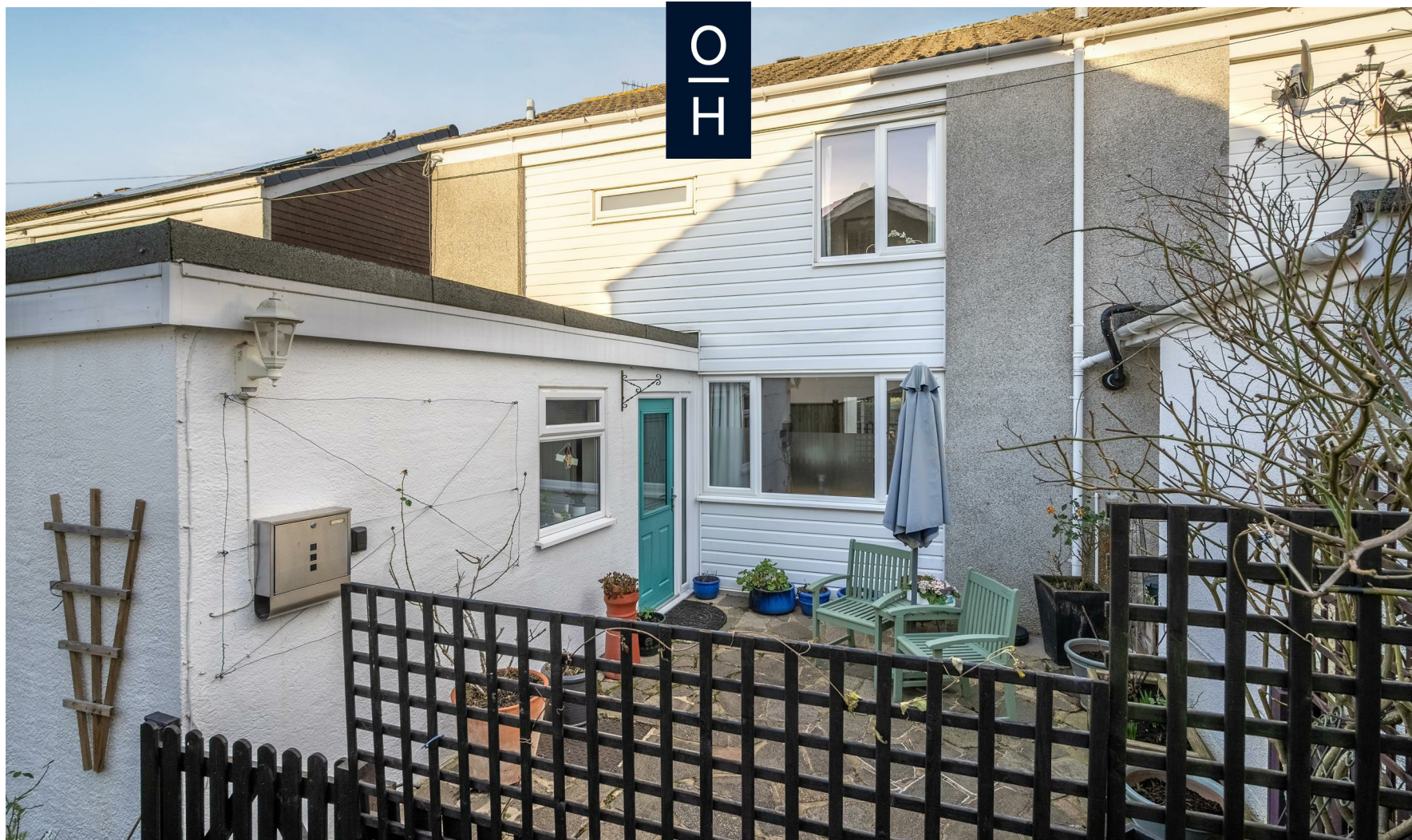

# Wood Close, *Windsor*

OSBORNE HEATH



# A four bedroom, two bathroom semi-detached family home in a cul-de-sac with a garage and flexible accommodation.

The ground floor has a double aspect living and dining room, modern kitchen, shower room, and a double bedroom with storage and dressing area.

Upstairs there are three bedrooms and a shower room.

Outside there is a front courtyard, side access, rear garden with artificial lawn, and a garage in a block.

Wood Close is a cul-de-sac close to Windsor's famous Long Walk. Windsor has a wide range of shops and restaurants as well as the Castle, Great Park, Racecourse and Legoland. Nearby train stations include Windsor & Eton Central and Windsor & Eton Riverside where trains run to London Paddington (via Slough - Elizabeth Line) and London Waterloo. Windsor is also convenient for the M4, M25 and Heathrow Airport. The area also has a good selection of state, private and international schools.

EPC rating D. Council Tax band D.







**APPROXIMATE FLOOR AREA**  
House - 107.38 sq m - 1156 sq ft  
(Gross Internal Area)



**NOT TO SCALE**  
This plan is for illustration purposes only

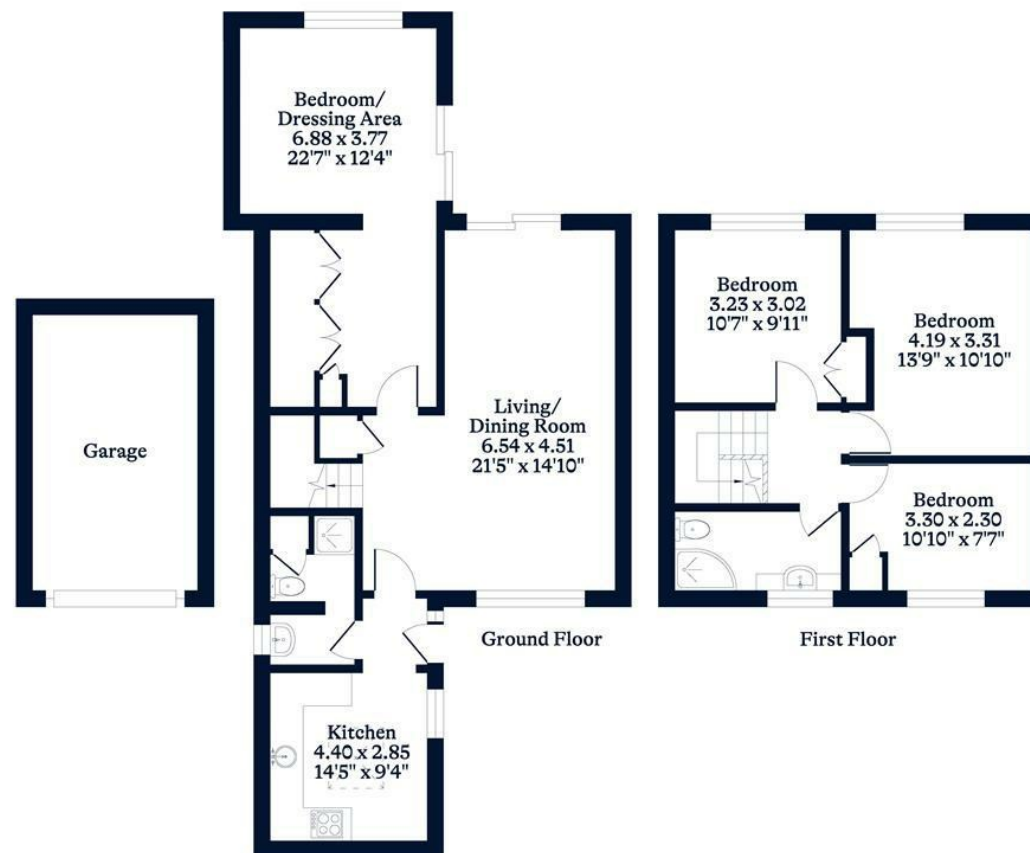

This plan is for layout guidance only. Not drawn to scale unless stated. Windows and door openings are approximate. Whilst every care is taken in the preparation of this plan, please check all dimensions, shapes and compass bearings before making any decisions reliant upon them.

[OSBORNEHEATH.CO.UK](http://OSBORNEHEATH.CO.UK)