

 2  1  2



Oxford Road, *Windsor*

OSBORNE HEATH

A one/two bedroom, two bathroom split-level period conversion in Windsor town centre.

This period property was converted into apartments in 2012 and this apartment is being sold for the first time since it was new.

On the first floor there is an open-plan kitchen with living and dining areas, a double bedroom and a bathroom.

Stairs lead to a mezzanine level which could be used as an occasional bedroom or study, and an en suite shower room.

Outside there is a patio area and small communal entrance and stairs shared by just two apartments.

Oxford Road is a residential road of period properties in Windsor town centre. Windsor has a wide range of shops and restaurants as well as the Castle, Great Park, Racecourse and Legoland. Nearby train stations include Windsor & Eton Central and Windsor & Eton Riverside where trains run to London Paddington (via Slough) and London Waterloo. Windsor is also convenient for the M4, M25 and Heathrow Airport.

EPC rating C. Council Tax band C. Share of Freehold with 975 years underlying lease. £480pa Service Charge. £0 Ground Rent.





APPROXIMATE FLOOR AREA
Apartment - 61.15 sq m - 658 sq ft
(Gross Internal Area)



NOT TO SCALE
This plan is for illustration purposes only

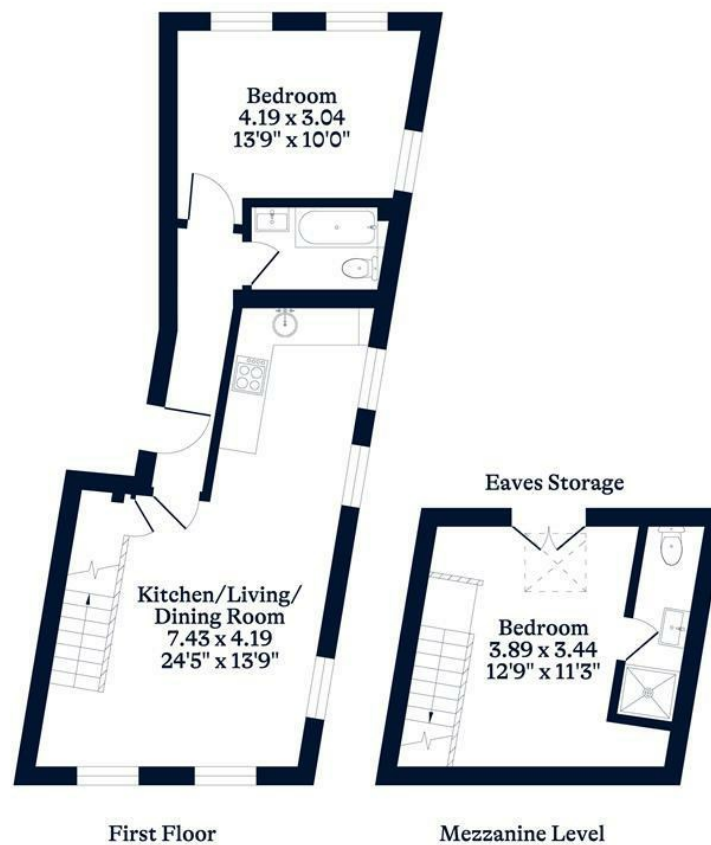

This plan is for layout guidance only. Not drawn to scale unless stated. Windows and door openings are approximate. Whilst every care is taken in the preparation of this plan, please check all dimensions, shapes and compass bearings before making any decisions reliant upon them.

OSBORNEHEATH.CO.UK