

3 2 1



# East Crescent, *Windsor*

OSBORNE HEATH



# An extended and refurbished three double bedroom family home in a quiet crescent, with a driveway and long rear garden.

Downstairs there is a formal living room, extended kitchen with dining space, utility area and bi-folding doors out to the garden, and a downstairs WC.

Upstairs there are three double bedrooms and a brand new family bathroom.

To the front of the house is driveway parking and side access to the long rear garden.

East Crescent is a quiet residential road close to local shops. Windsor town centre has a wide range of shops and restaurants as well as Windsor Castle, Windsor Great Park, Windsor Racecourse and Legoland. Train stations include Windsor & Eton Central and Windsor & Eton Riverside where trains run to London Paddington (via Slough - Elizabeth Line) and London Waterloo. The area has a selection of well-regarded schools close by including St Edwards, Clewer Green, Windsor Boys and Windsor Girls.

EPC rating D. Council Tax band D.







**APPROXIMATE FLOOR AREA**  
House - 88.94 sq m - 957 sq ft  
(Gross Internal Area)



**NOT TO SCALE**  
This plan is for illustration purposes only

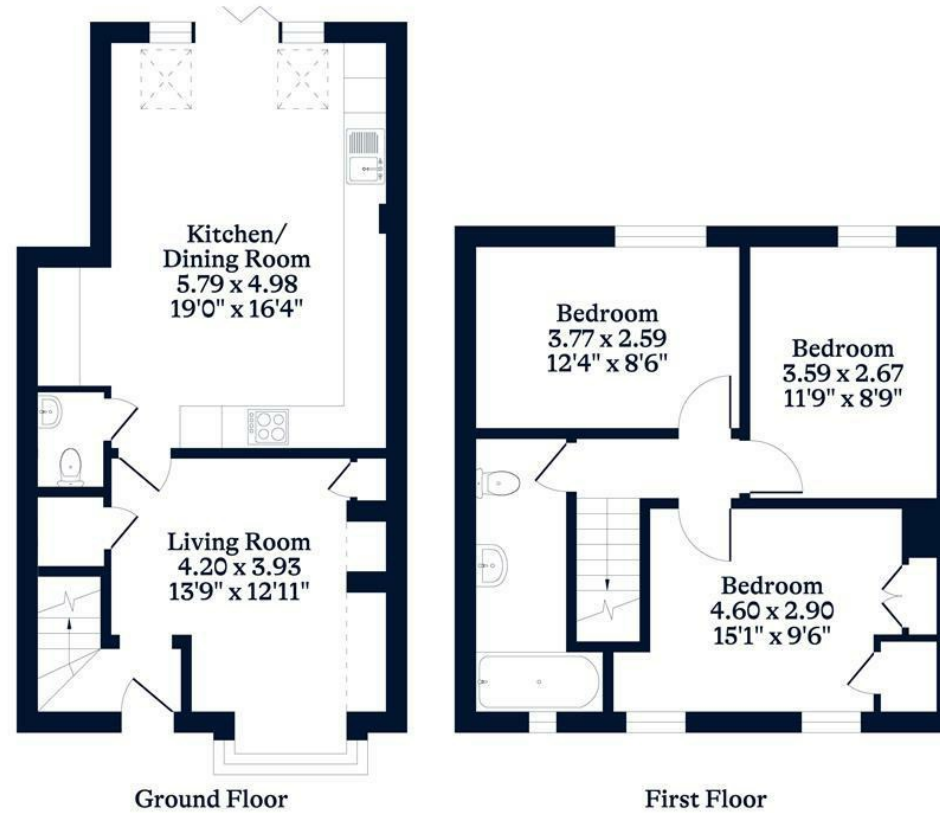

This plan is for layout guidance only. Not drawn to scale unless stated. Windows and door openings are approximate. Whilst every care is taken in the preparation of this plan, please check all dimensions, shapes and compass bearings before making any decisions reliant upon them.

[OSBORNEHEATH.CO.UK](http://OSBORNEHEATH.CO.UK)