

🛏️ 2 🪑 1 🛁 1



# Knights Place, *Windsor*

OSBORNE HEATH

## A two double bedroom apartment with two underground parking spaces and no onward chain.

This first floor apartment has a living room, separate kitchen, double bedroom with built-in wardrobes, a second double bedroom, bathroom and storage in the hall plus a loft.

The development has a secure entry system, communal gardens, lift access, and gated underground parking. This apartment has two allocated parking spaces in the underground carpark.

Knights Place is situated on St Leonards Road, close to Windsor town centre. Windsor has a wide range of shops and restaurants as well as the Castle, Great Park, Racecourse and Legoland. Nearby train stations include Windsor & Eton Central and Windsor & Eton Riverside where trains run to London Paddington (via Slough) and London Waterloo. Windsor is also convenient for the M4, M25 and Heathrow Airport.

EPC rating C. Council Tax band D. Lease 97 years remaining .  
Ground Rent and Service Charge £2,100 pa.





**APPROXIMATE FLOOR AREA**  
House - 53.18 sq m - 572 sq ft  
(Gross Internal Area)



**NOT TO SCALE**  
This plan is for illustration purposes only

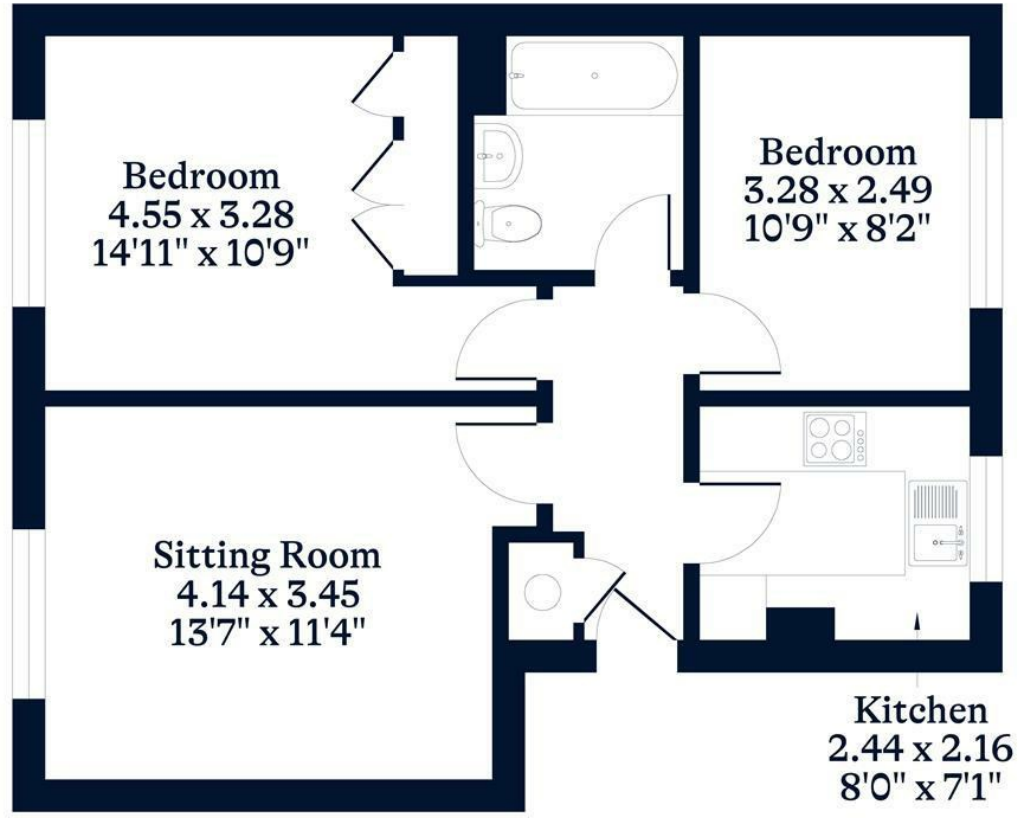

This plan is for layout guidance only. Not drawn to scale unless stated. Windows and door openings are approximate. Whilst every care is taken in the preparation of this plan, please check all dimensions, shapes and compass bearings before making any decisions reliant upon them.

[OSBORNEHEATH.CO.UK](http://OSBORNEHEATH.CO.UK)