

 3  2  1



Elmcroft, *Datchet*

OSBORNE HEATH

A three bedroom 'flat level' bungalow on a corner plot, in a cul-de-sac close to the train station, with a garage, workshop and no onward chain.

This flat level bungalow was refurbished in 2014 and has a double aspect living room, kitchen with breakfast bar and dining area, conservatory, three bedrooms (the third has been used as a study) and a modern shower room.

Outside there is driveway parking, a garage with a WC, workshop and store room, plus side access to a large corner plot garden.

Elmcroft is a small cul-de-sac of five bungalows, close to Datchet train station where services run to London and Windsor & Eton Riverside. Nearby schools include Churchmead, Eton End and St Mary's. Local places of interest include Ascot Racecourse, Legoland, The Lexicon, River Thames, Windsor Castle, Windsor Great Park and Windsor Racecourse. By road Datchet is convenient for Heathrow Airport, M4 and M25.

EPC rating D. Council Tax band F.





APPROXIMATE FLOOR AREA

House - 97.08 sq m - 1045 sq ft
Garage - 33.92 sq m - 365 sq ft
Total - 131.00 sq m - 1410 sq ft
(Gross Internal Area)



NOT TO SCALE

This plan is for illustration purposes only

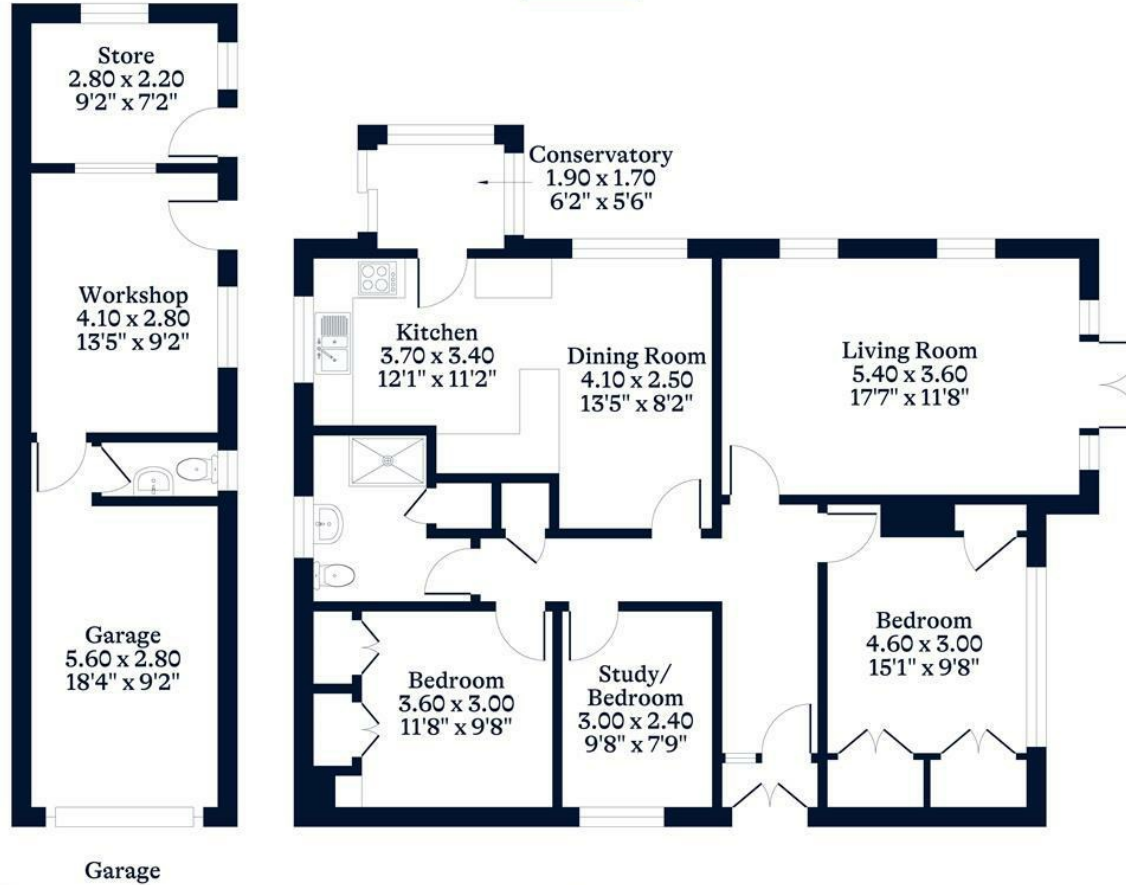

This plan is for layout guidance only. Not drawn to scale unless stated. Windows and door openings are approximate. Whilst every care is taken in the preparation of this plan, please check all dimensions, shapes and compass bearings before making any decisions reliant upon them.

OSBORNEHEATH.CO.UK