

 4  3  2



# Cotswold Close, *Maidenhead*

OSBORNE HEATH



# A four bedroom, two bathroom link-detached house in a cul-de-sac close to well-regarded schools, with a double garage and a south facing rear garden.

The property has recently been redecorated and offers immediate vacant possession.

On the ground floor is a living room that opens into a dining area, modern kitchen, study, and a downstairs WC.

The first floor has four bedrooms; all with built in wardrobes, en suite bathroom to the main bedroom and a family bathroom.

Outside, there is a lawned front garden with long driveway to a double length garage, which has a door leading to the rear garden. The rear garden is south facing and has a patio and an area of lawn.

Maidenhead benefits from excellent transportation links, including regular train services to London Paddington, with journey times of around 20-30 minutes. Maidenhead is well-connected to the road network, particularly via the nearby M4 motorway. The town has several parks and open spaces, including Maidenhead Riverside, Braywick Park, and the nearby Windsor Great Park, providing ample opportunities for outdoor activities, leisurely walks, and picnics.

The area boasts a variety of well-regarded schools, both primary and secondary, providing quality education options for families with children. Additionally, the town is within close proximity to prestigious boarding schools in nearby Windsor and Ascot. Maidenhead town center offers a range of shops, restaurants, cafes, a cinema, theatre, and leisure centre. Additionally, the nearby town of Windsor provides additional shopping and entertainment opportunities.

EPC rating D. Council Tax band G.







**APPROXIMATE FLOOR AREA**  
House - 127.85 sq m - 1376 sq ft  
Garage - 25.78 sq m - 278 sq ft  
Total - 153.63 sq m - 1654 sq ft  
(Gross Internal Area)



**NOT TO SCALE**  
This plan is for illustration purposes only

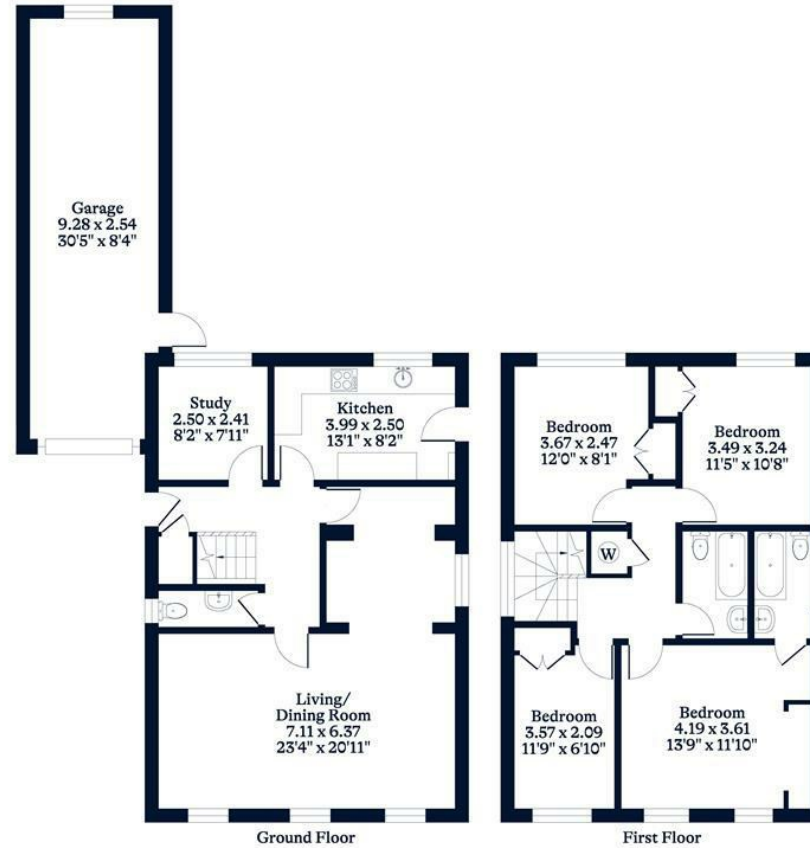

This plan is for layout guidance only. Not drawn to scale unless stated. Windows and door openings are approximate. Whilst every care is taken in the preparation of this plan, please check all dimensions, shapes and compass bearings before making any decisions reliant upon them.

[OSBORNEHEATH.CO.UK](http://OSBORNEHEATH.CO.UK)