



67 Eastlake, Tadpole Garden Village

Swindon

£375,000

mcfarlane  
property.com





## 67 Eastlake

Tadpole Garden Village, Swindon

Nestled within the sought-after Tadpole Garden Village, this SEMI DETACHED HOUSE offers a blend of modern sophistication and comfortable living. Boasting THREE BEDROOMS, including a tastefully designed EN-SUITE to the master bedroom, a stylish FAMILY BATHROOM, and a convenient additional WC, this property caters effortlessly to family life.

The heart of the home is the impressive OPEN PLAN KITCHEN DINING ROOM, featuring sleek finishes and French doors that seamlessly flow out to the rear garden. A separate SITTING ROOM at the front of the property provides a peaceful retreat for relaxation or entertaining guests.

This property is graced with a sizeable REAR GARDEN, perfect for al fresco dining or outdoor leisurely pursuits, complete with a charming patio area. A GARAGE and ample DRIVEWAY PARKING ensure convenience for multiple vehicles.

In summary, this exceptional SEMI DETACHED HOUSE presents an ideal opportunity to secure a home in a prime location, blending contemporary living spaces with practical design elements. With its THREE BEDROOMS, multiple bathrooms, and various reception rooms, this property is poised to cater to the needs of a discerning family seeking both comfort and style.







### Ground Floor

Approx. 47.5 sq. metres (511.7 sq. feet)

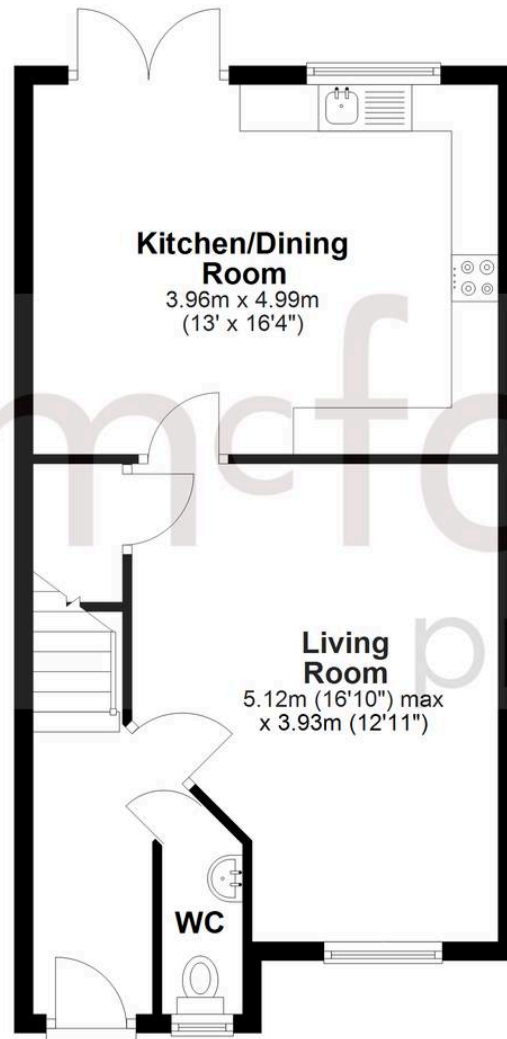

### First Floor

Approx. 45.6 sq. metres (491.2 sq. feet)

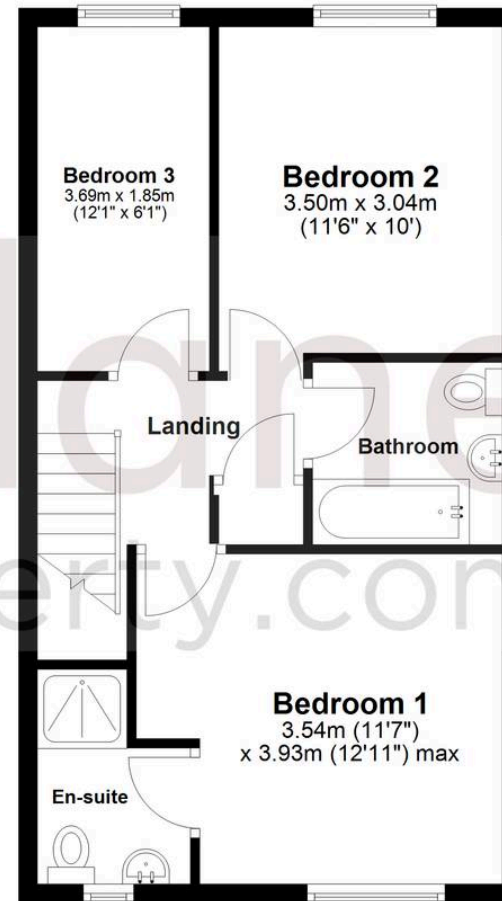

Total area: approx. 93.2 sq. metres (1002.9 sq. feet)

## McFarlane Sales & Lettings

North Swindon, Redhouse Village Centre, Swindon – SN25 2FW

01793 296600 • [swindon@mcfarlaneproperty.com](mailto:swindon@mcfarlaneproperty.com) • [www.mcfarlaneproperty.com/](http://www.mcfarlaneproperty.com/)